

# library tables

**Xpress**

**XLBGD**

**End Gable – Solid**

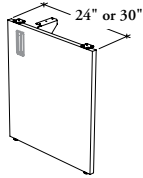

Single-Sided –  
Right (R) or Left (L) Handed

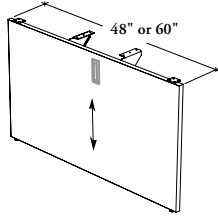

Double-Sided (D)

Supports to be installed at both end of the Single- or Double-Sided Library Table. This product can also be specified on ADA Extension for Library Table.

**WHAT'S INCLUDED**

Single- or Double-Sided Configuration: 1 end gable with levelers, 1 cable pass-through grommet (as specified), mounting brackets and mounting hardware.

**WHAT'S EXCLUDED**

Single- or Double-Sided Library Tables and Cable Pass-Through Cover.

**NOTES**

The solid panel is 1" thick.

Must be specified the same depth the Library Table.

End Gable is handed and must be specified Left (L) or Right (R).

Base height is 29" or 33" from finished floor to the top of the finished worksurface with a leveling range of 3 1/2".

Not all finishes are available in Xpress, see Xpress catalogue and/or specification software for details.

**PRODUCT OPTIONS**

Configuration	Height	Depth	Cable Pass-Through Grommet Option	Gable Finish
<b>D</b> Double-Sided (Shown)	29, 33 (ADA)	24, 30, 48, 60	<b>W</b> With Cable Pass-Through Grommet (Shown)	Source Laminate
<b>L</b> Single-Sided – Left Handed (Shown)			<b>N</b> None	Flintwood
<b>R</b> Single-Sided – Right Handed				

**SAMPLE ORDER CODE**

<b>XLBGD L</b>	<b>33</b>	<b>30</b>	<b>W</b>	<b>XG</b>
----------------	-----------	-----------	----------	-----------

**DIMENSIONS  
INCHES / MM**

H	D
29 / 737	24 / 610
29 / 737	30 / 762
29 / 737	48 / 1219
29 / 737	60 / 1524
33 / 838	24 / 610
33 / 838	30 / 762
33 / 838	48 / 1219
33 / 838	60 / 1524

**PRICING**

SINGLE-SIDED CONFIGURATION (L or R)		DOUBLE-SIDED CONFIGURATION (D)	
GABLE FINISH			
	Source Laminate	Flintwood	
	256	819	Source Laminate
	295	923	Flintwood
	n/a	n/a	433
	n/a	n/a	508
	286	890	n/a
	328	1084	n/a
	n/a	n/a	484
	n/a	n/a	571