

freestanding storage & accessories

The Hi-Fiver Storage units are freestanding and provides enclosed and open storage space in the workstation.

GS

Hi-Fiver

WHAT'S INCLUDED

1 case, 2 doors (if specified), 2 file drawers, 2 shelves, lock and keys (as specified) and levelers. Shipped assembled.

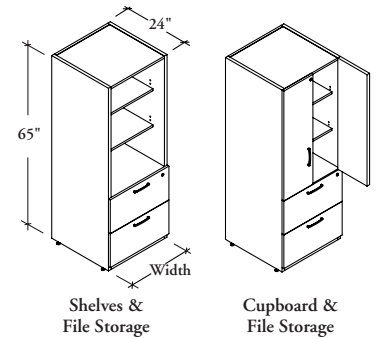

PRODUCT OPTIONS

Configuration	Depth	Width	Front Finish	Edge Trim Finish	Case and Shelf Finish	Handle Finish	Key Style
W Shelves and File Storage	24	24, 30, 36	Source Laminate	Edge Trim Colors	Source Laminate	Foundation	K Keyed Alike R Keyed Randomly
U Cupboard and File Storage			Foundation Laminate				

SAMPLE ORDER CODE

GS U	24	30	LW	JY	LY	E	R
-------------	-----------	-----------	-----------	-----------	-----------	----------	----------

**DIMENSIONS
INCHES / MM**

D	W
24 / 610	24 / 610
24 / 610	30 / 762
24 / 610	36 / 914

PRICING

Source Laminate Foundation Laminate

SHELVES & FILE STORAGE (W)

1999	2321
2159	2480
2321	2639

CUPBOARD & FILE STORAGE (U)

2398	2722
2559	2877
2722	3039