

G X C U

Infinity Curved Desk Edge Screen

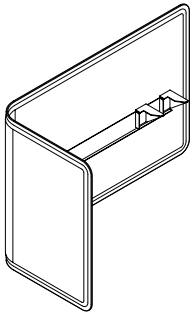

The Infinity Fabric Curved Desk Edge Screen attaches to the worksurface on both on the back and lateral edge to provide a lightweight, thin, upholstered fabric screen that is expressed in a softer curvilinear aesthetic that creates space division and local desktop privacy in varying levels.

WHAT'S INCLUDED

1 infinity fabric desk edge screen, attachment brackets, wire manger (if specified).

NOTES

The screen depth is 20" with a 1/2" wire gap around the screen.

Screen is designed to accompany an upStage Rectangle with Radius Corners Worksurface or Table with Radius Corners. Fabric will be applied in the railroad direction in select Panel and Upholstery fabrics, please refer to the *Teknion Textiles Program Guide*.

PRODUCT OPTIONS

Modesty Base Height	Height	Depth	Width	Orientation	Screen Finish	Hardware Finish
S Partial Modesty Height	42 for 42" high datum	20	23, 29, 35, 41, 47, 53, 59	NL Left	Panel Fabrics Upholstery Fabrics	Foundation Mica Accent
M Modesty Height (15")	51 for 51" high datum			NR Right		

SAMPLE ORDER CODE

GXCU S	42	20	53	L	B204	74
---------------	-----------	-----------	-----------	----------	-------------	-----------

DIMENSIONS INCHES / MM

H	D
42 / 1067	23 / 584
42 / 1067	29 / 737
42 / 1067	35 / 889
42 / 1067	41 / 1041
42 / 1067	47 / 1194
42 / 1067	53 / 1346
42 / 1067	59 / 1499
51 / 1295	23 / 584
51 / 1295	29 / 737
51 / 1295	35 / 889
51 / 1295	41 / 1041
51 / 1295	47 / 1194
51 / 1295	53 / 1346
51 / 1295	59 / 1499

PRICING

PARTIAL MODESTY HEIGHT (S)																
LEFT/RIGHT (NL/NR)																
PANEL FABRIC							UPHOLSTERY FABRIC									
COM/	Gr. 1	Gr. 2	Gr. 3	Gr. 4	Gr. 5	COM/	Gr. 1	Gr. 2	Gr. 3	Gr. 4	Gr. 5	Gr. 6	Gr. 7	Gr. 8	Gr. 9	Gr. 10
780	789	803	852	886	920	783	823	840	864	901	923	945	991	1036	1055	
827	838	853	908	946	984	830	875	895	922	963	987	1012	1062	1113	1135	
872	885	902	963	1005	1048	877	926	947	978	1024	1051	1078	1134	1190	1214	
970	983	1002	1069	1115	1162	974	1029	1052	1086	1136	1166	1195	1257	1318	1344	
1011	1025	1046	1118	1169	1220	1016	1075	1100	1136	1191	1224	1255	1323	1389	1419	
1064	1080	1102	1181	1235	1289	1070	1133	1160	1201	1260	1294	1329	1402	1474	1505	
1099	1116	1139	1224	1283	1341	1105	1173	1203	1245	1309	1346	1384	1462	1539	1573	
1072	1089	1112	1196	1255	1313	1077	1146	1175	1217	1282	1319	1357	1435	1512	1546	
1121	1140	1167	1261	1327	1393	1128	1204	1238	1285	1357	1398	1440	1528	1614	1652	
1193	1214	1244	1348	1421	1493	1200	1285	1322	1375	1453	1499	1547	1643	1739	1781	
1472	1495	1527	1642	1721	1801	1479	1572	1613	1670	1757	1808	1859	1964	2070	2115	
1535	1560	1595	1720	1806	1893	1542	1645	1688	1751	1845	1901	1956	2071	2187	2236	
1603	1630	1667	1802	1896	1990	1611	1721	1768	1837	1938	1998	2058	2183	2307	2360	
1663	1692	1732	1878	1978	2078	1672	1790	1841	1914	2023	2088	2152	2286	2420	2477	

Pricing is continued on the following page.

If Accent/Mica Hardware Finish is specified for depth 23" - 41", add 11
 If Accent/Mica Hardware Finish is specified for depth 47" - 59", add 21

**Infinity Curved Desk Edge Screen
(Continued)**

**DIMENSIONS
INCHES / MM**

H	D
42 / 1067	23 / 584
42 / 1067	29 / 737
42 / 1067	35 / 889
42 / 1067	41 / 1041
42 / 1067	47 / 1194
42 / 1067	53 / 1346
42 / 1067	59 / 1499
51 / 1295	23 / 584
51 / 1295	29 / 737
51 / 1295	35 / 889
51 / 1295	41 / 1041
51 / 1295	47 / 1194
51 / 1295	53 / 1346
51 / 1295	59 / 1499

PRICING

PARTIAL MODESTY HEIGHT (S) (CONTINUED)															
LEFT/RIGHT WITH WIRE MANAGER (WL/WR)															
PANEL FABRIC							UPHOLSTERY FABRIC								
COM/ Gr. A	Gr. 1	Gr. 2	Gr. 3	Gr. 4	Gr. 5	COM/ Gr. 1	Gr. 2	Gr. 3	Gr. 4	Gr. 5	Gr. 6	Gr. 7	Gr. 8	Gr. 9	Gr. 10
786	795	809	859	893	926	789	829	846	870	907	929	952	997	1042	1061
833	844	860	915	953	991	837	881	901	928	970	994	1018	1069	1119	1142
879	891	908	970	1012	1054	883	933	954	984	1031	1057	1085	1140	1196	1221
976	990	1009	1075	1121	1168	980	1035	1058	1092	1143	1172	1202	1263	1324	1350
1017	1032	1052	1125	1175	1226	1022	1081	1107	1143	1197	1230	1262	1329	1396	1425
1071	1087	1109	1187	1242	1296	1076	1139	1167	1207	1266	1301	1336	1408	1480	1512
1106	1123	1146	1230	1289	1347	1111	1179	1209	1251	1316	1353	1390	1469	1546	1579
1078	1095	1118	1203	1262	1320	1083	1152	1182	1224	1288	1325	1363	1441	1518	1552
1128	1147	1173	1267	1334	1399	1134	1210	1244	1291	1363	1404	1446	1534	1620	1658
1200	1221	1250	1355	1427	1499	1206	1291	1328	1381	1459	1505	1553	1649	1745	1787
1478	1501	1533	1648	1727	1807	1485	1578	1619	1676	1763	1815	1865	1971	2076	2122
1541	1567	1601	1726	1812	1899	1549	1651	1694	1758	1852	1907	1962	2077	2193	2242
1609	1636	1673	1808	1902	1996	1617	1727	1775	1843	1944	2004	2065	2189	2314	2366
1669	1699	1739	1884	1984	2085	1679	1797	1847	1920	2030	2094	2159	2293	2426	2483

MODESTY HEIGHT (M)															
LEFT/RIGHT (NL/NR)															
PANEL FABRIC							UPHOLSTERY FABRIC								
COM/ Gr. A	Gr. 1	Gr. 2	Gr. 3	Gr. 4	Gr. 5	COM/ Gr. 1	Gr. 2	Gr. 3	Gr. 4	Gr. 5	Gr. 6	Gr. 7	Gr. 8	Gr. 9	Gr. 10
966	983	1006	1091	1149	1207	972	1040	1070	1112	1174	1212	1249	1326	1404	1437
1049	1068	1094	1188	1253	1318	1055	1131	1164	1211	1282	1324	1365	1452	1538	1576
1119	1140	1169	1273	1345	1418	1126	1210	1247	1300	1378	1424	1471	1566	1662	1703
1250	1273	1305	1419	1498	1577	1258	1350	1390	1447	1534	1585	1635	1740	1845	1891
1312	1338	1373	1496	1582	1668	1321	1421	1465	1528	1620	1676	1731	1845	1960	2009
1379	1406	1443	1577	1671	1764	1387	1497	1543	1611	1712	1772	1831	1955	2079	2132
1438	1468	1508	1651	1751	1852	1447	1565	1615	1688	1797	1861	1924	2057	2190	2247
1134	1154	1182	1280	1347	1416	1140	1221	1254	1304	1378	1422	1465	1556	1647	1685
1198	1221	1251	1361	1437	1514	1206	1294	1334	1388	1472	1520	1569	1670	1771	1816
1271	1297	1330	1452	1536	1620	1280	1379	1421	1482	1574	1628	1683	1795	1906	1955
1560	1588	1625	1758	1850	1943	1569	1677	1725	1791	1893	1952	2011	2134	2257	2309
1633	1663	1703	1848	1949	2050	1643	1761	1811	1884	1994	2058	2123	2257	2391	2449
1723	1756	1799	1956	2065	2173	1733	1861	1916	1995	2113	2184	2253	2398	2543	2605
1789	1824	1871	2039	2156	2274	1801	1938	1997	2082	2209	2284	2359	2515	2670	2737

If Accent/Mica Hardware Finish is specified for depth 23" - 41", add 11
If Accent/Mica Hardware Finish is specified for depth 47" - 59", add 21

Pricing is continued on the following page.

G X C U

**Infinity Curved Desk Edge Screen
(Continued)**

**DIMENSIONS
INCHES / MM**

H	D
42 / 1067	23 / 584
42 / 1067	29 / 737
42 / 1067	35 / 889
42 / 1067	41 / 1041
42 / 1067	47 / 1194
42 / 1067	53 / 1346
42 / 1067	59 / 1499
51 / 1295	23 / 584
51 / 1295	29 / 737
51 / 1295	35 / 889
51 / 1295	41 / 1041
51 / 1295	47 / 1194
51 / 1295	53 / 1346
51 / 1295	59 / 1499

PRICING

MODESTY HEIGHT (M) (CONTINUED)															
LEFT/RIGHT WITH WIRE MANAGER (WL/WR)															
PANEL FABRIC						UPHOLSTERY FABRIC									
COM/ Gr. A	Gr. 1	Gr. 2	Gr. 3	Gr. 4	Gr. 5	COM/ Gr. 1	Gr. 2	Gr. 3	Gr. 4	Gr. 5	Gr. 6	Gr. 7	Gr. 8	Gr. 9	Gr. 10
973	990	1013	1097	1155	1213	978	1047	1076	1118	1181	1219	1255	1332	1411	1443
1055	1074	1100	1194	1260	1324	1061	1137	1170	1217	1288	1330	1372	1458	1545	1582
1126	1147	1175	1280	1351	1424	1132	1216	1253	1306	1384	1431	1477	1572	1668	1709
1257	1280	1311	1425	1504	1584	1264	1357	1397	1454	1540	1591	1642	1746	1852	1897
1319	1344	1379	1502	1589	1674	1327	1427	1472	1534	1627	1683	1738	1852	1967	2015
1385	1413	1450	1584	1677	1770	1394	1503	1550	1617	1719	1779	1838	1961	2086	2138
1444	1474	1514	1657	1758	1858	1454	1571	1622	1694	1803	1867	1931	2064	2197	2253
1140	1160	1188	1286	1354	1422	1147	1227	1261	1310	1384	1428	1472	1562	1653	1691
1205	1227	1258	1367	1443	1520	1212	1301	1340	1395	1478	1527	1575	1676	1778	1822
1278	1303	1337	1458	1542	1627	1286	1385	1427	1489	1580	1634	1689	1801	1913	1961
1567	1594	1631	1764	1857	1950	1575	1684	1731	1798	1899	1958	2017	2141	2263	2316
1642	1671	1711	1857	1957	2058	1651	1769	1820	1893	2002	2067	2131	2265	2399	2457
1729	1762	1805	1962	2071	2180	1740	1867	1922	2001	2119	2190	2260	2404	2549	2611
1796	1830	1877	2046	2163	2280	1807	1944	2003	2088	2216	2290	2365	2521	2677	2743

If Accent/Mica Hardware Finish is specified for depth 23" - 41", add 11
 If Accent/Mica Hardware Finish is specified for depth 47" - 59", add 21