

AFML Audience Laminate Hospitality Cart

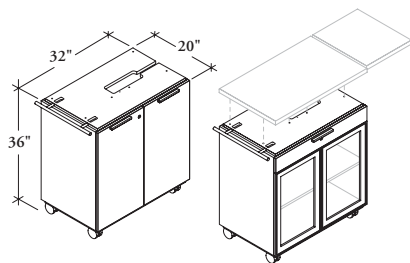

The *Audience Laminate Hospitality Cart* is designed for use in boardroom applications.

WHAT'S INCLUDED

1 cart, casters, locks and keys (if specified), waste receptacle (if specified), 1 push/pull handle.

WHAT'S EXCLUDED

Hospitality Cart Top (AFMT) must be ordered separately.

NOTES

If the Doors option (A) is specified, glass doors do not support pull or lock options.

Waste Receptacle can not be specified when the glass door option is chosen.

Solid doors and drawers will always be finished to match the case finish.

PRODUCT OPTIONS

| Configuration | Door Style | Width | Height | Case & Front Finish | Pull Style | Pull Finish | Key Style | Waste Receptacle Option |
|--------------------------|----------------|-------|--------|---------------------|-----------------------|-------------------|---|-------------------------|
| A Doors | S Solid | 32 | 36 | Source Laminate | C Contemporary | 7 Platinum | N None | 1 With |
| B Doors & Drawers | G Glass | | | | B Rectangular | E Ebony | K Keyed Alike R Keyed Randomly | 2 Without |

SAMPLE ORDER CODE

| | | | | | | | | |
|--------|---|----|----|----|---|---|---|---|
| AFML B | S | 32 | 36 | XS | C | 7 | N | 1 |
|--------|---|----|----|----|---|---|---|---|

DIMENSIONS INCHES / MM

| W | H |
|----------|----------|
| 32 / 813 | 36 / 914 |

PRICING

| DOORS (A) | |
|-------------|-------------|
| Solid Doors | Glass Doors |
| 807 | 1547 |

| DOORS & DRAWER (B) | |
|--------------------|-------------|
| Solid Doors | Glass Doors |
| 1184 | 1892 |

If Contemporary pull style is specified,

add 28/handle

If Lock is specified,

add 135

If Waste Receptacle is specified,

add 204