

pico

features

Inspired by Mt. Pico, Portugal's highest mountain peak, Studio TK's Pico Lounge is perfectly designed for public spaces, offices, lounges, or collaborative areas. Pico brings a sculptural element to today's workspaces from back to front. To achieve this goal, famed designers Flemming Busk and Stephan Hertzog used folded paper to create the natural shape of Pico. The organic appearance of both the low back and high back versions evoke a sense of comfort, encourage free movement, and open various seating postures. Complementing the free-flowing design, three very distinct bases are available: a 4-star swivel base, metal sled base and wood leg base. As a result, Pico is everything you want from a lounge chair; it is inviting, warm, and welcoming.

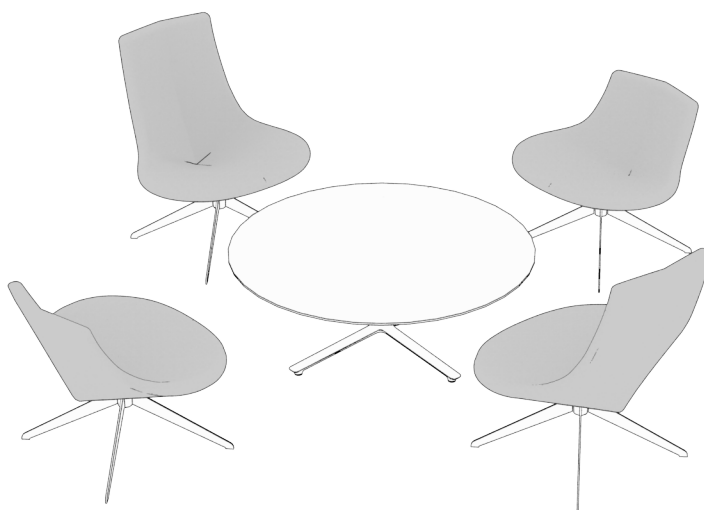

dimensions

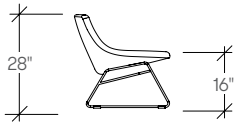
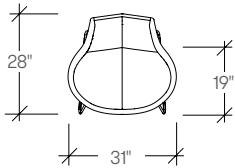

Pico Lounge,
Sled Base, Low Back
(TKCAL)

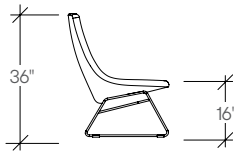
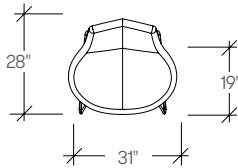

Pico Lounge,
Sled Base, High Back
(TKCAH)

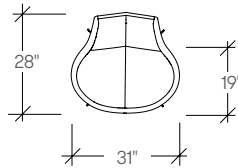

Pico Lounge,
Four Star Swivel,
Low Back
(TKCBL)

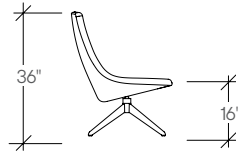
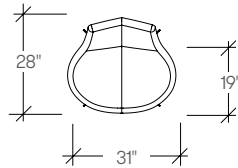

Pico Lounge,
Four Star Swivel,
High Back
(TKCBH)

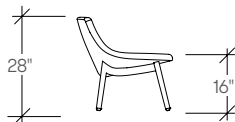
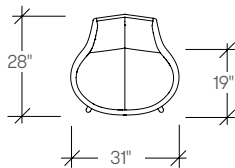

Pico Lounge,
Wood Four Leg, Low Back
(TKCCL)

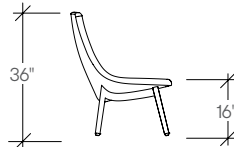
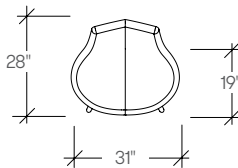

Pico Lounge,
Wood Four Leg, High Back
(TKCCH)

pico

planning

A variety of configurations can be achieved with Pico, allowing for various configurations. The following typical demonstrate the versatility that can be achieved.

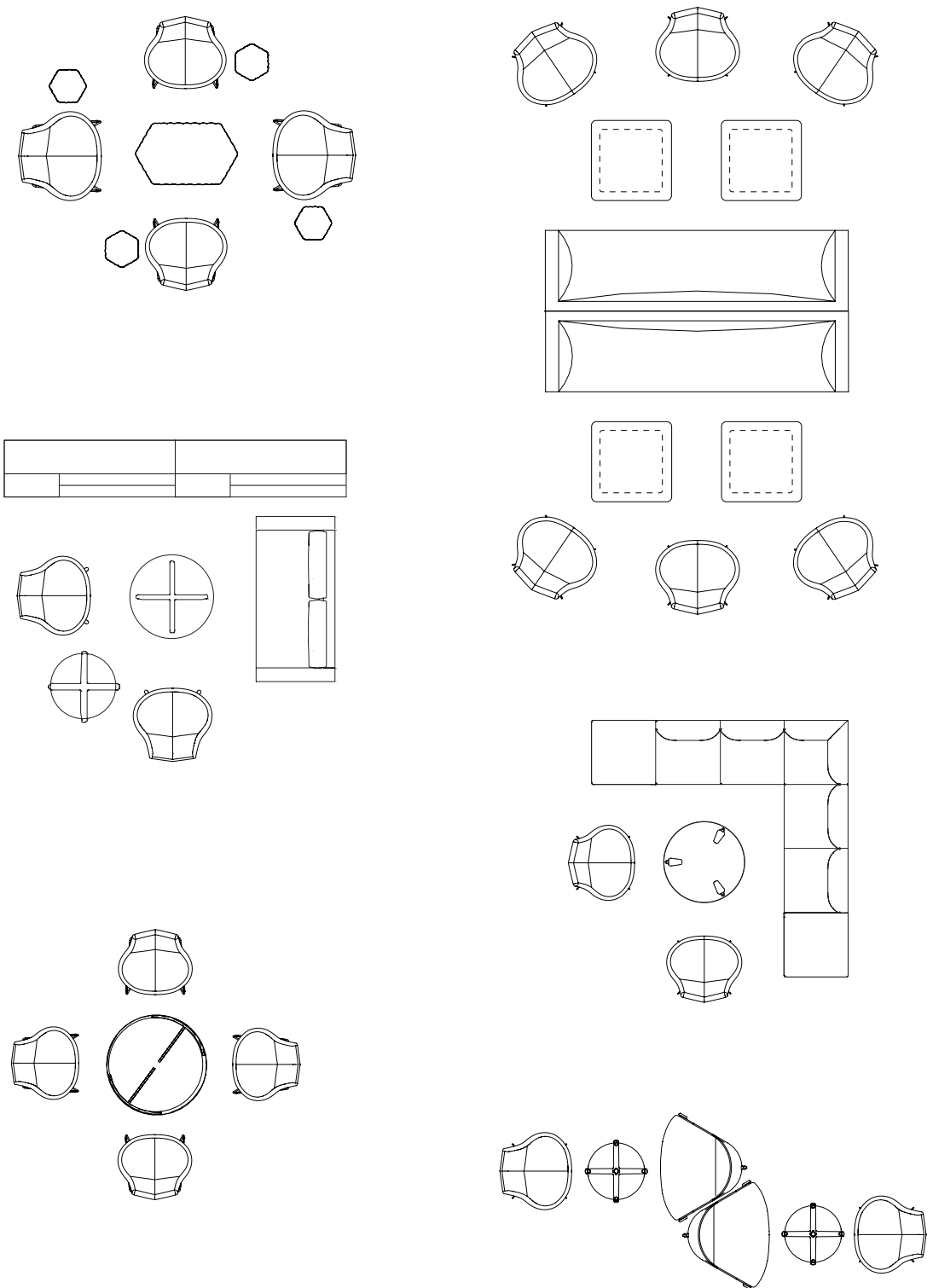

specifying pico finishes

The modularity of Pico permits a wide range of fabric combinations that allows for an expressive use of color, texture and material.

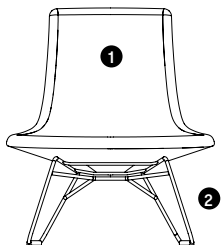

- 1 **Seat Upholstery**
Select seat upholstery
- 2 **Base Finish**
Select base finish

specification example

	TKCAL	Pico, Low Back, Sled Base
1	Seat Fabric Gr. 2	2543
2	Sled Base, Fundamental Paint	0
	Felt Glides	38
	Total:	\$2581

	TKCAL	Pico, Low Back, Sled Base
1	Seat Fabric Gr. 8	2750
2	Sled Base, Fundamental Paint	0
	Felt Glides	38
	Total:	\$2788

	TKCBH	Pico, High Back, Four-Star Swivel
1	Seat Fabric Gr. 2	2919
2	Four-Star Swivel, Fashion Paint	32
	Total:	\$2951

	TKCBH	Pico, High Back, Four-Star Swivel
1	Seat Fabric Gr. 8	3206
2	Four-Star Swivel, Fashion Paint	32
	Total:	\$3237

COM/COL material requirement

Yardage is based on a non-patterned fabric. Additional yardage may be required for pattern repeats and the matching required. Leather yield may be affected by the quality of the COL. However, variance in the size of the hides will not affect the yield.



SINGLE UPHOLSTERED	COM [yards]	COL [sq. ft.]
Low Back	2	36
High Back	2-3/4	49-1/2

TKCA pico lounge, sled base

Product Options

Back Height	Seat Upholstery	Glides	Base Finish
L Low Back	Fabric	G Glides, No Felt	Fundamental Paint
H High Back	Leather	F Felt Glides	Fashion Paint

Note For Fundamental Paint, add \$0
 For Fashion Paint, add \$32
 For Glides, No Felt add \$0
 For Felt Glides add \$38



		Seat											Leather				
		COM	COL	Gr.1	Gr.2	Gr.3	Gr.4	Gr.5	Gr.6	Gr.7	Gr.8	Gr.9	Gr.10	Gr.11	LB	LC	LD
	Low Back	2468	2616	2569	2614	2653	2698	2732	2760	2788	2822	2856	2890	2929			
	High Back	2540	2692	2679	2740	2795	2857	2903	2942	2980	3027	3073	3120	3173			
	Low Back	2974	3030	3086	3142	3198	3255	3310	3367	3423		3223	3526	3628			
	High Back	3235	3313	3390	3467	3545	3621	3698	3776	3853		3527	3944	4083			

TKCB pico lounge, four-star swivel

Product Options

Back Height	Seat Upholstery	Base Finish
L Low Back	Fabric	Fundamental Paint
H High Back	Leather	Fashion Paint

Note For Fundamental Paint, add \$0
 For Fashion Paint, add \$32

		Seat											Leather				
		COM	COL	Gr.1	Gr.2	Gr.3	Gr.4	Gr.5	Gr.6	Gr.7	Gr.8	Gr.9	Gr.10	Gr.11	LB	LC	LD
	Low Back	2728	2893	2830	2874	2914	2958	2992	3020	3049	3083	3116	3150	3189			
	High Back	2800	2968	2940	3001	3055	3117	3163	3202	3241	3287	3333	3380	3434			
	Low Back	3234	3291	3346	3403	3459	3515	3571	3628	3683		3500	3803	3904			
	High Back	3496	3573	3650	3728	3805	3881	3959	4036	4114		3803	4219	4359			

