

## R H W M D G

### Wall Cabinet with Microwave Section and Glass Doors

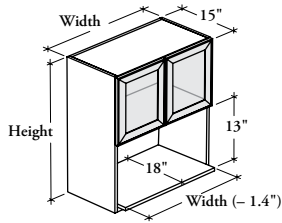

This cabinet offers space for storage as well as easy access for a microwave.

#### WHAT'S INCLUDED

1 case, 2 doors, mounting hardware and adjustable shelves as listed below:

	Heights	
	30"	36"
Adjustable Shelf	0	1

Adjustable Shelf

#### WHAT'S EXCLUDED

Wall Supports (RHAWS and RHABC).

#### NOTES

Wire cut-out must be drilled by the installer.

Internal width is determined by subtracting 1.4" from specified width.

#### PRODUCT OPTIONS

Depth	Width	Height	Case and Shelf Finish	Glass Finish	Frame Finish
15	24, 27, 30, 33, 36	30, 36	Source Laminate	<b>CL</b> Clear <b>FT</b> Frosted	Foundation Mica

#### SAMPLE ORDER CODE

<b>RHWMDG 15</b>	<b>24</b>	<b>30</b>	<b>LE</b>	<b>CL</b>	<b>E</b>
------------------	-----------	-----------	-----------	-----------	----------

#### DIMENSIONS INCHES / MM

D	W	H
15 / 381	24 / 610	30 / 762
15 / 381	24 / 610	36 / 914
15 / 381	27 / 686	30 / 762
15 / 381	27 / 686	36 / 914
15 / 381	30 / 762	30 / 762
15 / 381	30 / 762	36 / 914
15 / 381	33 / 838	30 / 762
15 / 381	33 / 838	36 / 914
15 / 381	36 / 914	30 / 762
15 / 381	36 / 914	36 / 914

#### PRICING

	Clear	Frosted
	1847	2110
	1926	2178
	1895	2153
	1976	2230
	1908	2168
	2008	2262
	1937	2200
	2057	2313
	1995	2257
	2179	2431