

# wall cabinets

## R H W C D G

### Corner Wall Cabinet with Glass Door

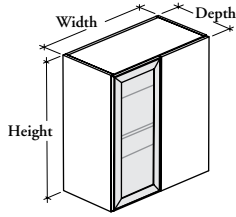

#### WHAT'S INCLUDED

1 case, 1 fixed panel, 1 door, mounting hardware and adjustable shelves as listed below:

	Heights		
	24"	30"	36"
Adjustable Shelf	1	1	2

#### WHAT'S EXCLUDED

Wall Supports (RHAWS and RHABC).

#### NOTES

This product has no pull or touch-latch. The recessed light deflector allows door opening.

Fixed Panel Edge Trim Finish does not apply to Flintwood fixed panel.

#### PRODUCT OPTIONS

Depth	Width	Height	Fixed Panel Position	Fixed Panel Finish	Fixed Panel Edge Trim	Case and Shelf Finish	Glass Finish	Frame Finish
12, 15	24, 27, 30, 33, 36	24, 30, 36	L Left Side R Right Side (Shown)	Source Laminate Foundation Laminate Flintwood	Edge Trim Colors	Source Laminate	CL Clear FT Frosted	Foundation Mica

#### SAMPLE ORDER CODE

RHWCDG 15	36	36	R	RV	SS	RV	FT	E
--------------	----	----	---	----	----	----	----	---

#### DIMENSIONS INCHES / MM

D	W	H
12 / 305	24 / 610	24 / 610
12 / 305	24 / 610	30 / 762
12 / 305	24 / 610	36 / 914
12 / 305	27 / 686	24 / 610
12 / 305	27 / 686	30 / 762
12 / 305	27 / 686	36 / 914
12 / 305	30 / 762	24 / 610
12 / 305	30 / 762	30 / 762
12 / 305	30 / 762	36 / 914
12 / 305	33 / 838	24 / 610
12 / 305	33 / 838	30 / 762
12 / 305	33 / 838	36 / 914
12 / 305	36 / 914	24 / 610
12 / 305	36 / 914	30 / 762
12 / 305	36 / 914	36 / 914

#### PRICING

CLEAR (CL)			FROSTED (FT)		
Source Laminate	Foundation Laminate	Flintwood	Source Laminate	Foundation Laminate	Flintwood
1129	1175	1503	1235	1281	1609
1180	1223	1576	1291	1334	1687
1299	1349	1749	1408	1458	1858
1172	1219	1572	1281	1328	1681
1220	1262	1636	1334	1376	1750
1342	1393	1809	1464	1515	1931
1207	1256	1625	1318	1367	1736
1242	1291	1671	1360	1409	1789
1385	1436	1872	1522	1573	2009
1219	1267	1640	1333	1381	1754
1280	1329	1729	1403	1452	1852
1428	1484	1932	1578	1634	2082
1241	1293	1677	1357	1409	1793
1306	1357	1768	1434	1485	1896
1471	1529	1995	1632	1690	2156

Pricing is continued on the following page.

**R H W C D G**  
**Corner Wall Cabinet with**  
**Glass Door (Continued)**

**DIMENSIONS**  
**INCHES / MM**

D	W	H
15 / 381	24 / 610	24 / 610
15 / 381	24 / 610	30 / 762
15 / 381	24 / 610	36 / 914
15 / 381	27 / 686	24 / 610
15 / 381	27 / 686	30 / 762
15 / 381	27 / 686	36 / 914
15 / 381	30 / 762	24 / 610
15 / 381	30 / 762	30 / 762
15 / 381	30 / 762	36 / 914
15 / 381	33 / 838	24 / 610
15 / 381	33 / 838	30 / 762
15 / 381	33 / 838	36 / 914
15 / 381	36 / 914	24 / 610
15 / 381	36 / 914	30 / 762
15 / 381	36 / 914	36 / 914

**PRICING**

CLEAR (CL)		
Source Laminate	Foundation Laminate	Flintwood
1165	1210	1562
1223	1270	1648
1343	1393	1817
1192	1240	1604
1253	1297	1685
1394	1450	1895
1240	1293	1679
1285	1336	1738
1440	1498	1959
1263	1317	1715
1324	1374	1796
1480	1544	2017
1283	1336	1742
1349	1401	1833
1533	1596	2095

FROSTED (FT)		
Source Laminate	Foundation Laminate	Flintwood
1271	1316	1668
1332	1379	1757
1451	1501	1925
1300	1348	1712
1367	1411	1799
1516	1572	2017
1351	1404	1790
1403	1454	1856
1577	1635	2096
1378	1432	1830
1447	1497	1919
1630	1694	2167
1398	1451	1857
1475	1527	1959
1694	1757	2256