

base cabinets

R H B D

Base Cabinet with Drawer(s) and Door(s)

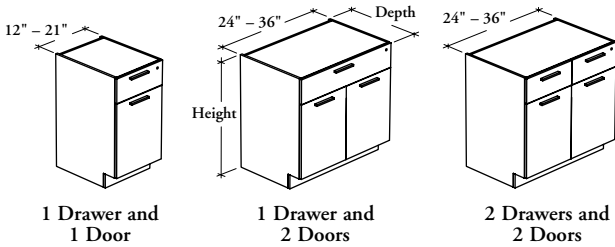

WHAT'S INCLUDED

1 case, 1 adjustable shelf, pulls (as specified), lock and keys (as specified), levelers, hardware, and items listed below:

	Widths	
	12" to 21"	24" to 36"
Door	1	2
Drawer	1	1 or 2 (as specified)

WHAT'S EXCLUDED

Countertop.

NOTES

Door Swing Direction option is available for 12" to 21" wide cabinets only.

Door and Drawer Front Edge Trim Finish does not apply to Flintwood doors and drawer fronts.

Pull Finish does not apply to Stainless Pull (8).

24" or 29" deep Base Cabinets come with one 24" deep adjustable shelf only.

PRODUCT OPTIONS

Drawer Option	Depth	Width	Height	Door Swing Direction (If applicable)	Door and Drawer Front Finish	Door and Drawer Front Edge Trim Finish	Case and Shelf Finish	Hinge Style	Pull Style	Pull Finish (If applicable)	Key Style (If applicable)
O One Drawer	24, 29	12, 15, 18, 21, 24, 27, 30, 33, 36	33, 35	L Left Side	Source Laminate	Edge Trim Colors	Source Laminate	S Standard	1 Standard Expansion	Foundation Accent Mica	R Keyed Randomly K Keyed Alike
T Two Drawers				R Right Side	Foundation Laminate Flintwood						

SAMPLE ORDER CODE

RHBD	24	12	35	L	XS	ST	XS	S	9	E	K
-------------	-----------	-----------	-----------	----------	-----------	-----------	-----------	----------	----------	----------	----------

DIMENSIONS – INCHES FOR MM X BY 25.4

D	W	H
24	12	33 / 35
24	15	33 / 35
24	18	33 / 35
24	21	33 / 35
24	24	33 / 35
24	27	33 / 35
24	30	33 / 35
24	33	33 / 35
24	36	33 / 35

PRICING

ONE DRAWER (O)

Source Laminate	Foundation Laminate	Flintwood
1116	1223	1842
1176	1295	1945
1250	1376	2059
1409	1549	2323
1469	1612	2417
1528	1682	2525
1601	1760	2640
1677	1842	2761
1732	1908	2861

TWO DRAWERS (T)

Source Laminate	Foundation Laminate	Flintwood
n/a	n/a	n/a
n/a	n/a	n/a
n/a	n/a	n/a
n/a	n/a	n/a
1638	1800	2700
1696	1868	2801
1774	1949	2923
1857	2042	3065
1928	2120	3182

If Full Extension Hinge is specified for widths 12" to 21" add 26

If Full Extension Hinge is specified for widths 24" to 36" add 52

If Stainless Pull is specified for widths 12" to 21" add 52

If Stainless Pull is specified for widths 24" to 36" add 78 (one drawer) or 104 (two drawers)

If a Key Style is specified add 45

Pricing is continued on the following page.

R H B D
Base Cabinet with Drawer(s) and Door(s) (Continued)

**DIMENSIONS – INCHES
 FOR MM X BY 25.4**

D	W	H
29	12	33 / 35
29	15	33 / 35
29	18	33 / 35
29	21	33 / 35
29	24	33 / 35
29	27	33 / 35
29	30	33 / 35
29	33	33 / 35
29	36	33 / 35

PRICING

ONE DRAWER (O)		
Source Laminate	Foundation Laminate	Flintwood
1404	1542	2319
1484	1634	2450
1578	1737	2598
1757	1931	2900
1835	2021	3026
1919	2109	3162
2007	2207	3312
2103	2315	3464
2178	2400	3594

TWO DRAWERS (T)		
Source Laminate	Foundation Laminate	Flintwood
n/a	n/a	n/a
n/a	n/a	n/a
n/a	n/a	n/a
n/a	n/a	n/a
2160	2377	3567
2246	2474	3707
2350	2584	3878
2463	2710	4063
2566	2818	4231

- If Full Extension Hinge is specified for widths 12" to 21" add 26
- If Full Extension Hinge is specified for widths 24" to 36" add 52
- If Stainless Pull is specified for widths 12" to 21" add 52
- If Stainless Pull is specified for widths 24" to 36" add 78 (one drawer) or 104 (two drawers)
- If a Key Style is specified add 45