

# base cabinets

## R H B C D

### Corner Base Cabinet

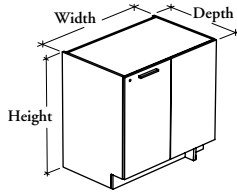

#### WHAT'S INCLUDED

1 case, 1 door, 1 fixed panel, 1 adjustable shelf, pull (as specified), lock and keys (as specified), levelers, and hardware.

#### WHAT'S EXCLUDED

Countertop.

#### NOTES

Door and Fixed Panel Edge Trim Finish does not apply to Flintwood door and fixed panel.

Pull Finish does not apply to Stainless Pull (8).

24" or 29" deep Base Cabinets come with one 24" deep adjustable shelf only.

#### PRODUCT OPTIONS

Depth	Width	Height	Fixed Panel Position	Door and Fixed Panel Finish	Door and Fixed Panel Edge Trim Finish	Case and Shelf Finish	Pull Style	Pull Finish (If applicable)	Key Style (If applicable)
24, 29	24, 27, 30, 33, 36	33, 35	<b>L</b> Left Side <b>R</b> Right Side (Shown)	Source Laminate Foundation Laminate Flintwood	Edge Trim Colors	Source Laminate	<b>1</b> Standard Expansion <b>6</b> Arched <b>7</b> Elliptical <b>8</b> Stainless <b>9</b> Rectilinear	Foundation Accent Mica	<b>R</b> Keyed Randomly <b>K</b> Keyed Alike

#### SAMPLE ORDER CODE

<b>RHBCD</b> 24	<b>27</b>	<b>33</b>	<b>R</b>	<b>XS</b>	<b>ST</b>	<b>XS</b>	<b>1</b>	<b>E</b>	<b>R</b>
--------------------	-----------	-----------	----------	-----------	-----------	-----------	----------	----------	----------

#### DIMENSIONS – INCHES FOR MM X BY 25.4

D	W	H
24	24	33 / 35
24	27	33 / 35
24	30	33 / 35
24	33	33 / 35
24	36	33 / 35
29	24	33 / 35
29	27	33 / 35
29	30	33 / 35
29	33	33 / 35
29	36	33 / 35

#### PRICING

Source Laminate	Foundation Laminate	Flintwood
1010	1113	1666
1048	1156	1733
1087	1199	1798
1141	1256	1883
1182	1298	1947
1443	1586	2378
1501	1655	2477
1563	1722	2577
1635	1799	2700
1698	1862	2797

If Stainless Pull is specified add 22

If a Key Style is specified add 39