

This product was designed especially to facilitate access to people with reduced mobility.

**WHAT'S INCLUDED**

1 case, 1 false drawer front or 2 doors (as specified), pulls (as specified), levelers, and hardware.

**WHAT'S EXCLUDED**

Countertop.

**NOTES**

For people with reduced mobility, this cabinet allows a full front or a lateral approach.

Sink cut-out must be done by the installer.

False Drawer Front and Door Edge Trim Finish does not apply to Flintwood false drawer front and doors.

Metal toe kick has the same finish than the case.

Pull Finish does not apply to Stainless Pull (8).



**R H B A S**  
**Sink Cabinet for People with Reduced Mobility**

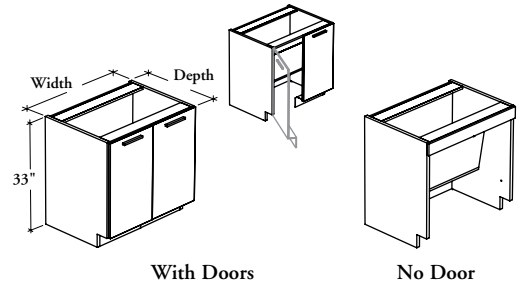

**PRODUCT OPTIONS**

Door Option	Depth	Width	Height	False Drawer Front and Door Finish	False Drawer Front and Door Edge Trim Finish	Case Finish	Pull Style (If applicable)	Pull Finish (If applicable)
<b>D</b> With Doors	24, 29	33, 36, 42	33	Source Laminate Foundation Laminate Flintwood	Edge Trim Colors	Source Laminate	<b>1</b> Standard Expansion <b>6</b> Arched <b>7</b> Elliptical <b>8</b> Stainless <b>9</b> Rectilinear	Foundation Accent Mica
<b>O</b> No Door								

**SAMPLE ORDER CODE**

<b>RHBAS</b> <b>D</b>	<b>29</b>	<b>33</b>	<b>33</b>	<b>XS</b>	<b>ST</b>	<b>XS</b>	<b>9</b>	<b>E</b>
--------------------------	-----------	-----------	-----------	-----------	-----------	-----------	----------	----------

**DIMENSIONS**  
**INCHES – MM**

D	W	H
24 / 610	33 / 838	33 / 838
24 / 610	36 / 914	33 / 838
24 / 610	42 / 1067	33 / 838
29 / 737	33 / 838	33 / 838
29 / 737	36 / 914	33 / 838
29 / 737	42 / 1067	33 / 838

**PRICING**

NO DOOR (O)		
Source Laminate	Foundation Laminate	Flintwood
1034	1053	1158
1073	1093	1206
1163	1187	1306
1303	1329	1462
1358	1384	1523
1459	1490	1638

WITH DOORS (D)		
Source Laminate	Foundation Laminate	Flintwood
1189	1308	1961
1228	1352	2029
1320	1450	2177
1458	1604	2406
1513	1663	2496
1617	1778	2663

If Stainless Pull is specified add 44