

mounted storage & accessories

SHELVES & OVERHEAD STORAGE BASICS 190

PLANNING WITH OVERHEAD CABINETS. 192

PLANNING WITH OVERHEAD UPMOUNT CABINETS 193

PLANNING WITH SHELVES 194

PLANNING WITH SUSPENSION SHELVES 194

STORAGE MAXIMUMS 195

INTEGRATING DISTRICT UNIVERSAL STORAGE OVERHEADS . 196

PLANNING WITH DISTRICT OVERHEAD CABINETS ON LEVERAGE 197

INTEGRATING DISTRICT CREDENZAS WITH
HEIGHT-ADJUSTABLE TABLES 199

ACCESSORY & SCREEN BASICS 200

PLANNING WITH HANG-ON WHITEBOARD. 201

PLANNING WITH ACCESSORY RAILS 202

shelves & overhead storage basics

Leverage offers a variety of mounted storage options.

- Mounted storage may be installed in any location along the panel spine when used with panel-mounted worksurfaces with a flush end gable
- Cabinets are available with locks keyed alike to match other storage components or keyed randomly for a dedicated lock
- Overhead cabinets should **not** be hung over glazed elements

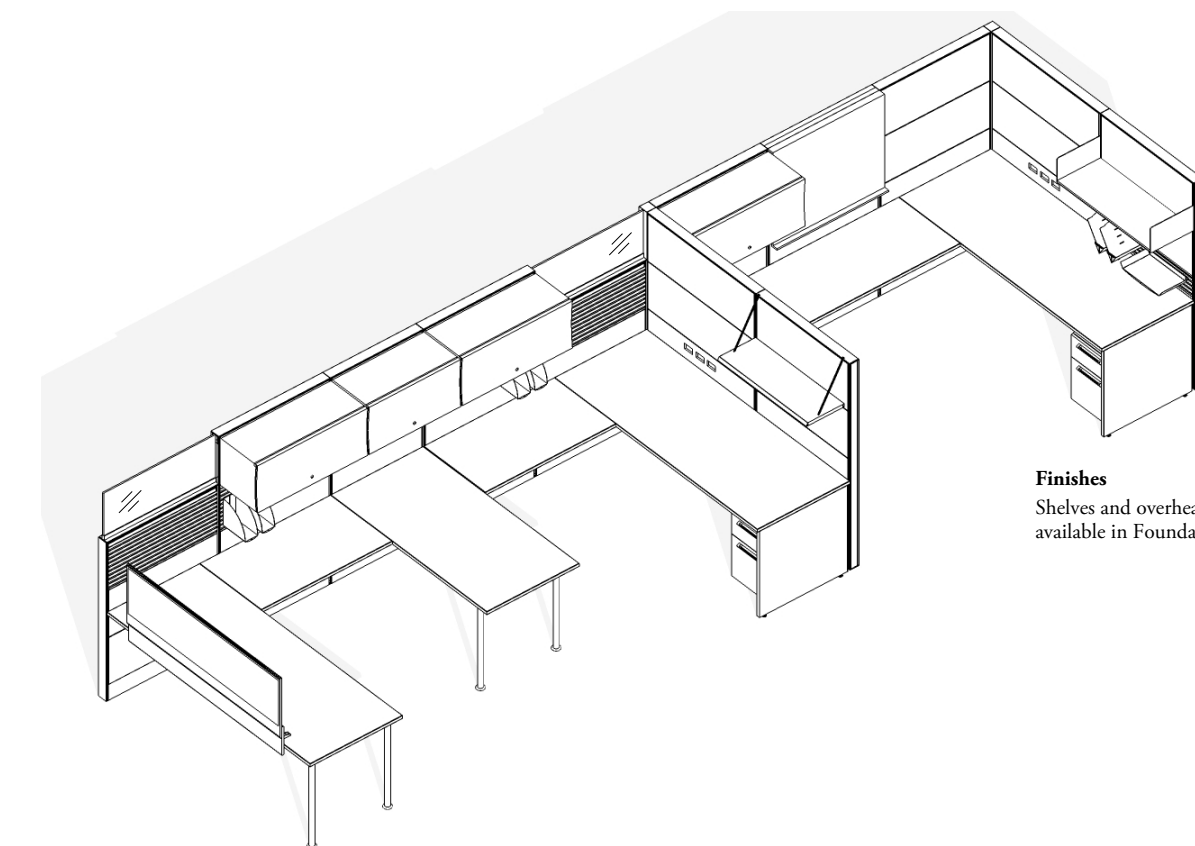

Finishes

Shelves and overhead components are available in Foundation and Mica colors

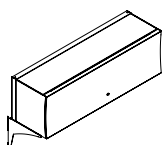

Overhead Upmount (KSU)

- Is a panel-mounted on-module lockable storage unit for lower height panels with an over the cabinets retractable door
- Can be used in single or double sided applications with lay-in wires
- Can be used with Add-On Screens (KPC) to enhance a 51" height work environment
- On-module mounting brackets can only be applied to panels of the same size
- Door with Motion Control Mechanism will be slow closing
- Accepts Shelf Dividers (BK61)

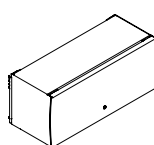

Overhead Cabinet (KSF)

- Is a panel-mounted, on- or off-module lockable storage unit with an over the cabinet retractable door
- When mounting Overhead Cabinet (KSF) on an Panel Add-On (KPOF and KPOW) that is stacked on a panel with high capacity lay-in channel, special brackets may be required. Contact customer service for more information
- Provides storage for both imperial and metric binders
- On-module cabinet can be mounted at any height, however 51" is recommended for accessibility of storage
- Accepts Shelf Dividers (BK61)
- Door with Motion Control Mechanism will be slow closing same size

shelves & overhead storage basics (continued)

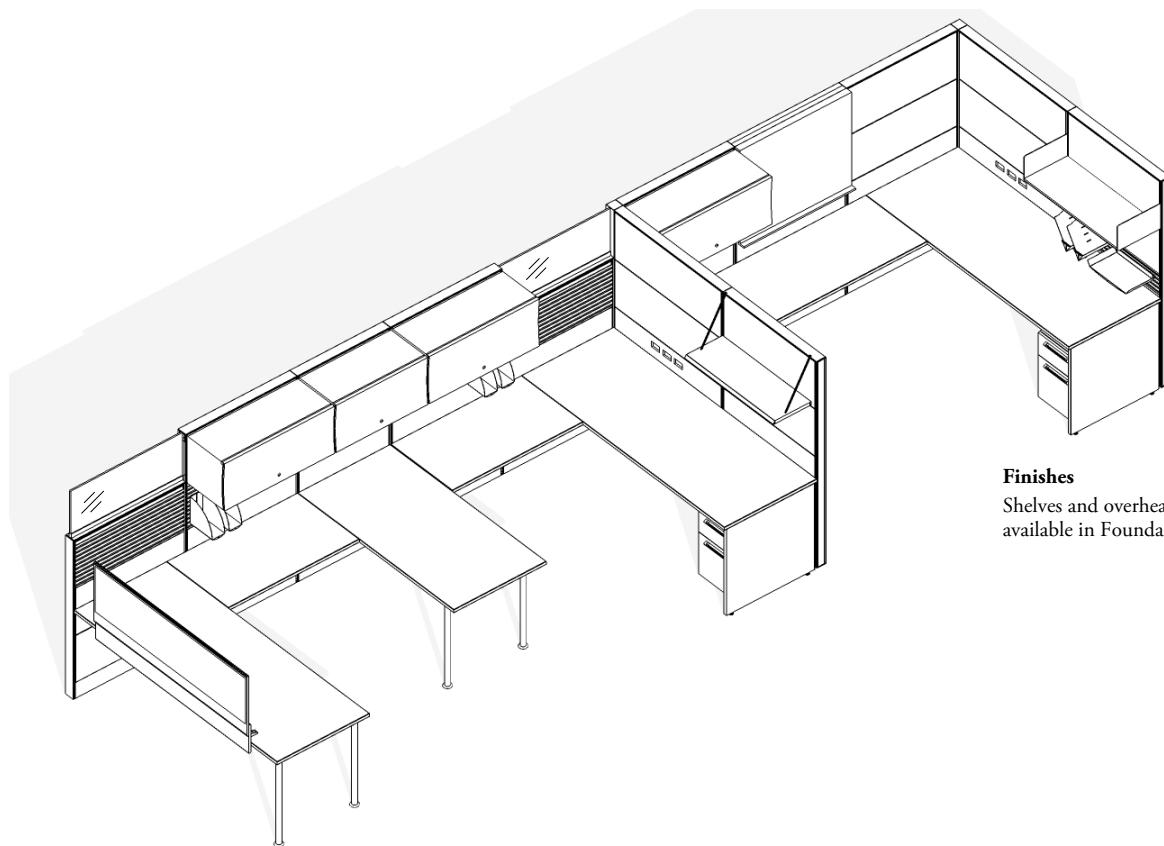
**Finishes**

Shelves and overhead components are available in Foundation and Mica colors

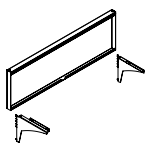
**Overhead Upmount Retrofit Kit (KSR)**

- Allows an existing Leverage Overhead Cabinet (KSF) to be upmounted on-module on a Leverage panel
- On-module mounting brackets can only be applied to panels of the

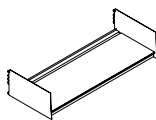
**Shelves (KSS)**

- Provide panel mounted, on-module open storage for both imperial and metric binders
- Can be mounted at any height, however 51" is recommended for accessibility of storage
- Must be applied to same-sized Leverage panels with a Lyft Shelf look
- Can be used with the Panel Add-On (KPOF) and (KPOW)
- Accepts Shelf Dividers (BK61)

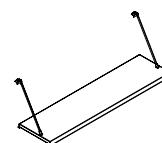
**Suspension Shelf (KSSN)**

- Provides panel-mounted on semi or off-module suspended storage
- Must be applied on same sized or one size larger Leverage Panel
- Light, open aesthetic
- Can be mounted from the top of the panel only
- Can be mounted on Panel Add-On (KPOF and KPOW)
- Width 24"-48" nominal size, but actual width is 2" shorter

planning with overhead cabinets

The following should be considered when planning with Overhead Cabinets.

Overhead Cabinet (KSF) can be mounted to the panel on- or off-module.

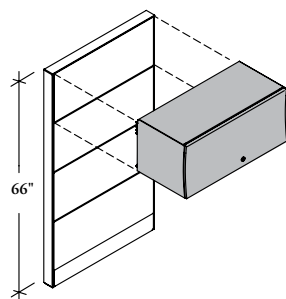

The width of the On-Module Overhead Cabinet (KSF, KSU) must be equal to the width of the panel from which it is suspended

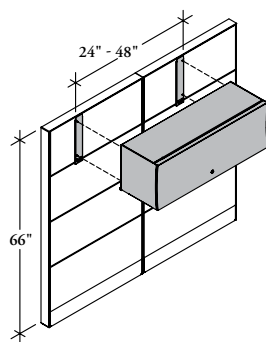

- The Off-Module cabinet requires a rail above and below the cabinet, if a Segmented Panel (KPUC) or Semi-Segmented Panel (KPUS) are **not** specified an additional Panel Rail (KPL) and two 15" elements must be ordered and field installed to support off-module mounting of overheads because they mount into the rail between the elements
- **Cannot** be mounted at a panel-to-panel connector
- Off-module mounting option is available for overhead cabinets with widths from 24" to 48"

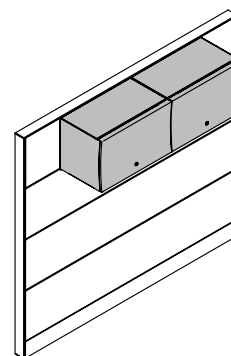

- Two off-module cabinets **cannot** be hung on the same panel unless the combined width is less than that of the panel

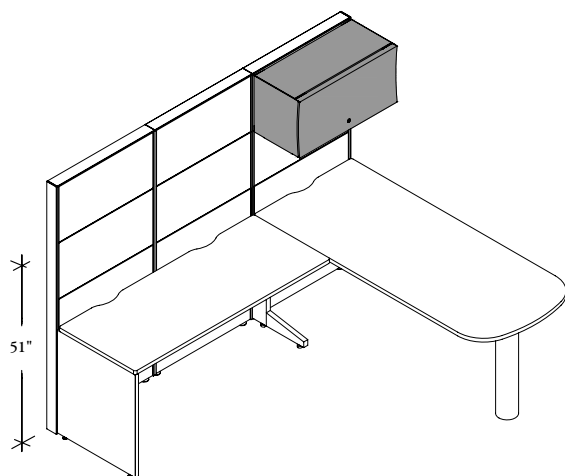

- The Leverage On-Module Overhead Cabinet (KSF_1) can be mounted at any height but for accessibility of storage above the worksurface, a mounting height of 51" above finished floor is recommended

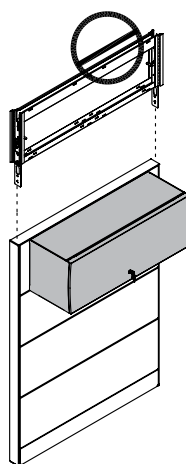

- Add-on panels **cannot** be added to panels with an off-module overhead cabinet
- When mounting an overhead on a Panel Add-On (KPOF and KPOW) that is stacked on a panel with high capacity lay-in channel, special brackets may be required. Contact your Teknion Customer Service Representative

planning with overhead upmount cabinets

The following should be considered when planning with Upmount Cabinets.

In either single- or double-sided applications, Overhead Upmount Cabinets still permit lay-in wires to be accessed and pass by unobstructed.

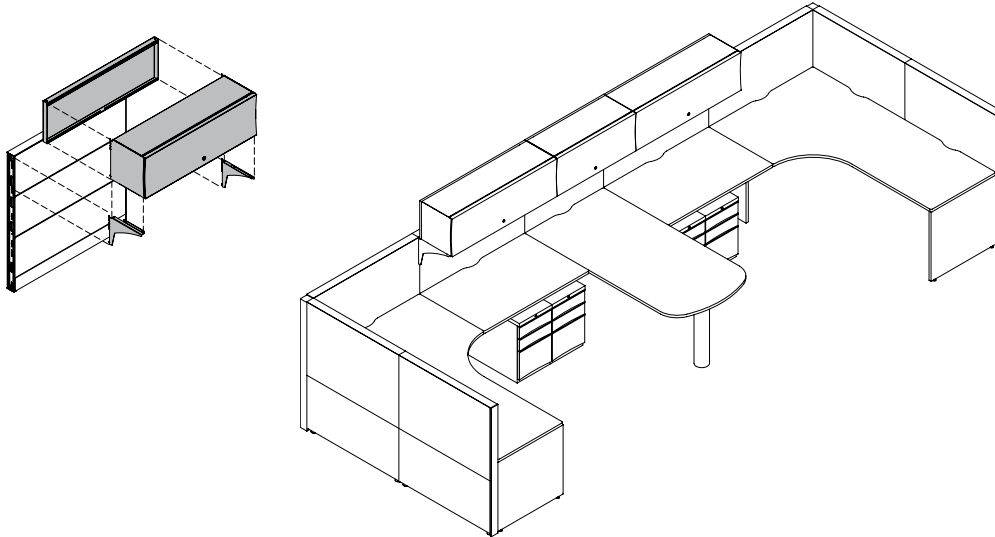

- Retrofit kits are available to convert an Overhead to an Upmount Overhead Cabinet
- Kits include two upmount brackets and a back cover

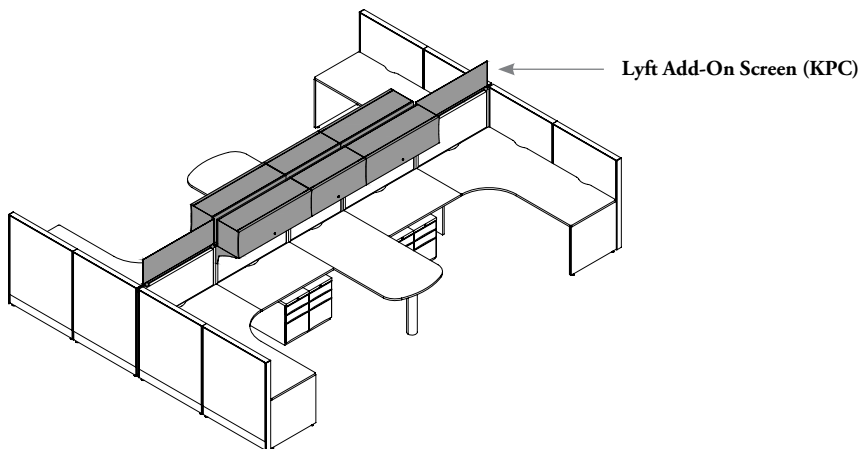

- When used with **Lyft Add-On Screens (KPC)** the functionality of a 51" height work environment can be enhanced

planning with shelves

The following should be considered when planning with Shelves (KSS).

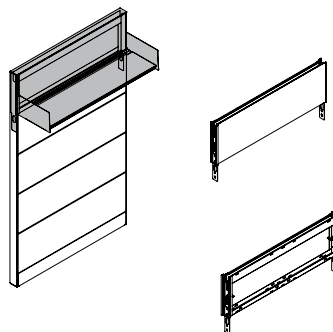
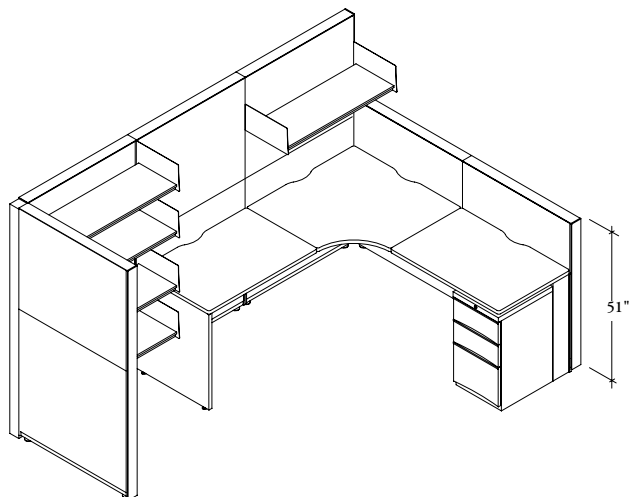

- Can be mounted at any height however, for accessibility of storage above the worksurface, a mounting height of 51" above finished floor is recommended

- The Panel Add-On (KPOF) can be used with the Shelf (KSS)
- All Leverage shelves must be mounted to the panel on-module
- The width of the shelf **must** be equal to the width of the panel from which it is suspended

planning with suspension shelves

The following should be considered when planning with Suspension Shelves (KSSN).

Shelves can be mounted on-module and off-module.

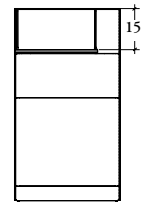
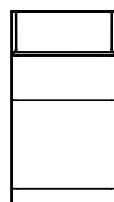
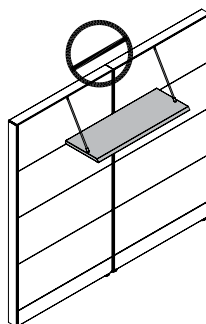
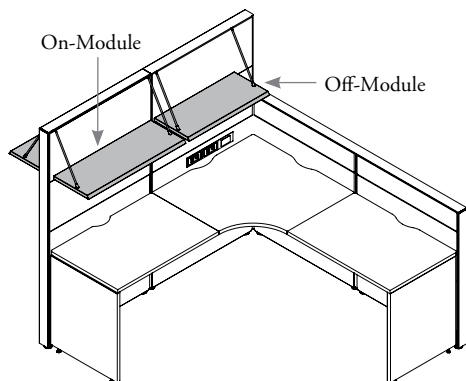

- The shelf always suspends from the panel
- The height is always 15" below the top

- The Suspension Shelf **cannot** be mounted off-module across two panels

- When mounted on-module can be on 30" high element
- Only one shelf can be mounted per panel

- When the shelf is mounted off-module it must be mounted into a segmented element for support in corner
- Shelves can be the same width or less than the panel that it is mounting onto

storage maximums

Leverage Panels are able to suspend a multitude of storage products for increased efficiency of the work space. The illustrations below demonstrate the functionality of Leverage mounted storage products.

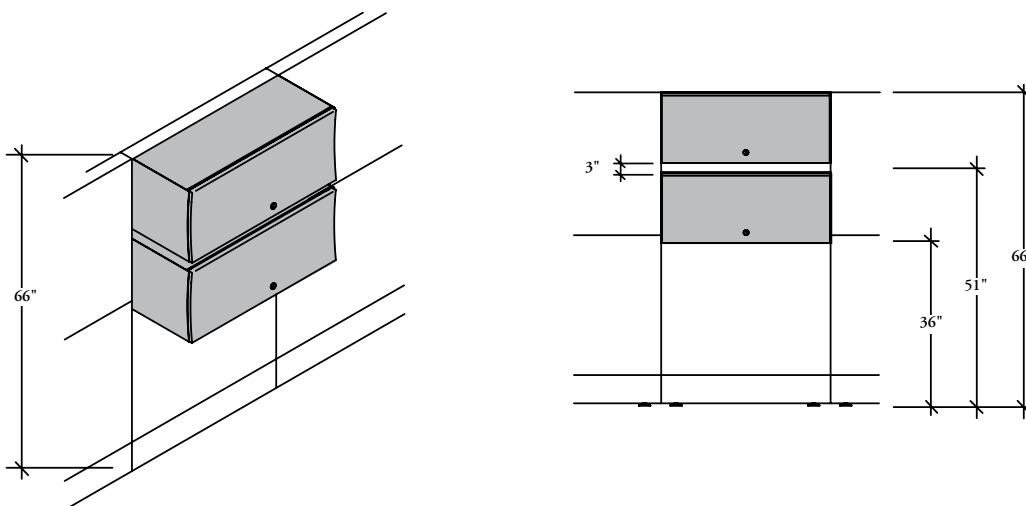

- An Overhead Cabinet (KSF) and Shelf (KSS) provide storage and can be mounted above each other
- Overhead Cabinets (KSF) are mounted to the panel to provide storage for documents including both imperial and metric binders
- The Leverage On-Module Overhead Cabinet (KSF_1) can be mounted at any height
- For accessibility of storage above the worksurface, a mounting height of 51" above finished floor is recommended

integrating district universal storage overheads

District Storage can be integrated with Leverage Panels. The following should be considered when blending the two products.

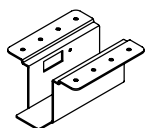
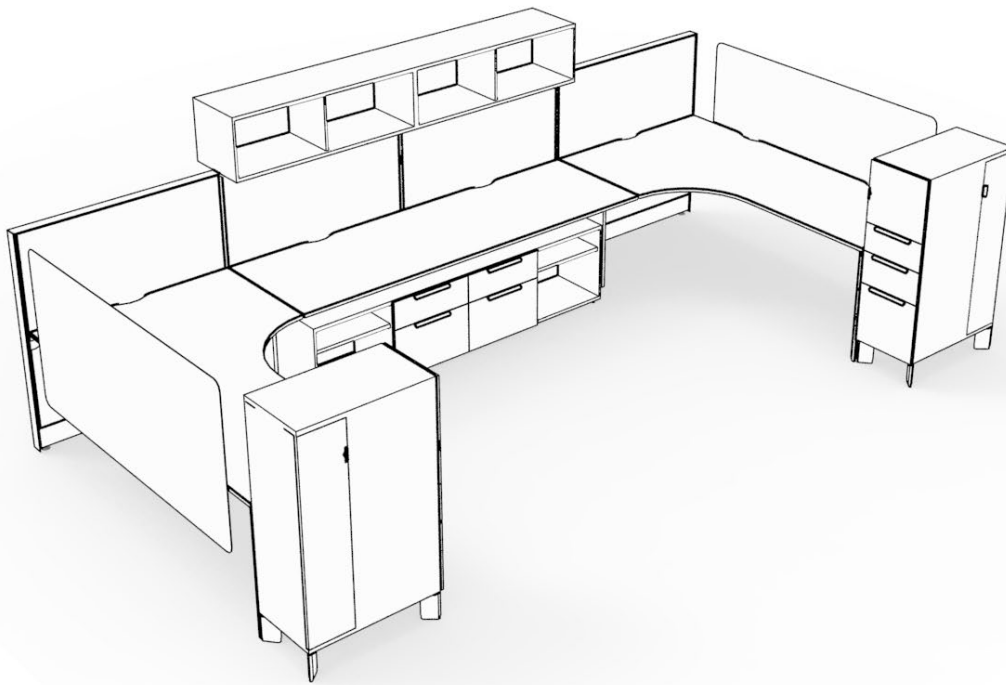

Centermount Storage Bracket (KUOHC)

- Attaches District Centermount Overhead Cabinet to Leverage Panels
- Mounts to the top trim and to the base of the centermount cabinet
- 1 Kit contains 2 brackets:
 - 24"-42" wide overheads = 1 kit (2 brackets)
 - 48"-96" wide overheads = 2 kits (2 x 2 brackets)

planning with district overhead cabinets on leverage

centermount cabinets

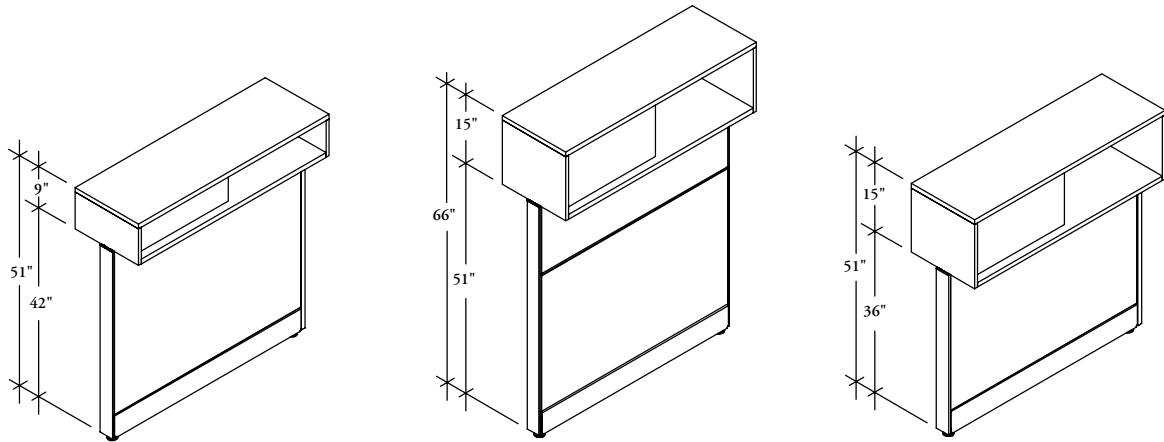

- Centermount cabinets are available 9" and 15" high, so that when they are mounted to Leverage Panels, they match standard Teknion datum heights

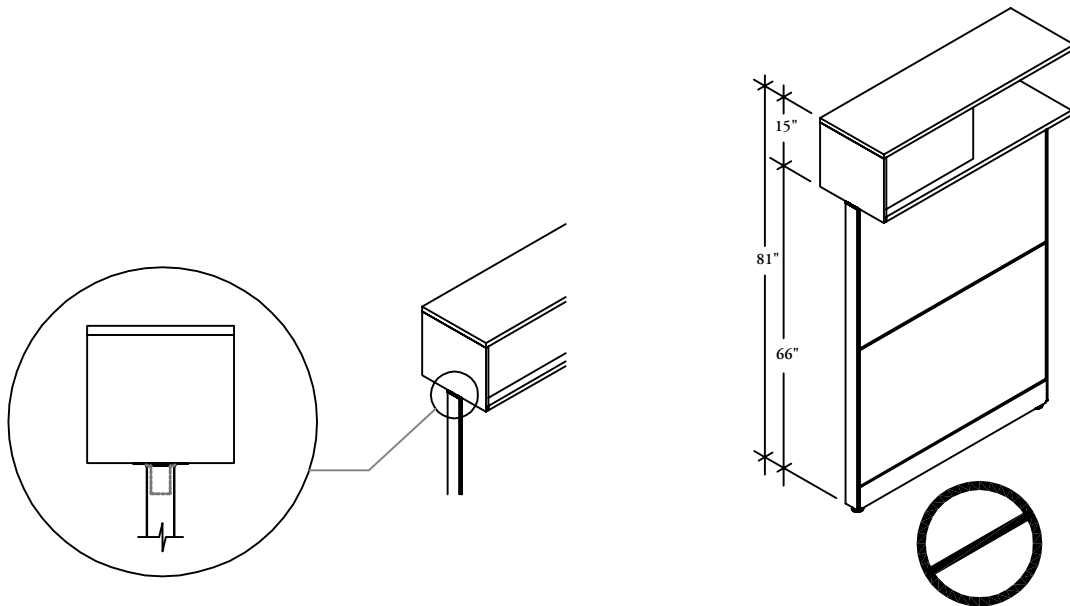

- Centermount cabinets **cannot** mount onto 30" high panels, because the mounting bracket which mounts to the top trim will **not** fit onto this height due to the construction of the panel
- They also **cannot** mount to 42" high panels
- The maximum height for a centermount cabinet is 66" high
- Cabinets **cannot** be mounted above a 66" high panel to reach a datum height of 81"

planning with district overhead cabinets on leverage (continued)

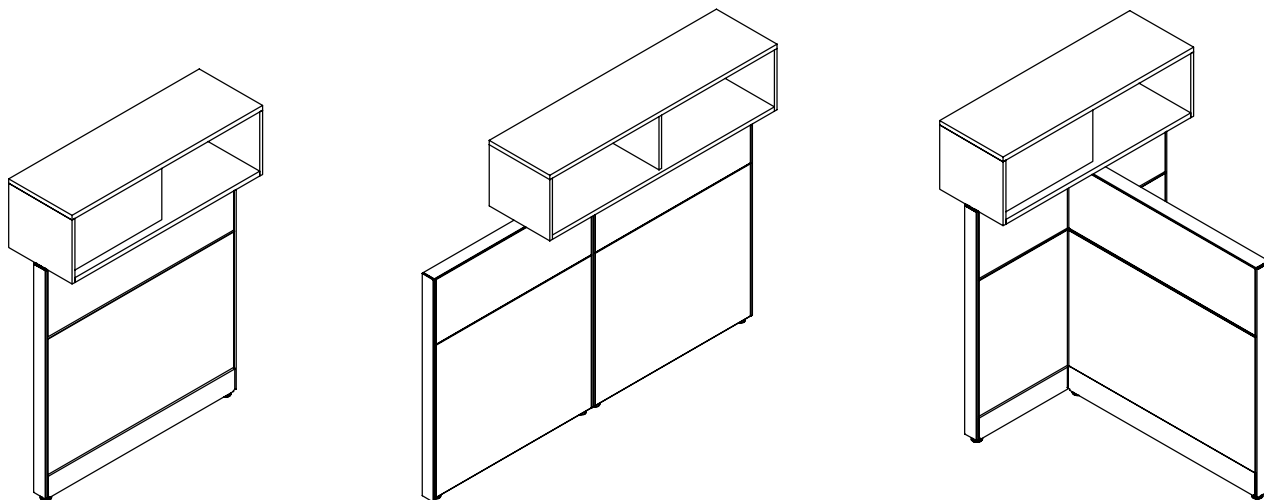

- Centermount overheads can be mounted at Two-Way, Three-Way and Four-Way Connections
- Can be mounted on- or off-module. Off-module mount is limited to Panels with Lay-in Channels. When mounted off-module one end of the Centermount overhead needs affix with one end of the panel
- 120° connections are **not** possible

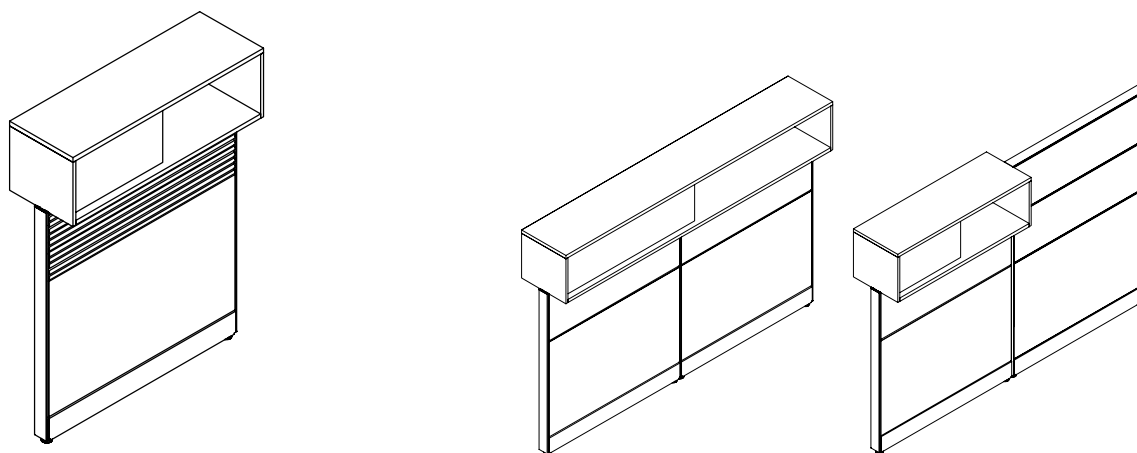

- Centermount overheads can mount over Fabric, Metal, Wood, and Accessory Rail Elements, but **not** over Glass Elements
- A single centermounted overhead can span over two smaller panels and can be on a panel run with panels at different heights
- The Intermediate Trim will **not** fit, so must be left off

integrating district credenzas with height-adjustable tables

District Credenzas for Height-Adjustable Tables can be integrated with Leverage Panels. The following should be considered when blending the two products.

credenzas for height adjustable tables and storage to panel brackets

- All District Credenzas for Height Adjustable Tables attach to Leverage panels with either parallel, perpendicular front or perpendicular back brackets

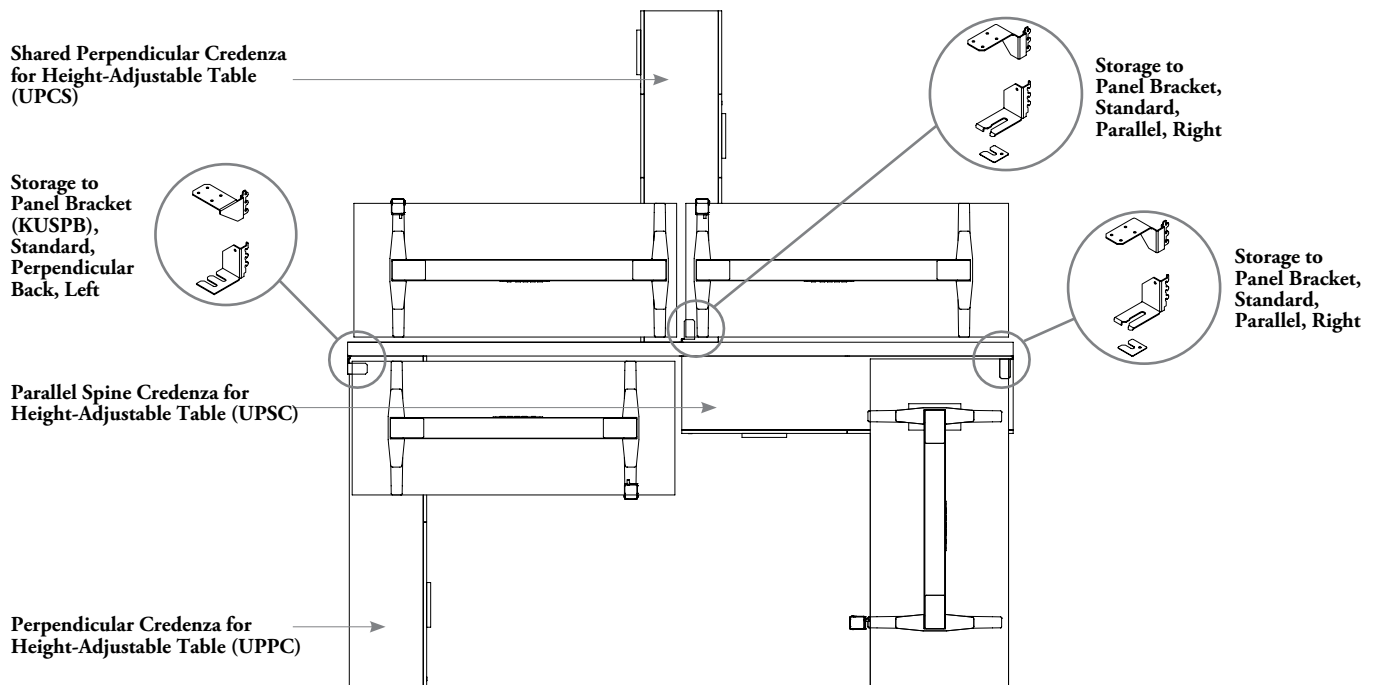

For more information, see *planning with storage-to-panel brackets for district storage integration*.

credenzas for height adjustable tables and electrics

- The following should be considered when planning electrical with District credenzas for height adjustable tables
- Parallel and perpendicular credenza planning will affect the location of a cut out for power access

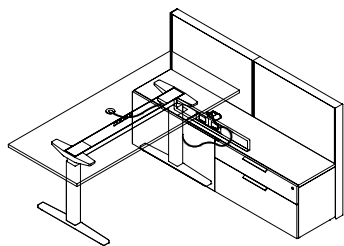

- Parallel Spine Credenzas for Height-Adjustable Tables (UPSC) are the only credenzas for height-adjustable tables that can be specified with a cut out in the back

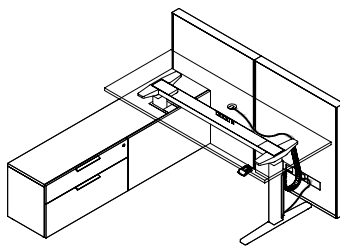

- Perpendicular Credenzas for Height-Adjustable Tables (UPPC) do not have the option for specifying a cut out
- Wire will be routed through the grommet to Vertical Wire Carrier (YEEE) which must be specified separately
- Vertical Wire Carrier (YEEE) will mount to the leg that is not in the credenza

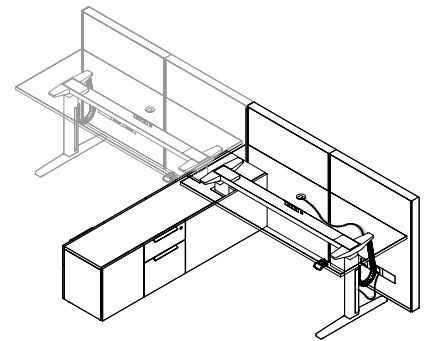

- Shared Perpendicular Credenzas for Height-Adjustable Tables (UPCS) do not have the option of specifying a cut out
- Wires will be routed through the grommet to the Vertical Wire Carrier and then directly to the power box in the panel

accessory & screen basics

Leverage offers a variety of accessories that can be hung on-module inside or outside a workstation to facilitate organization of the workstation.

Finishes

Above accessories are available in Foundation, Accent and Mica colors with the exception of the whiteboard frame which is Black

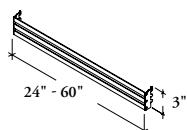
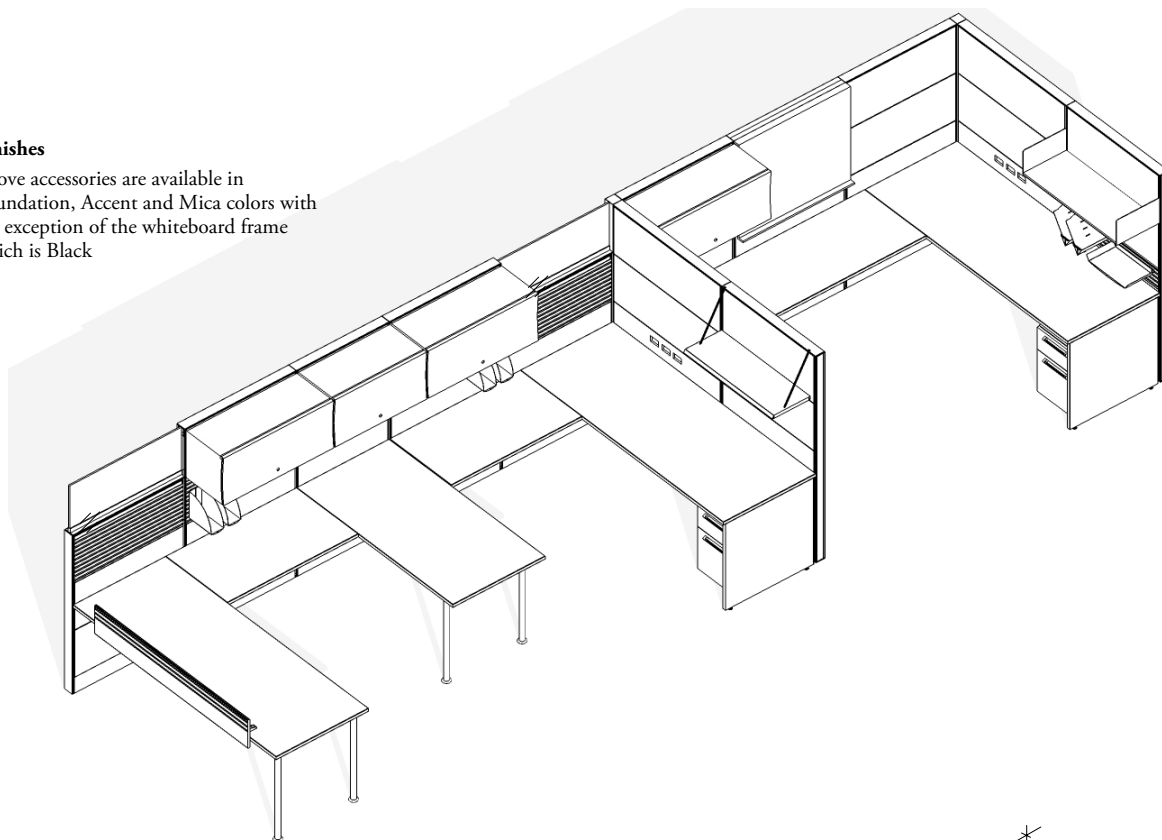

Accessory Rail (KMA)

- Supports Personal Organizers (PAX)
- Can only be attached on-module into the hingeway on a fabric covered element
- Must match the width of the panel
- Two rails are required for binder bins (PAX95). Up to three accessory rails can be attached over a single 15" or 30" high fabric element
- If the rail is supporting the Binder Bin (PAX), Vertical Organizer, Letter/A4 (PAX99) or Legal (PAX100), it should be mounted at a height sufficient to provide clearance between the Vertical Organizer (PAX99/PAX100) and the worksurface
- **Cannot** be attached at the same level when coming together in a corner situation
- Along with lighting wire, management clips **cannot** be attached in the same hingeway

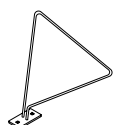

Shelf Divider (BK61)

- Separates books, paper, binders and other items on the Overhead Cabinet (KSF) or Shelf (KSS)
- Slips into the rail at the back of the overhead cabinet (KSF) or shelf (KSS) and can be positioned anywhere along its length

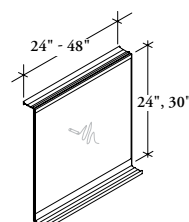

Hang-On Whiteboard (KMW)

- Is reversible erasable message board with a marker tray
- Mounts on-or off-module to the top of any panel
- **Cannot** be applied to a panel where an Overhead Cabinet (KSF) is located on the opposite side of the panel

planning with hang-on whiteboard

The following should be considered when planning with the Hang-On Whiteboard (KMW).

Hang-On Whiteboard (KMW)

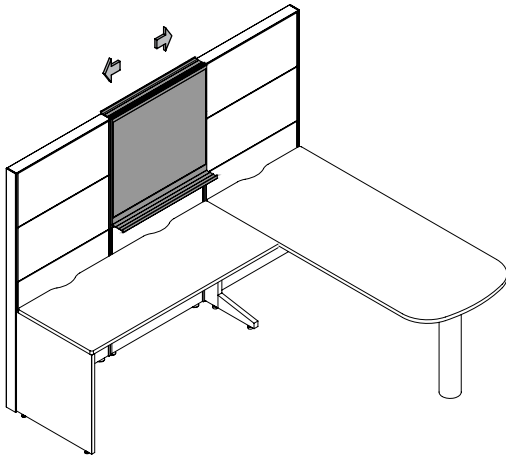

- Can be mounted on- or off-module
- Portable so allows for it to be moved around the work space

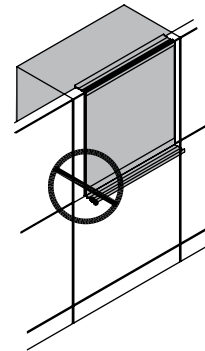

- **Cannot** be applied to a panel where an Overhead Cabinet (KSF) is located on the opposite side of the panel

planning with accessory rails

The following should be considered when planning with the Accessory Rail (KMA).

A maximum of three Accessory Rails can be attached over a single 15" or 30" high Fabric Element (KES)

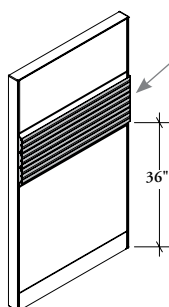

- Must be used on-module
- Width must match the width of the panel

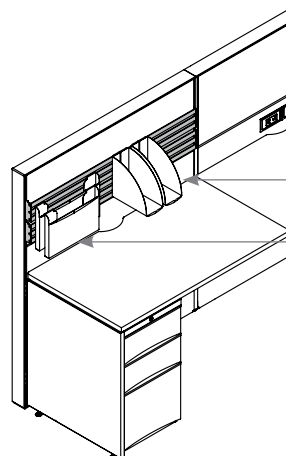

Binder Bins
(PAX95)
Vertical Organizers
(PAX99/100)

- When the Accessory Rail supports Binder Bins (PAX95) and Vertical Organizers (PAX99/PAX100), two Accessory Rails are necessary to provide adequate support

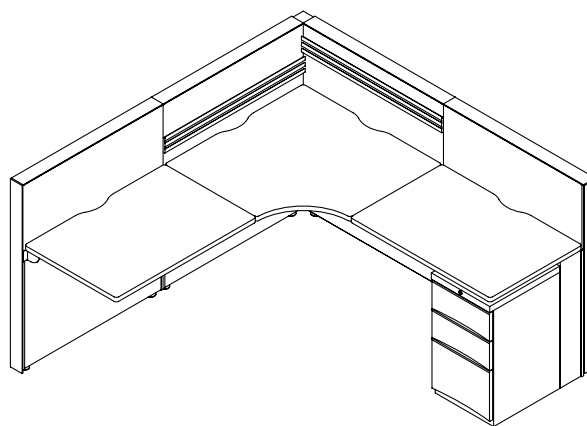
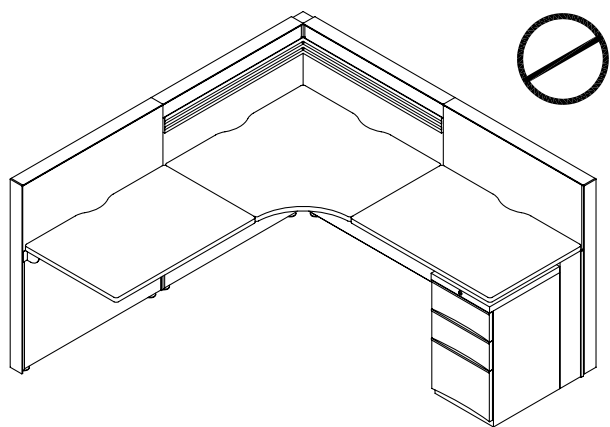

- Accessory Rail **cannot** be used at the same level where two panels meet at a 90° corner, however, it can be used in a corner situation when the mounting heights are offset