

Xpress

K S S  
Shelves

Shelves provide panel-mounted, on-module open storage in the workstation.

WHAT'S INCLUDED

1 shelf, panel-mounting on-module hardware, shipped knocked down.

NOTES

These Shelves must be hung on-module.

Xpress Available through Teknion's Xpress Program.

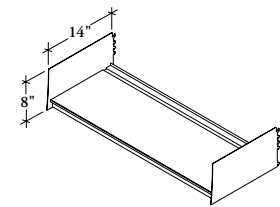

PRODUCT OPTIONS

Width (in 6" increments)	Finish
24 - 60	Foundation Mica

SAMPLE ORDER CODE

KSS 24	Q
--------	---

DIMENSIONS  
INCHES / MM

W
24 / 610
30 / 762
36 / 914
42 / 1067
48 / 1219
54 / 1372
60 / 1524

PRICING

Foundation	Mica
233	266
240	273
256	282
266	296
273	309
309	339
339	370