

# freestanding storage & accessories

FREESTANDING PEDESTAL BASICS . . . . . 206

STRETCH PEDESTAL BASICS . . . . . 208

PLANNING WITH STRETCH PEDESTALS. . . . . 209

## freestanding pedestal basics

**The Leverage Pedestal (KDN) and Mobile Pedestals (KDSN and KDWN) provide storage below the worksurface.**

- The Pedestal (KDN) is dimensionally compatible with consistent horizontal lines
- Pedestals are made of steel construction with levelers at the base for adjustability in the field
- Pedestals are available with locks keyed alike to match other storage components or keyed randomly for a dedicated lock
- Counterweights are required for all pedestals with or without casters, with the exception of 27.2" high pedestals (BBF, LF) permanently situated under a worksurface
- Mobile Pedestals are available with two balance options
  - Four casters and a counterweight
  - Five casters with no counterweight
- All configurations of Pedestal (KDN) on casters fit under the regular 29" high worksurface, with no obstructions underneath

### Finishes

- The handle on the Mobile Pedestal with Seat is Black
- Casters are Grey and Counterweights are Black
- Locks have a brushed chrome finish
- All accessories are Black

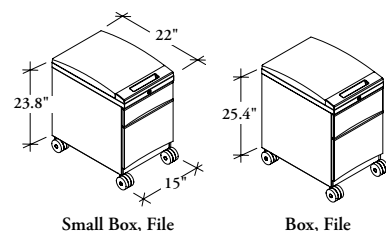

### Mobile Pedestal with Seat (KDSN)

- Provides temporary casual seating within a workstation
- Fits beneath a standard height workstation or table
- Available in a Small Box, File (SF) and Box, File (BF) configurations
- Can accommodate imperial-size or A4 hanging files
- The two back casters are lockable
- Requires a yard of fabric to upholster the seat
- Drawer interiors extend the full interior depth of the pedestal except for 28" deep Box (B), Small Box (S) and Pencil Box (P). For these drawer sizes the interior drawer depth is actually 22"

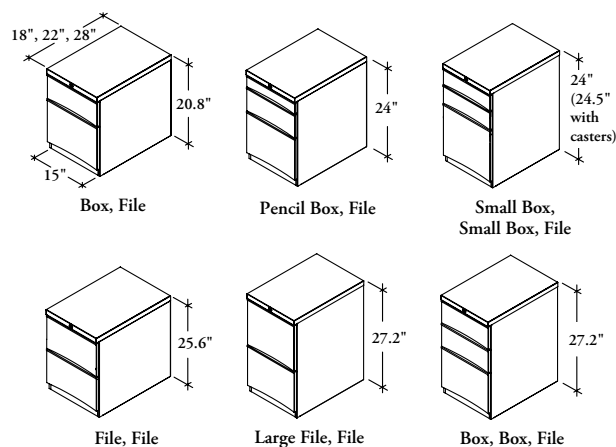
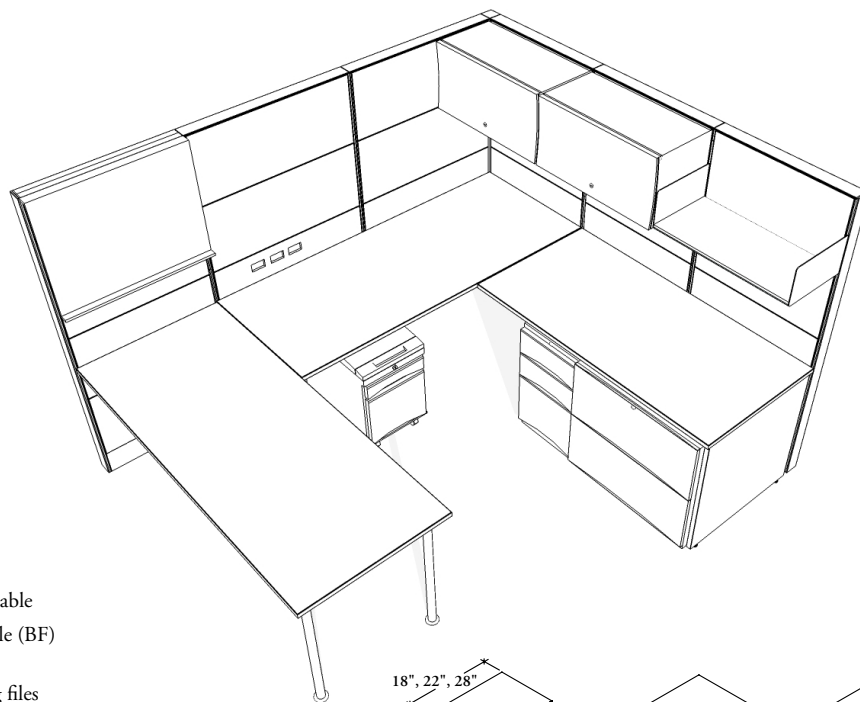

### also available

#### Mobile Pedestal (KDWN)

- Drawer interiors extend the full interior depth of the pedestal except for 28" deep Box (B), Small Box (S) and Pencil Box (P). For these drawer sizes the interior drawer depth is actually 22"

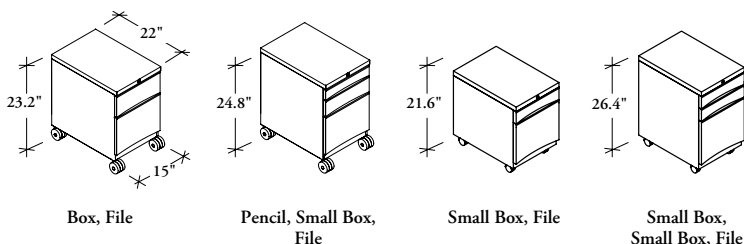

#### Pedestal (KDN)

- Is available in six drawer configurations
- **Cannot** be suspended from a worksurface
- Can accommodate imperial or letter-size hanging files using conversion rails
- May be specified to support a worksurface when Box, Box, File (BBF) or Large File, File (LF) drawer configurations are chosen
- Drawer interiors extend the full interior depth of the pedestal except for 28" deep Box (B) and Pencil Box (P). For these drawer sizes the interior drawer depth is actually 22"

## freestanding pedestal basics (continued)

The Leverage Mobile Pedestal with Cushion (KDCN) integrates a sleek style, low profile seat cushion.

- Pedestal Accessories (DA) are included with the Pedestals for better space optimization and enhanced drawer organization
- Pedestals are made of steel construction with levelers at the base for adjustability in the field
- Pedestals are available with locks keyed alike to match other storage components or keyed randomly for a dedicated lock
- Pedestals are available with two balance options
  - Four casters and a counterweight
  - Five casters with no counterweight

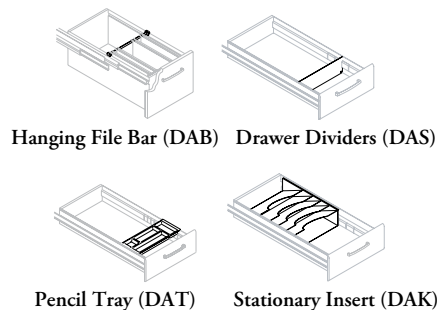
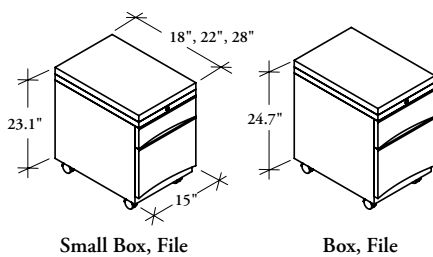
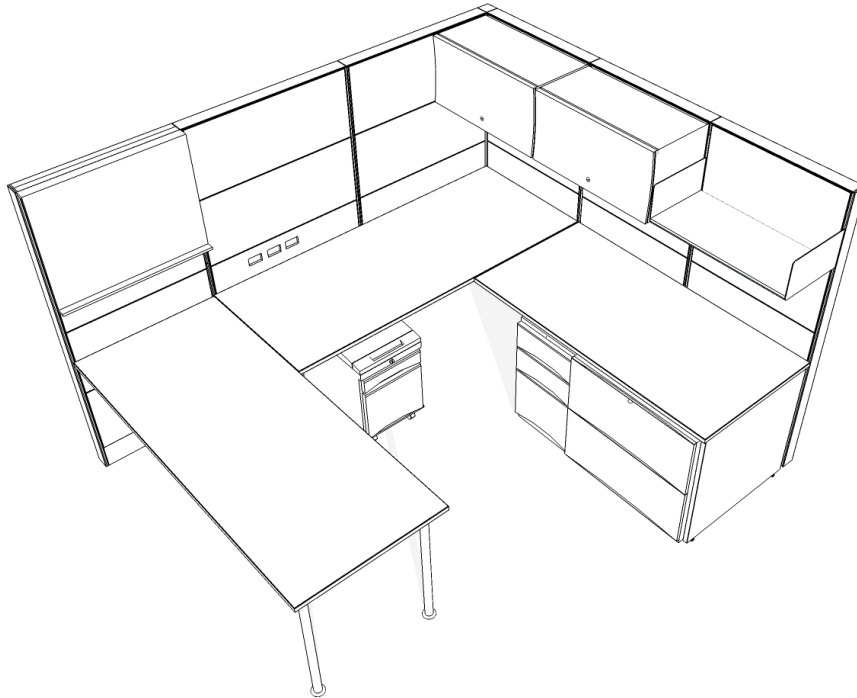

Example of five caster application.

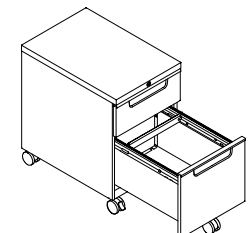
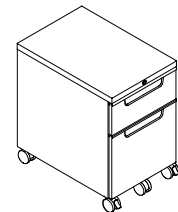

### Mobile Pedestal with Cushion (KDCN)

- Has a low profile flat seat cushion
- Provides temporary casual seating within a workstation
- Fits beneath a standard height workstation or table
- Available in a Small Box, File (SF), Box, File (BF), Small Box, File with Five Casters (VSF) and Box, File with Five Casters (VBF) configurations
- Can accommodate imperial-size or A4 hanging files
- The two back casters are lockable
- Requires a yard of fabric to upholster the seat

### Pedestal Accessories (DA)

Are included with the pedestal and mobile pedestal as noted on the product page; additional accessories may be ordered separately as necessary

## stretch pedestal basics

The Leverage Stretch Pedestal (KDEN) provides storage below the worksurface.

- The Stretch Pedestal is dimensionally compatible with consistent horizontal lines
- Stretch Pedestals are made of steel construction with levelers at the base for adjustability in the field
- Stretch Pedestals are available with locks keyed alike to match other storage components or keyed randomly for a dedicated lock
- Counterweights are required for all Stretch Pedestals not located under a worksurface

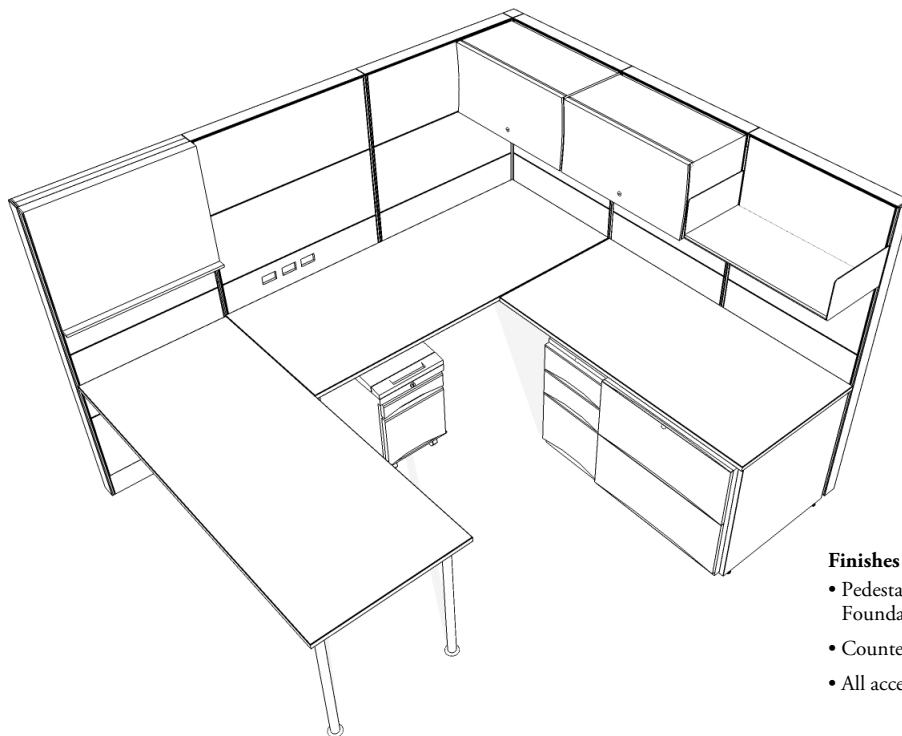

### Finishes

- Pedestals are available in Foundation and Mica colors
- Counterweights are Black
- All accessories are Black

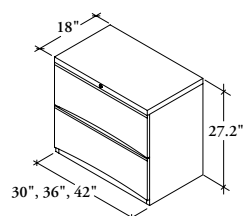

### Stretch Pedestal (KDEN)

- **Cannot** be suspended from a worksurface
- Can accommodate imperial and metric size documents
- Width should be less than the dimension between worksurface supports of the worksurface it is below

### Stretch Pedestal Accessories (FA)

Are included with the pedestal and mobile pedestal as noted on the product page; additional accessories may be ordered separately as necessary.

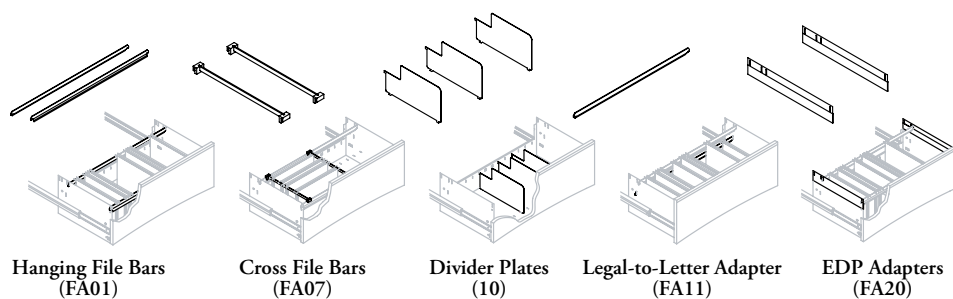

## planning with stretch pedestals

The following should be considered when planning with the Stretch Pedestal (KDEN).

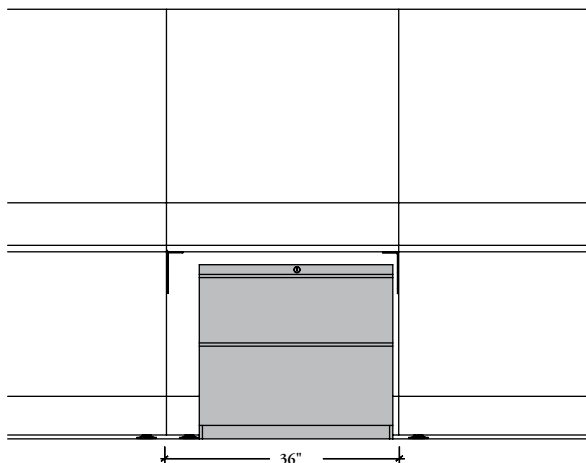

- The Stretch Pedestal (KDEN) is dimensioned to fit beneath the worksurface for lateral storage
- It can be placed anywhere below the worksurface, and is not dependent on panel widths for placement
- The width of the Stretch Pedestal should be less than the dimension between worksurface supports of the worksurface it is below

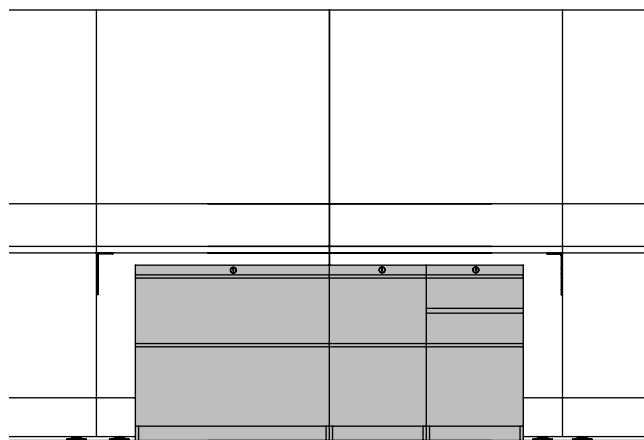

- The Pedestal (KDN) and Stretch Pedestal (KDEN) are dimensionally compatible with consistent horizontal lines