

freestanding storage

CJTL

Tower, Open & Lateral Storage

WHAT'S INCLUDED

1 tower, upper open storage with fixed shelves, lateral box/box/file or file/file lower storage (as specified), pulls (as specified), lock and keys (if specified).

NOTES

For Wood Grain Directions, see the *Application Guide* section.

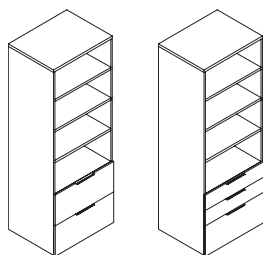

PRODUCT OPTIONS

Storage Type	Height	Depth	Width	Case Finish	Pull Style	Pull Finish	Lock Option
B Box/Box/File F File/File	56, 69, 83	20, 24	24, 30, 36	Flintwood Veneer Journal Laminate	R Rectangular J Journal	7 Platinum V Very White E Ebony X Anthracite	N No Lock K Key Alike R Random

SAMPLE ORDER CODE

CJTL B	56	20	24	FX	J	V	K
---------------	-----------	-----------	-----------	-----------	----------	----------	----------

DIMENSIONS INCHES / MM

H	D	W
56 / 1422	20 / 508	24 / 610
56 / 1422	20 / 508	30 / 762
56 / 1422	20 / 508	36 / 915
56 / 1422	24 / 610	24 / 610
56 / 1422	24 / 610	30 / 762
56 / 1422	24 / 610	36 / 915
69 / 1753	20 / 508	24 / 610
69 / 1753	20 / 508	30 / 762
69 / 1753	20 / 508	36 / 915
69 / 1753	24 / 610	24 / 610
69 / 1753	24 / 610	30 / 762
69 / 1753	24 / 610	36 / 915
83 / 2108	20 / 508	24 / 610
83 / 2108	20 / 508	30 / 762
83 / 2108	20 / 508	36 / 915
83 / 2108	24 / 610	24 / 610
83 / 2108	24 / 610	30 / 762
83 / 2108	24 / 610	36 / 915

PRICING

CASE FINISH

FILE/FILE (F)			BOX/BOX/FILE (B)		
Journal Laminate	Flintwood	Veneer	Journal Laminate	Flintwood	Veneer
1533	2323	2439	1579	2393	2512
1565	2372	2490	1612	2442	2565
1598	2421	2543	1645	2493	2617
1613	2443	2566	1661	2516	2643
1645	2492	2616	1694	2567	2694
1693	2566	2693	1744	2643	2775
1780	2697	2833	1834	2778	2917
1828	2771	2911	1883	2854	2997
1878	2845	2987	1934	2930	3076
1887	2859	3001	1943	2946	3093
1945	2949	3096	2004	3037	3189
2004	3037	3189	2065	3128	3283
2013	3051	3204	2073	3142	3299
2063	3125	3281	2125	3219	3379
2108	3195	3354	2171	3291	3454
2110	3198	3358	2174	3295	3459
2191	3321	3487	2258	3420	3591
2265	3432	3603	2333	3534	3710

If Lock is specified, add 55