

WHAT'S INCLUDED

1 storage cabinet, fixed shelves (as specified), valance with light (if specified), wall clear and mounting hardware

NOTES

1 High configuration has no internal shelf.

2 High configuration has 1 internal shelf.

3 High configuration has 2 internal shelves.

For Wood Grain Directions, see the *Application Guide* section.

C J M O
Wall Mount Storage, Open

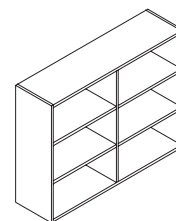

PRODUCT OPTIONS

Configuration Height	Depth	Width	Case Finish	Light Option
1H 1 High, 14-1/2" 2H 2 High, 28" 3H 2 High, 41-1/2"	14	30, 32, 36, 42, 48, 54, 60, 64, 66, 72, 78, 84, 90, 96	Flintwood Veneer Journal Laminate	N None L Light, Graphic Valance E Light, Ebony Valance V Light, Very White Valance 7 Light, Platinum Valance

SAMPLE ORDER CODE

CJMO 2H	14	72	FX	N
----------------	-----------	-----------	-----------	----------

**DIMENSIONS
INCHES / MM**

D	W
14 / 356	30 / 762
14 / 356	32 / 813
14 / 356	36 / 914
14 / 356	42 / 1067
14 / 356	48 / 1219
14 / 356	54 / 1372
14 / 356	60 / 1524
14 / 356	64 / 1626
14 / 356	66 / 1676
14 / 356	72 / 1829
14 / 356	78 / 1981
14 / 356	84 / 2134
14 / 356	90 / 2286
14 / 356	96 / 2438

PRICING

1 HIGH (1H)			2 HIGH (2H)			3 HIGH (3H)		
Journal Laminate	Flintwood	Veneer	Journal Laminate	Flintwood	Veneer	Journal Laminate	Flintwood	Veneer
827	1182	1241	1107	1580	1660	1305	1864	1958
846	1209	1269	1130	1614	1695	1338	1912	2008
884	1263	1325	1178	1683	1768	1405	2008	2108
940	1343	1409	1251	1787	1877	1505	2150	2258
997	1424	1495	1324	1892	1987	1605	2293	2409
1053	1504	1580	1397	1995	2095	1706	2437	2558
1110	1586	1665	1470	2099	2204	1806	2579	2709
1148	1639	1721	1518	2169	2278	1873	2675	2808
1166	1666	1749	1542	2203	2314	1906	2723	2860
1223	1747	1834	1615	2307	2422	2007	2866	3009
1279	1827	1918	1688	2412	2532	2106	3009	3160
1336	1908	2004	1760	2514	2640	2207	3152	3310
1393	1989	2089	1833	2619	2749	2307	3296	3461
1449	2070	2173	1906	2723	2859	2408	3439	3610

If Light is specified for 30" - 42", add 250

If Light is specified for 48" - 66", add 288

If Light is specified for 72" - 96", add 354