

C J H H

Hutch, Hinged Doors

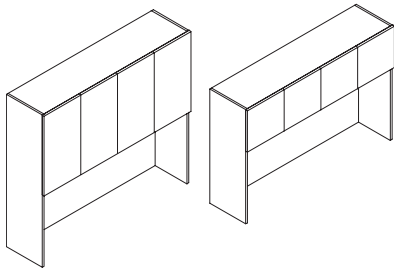

WHAT'S INCLUDED

1 hutch, hinged doors, adjustable shelves (as specified), tackable fabric panel (if specified), valance with light (if specified), lock and key (if specified).

NOTES

Hutches are to be paired with 2 High Credenza configurations.

3 High configuration has 1 High storage with no internal shelf.

4 High configuration has 2 High storage with 1 fixed shelf.

For Wood Grain Directions, see the *Application Guide* section.

PRODUCT OPTIONS

Height & Storage Mount Type	Depth	Width	Case Finish
3HF 3 High Overall, 1 High Storage, Finished Top, 40-1/2"	14	60, 64, 66, 72, 78, 84, 90, 96	Flintwood Veneer Journal Laminate
3HI 3 High Overall, 1 High Storage, Integral Top, 41-5/8"			
4HF 4 High Overall, 2 High Storage, Finished Top, 54"			
4HI 4 High Overall, 2 High Storage, Integral Top, 55-1/8"			

SAMPLE ORDER CODE

CJHH 3HF	14	72	FX
-----------------	-----------	-----------	-----------

PRODUCT OPTIONS (CONTINUED)

Backboard Finish	Door Finish	Light Option	Lock
MC Match Case Tackable Fabric	Seamless Flintwood Veneer Journal Laminate	N None L Light, Graphic Valance E Light, Ebony Valance V Light, Very White Valance 7 Light, Platinum Valance	N No Lock K Key Alike R Key Random

SAMPLE ORDER CODE (CONTINUED)

MC	ZI	N	K
-----------	-----------	----------	----------

See Pricing on the following page.

C J H H Hutch, Hinged Doors (Continued)

**DIMENSIONS
INCHES / MM**

D	W
14 / 356	60 / 1524
14 / 356	64 / 1626
14 / 356	66 / 1676
14 / 356	72 / 1829
14 / 356	78 / 1981
14 / 356	84 / 2134
14 / 356	90 / 2286
14 / 356	96 / 2438

14 / 356	60 / 1524
14 / 356	64 / 1626
14 / 356	66 / 1676
14 / 356	72 / 1829
14 / 356	78 / 1981
14 / 356	84 / 2134
14 / 356	90 / 2286
14 / 356	96 / 2438

14 / 356	60 / 1524
14 / 356	64 / 1626
14 / 356	66 / 1676
14 / 356	72 / 1829
14 / 356	78 / 1981
14 / 356	84 / 2134
14 / 356	90 / 2286
14 / 356	96 / 2438

PRICING

DOOR FINISH							
1 HIGH STORAGE				2 HIGH STORAGE			
Journal Laminate	Seamless	Flintwood	Veneer	Journal Laminate	Seamless	Flintwood	Veneer
229	239	430	451	293	343	552	580
240	254	454	477	311	365	586	616
249	261	468	490	321	376	604	634
269	282	505	530	348	407	653	686
288	306	544	571	374	440	705	740
308	328	580	609	400	473	754	792
329	349	619	649	426	504	804	844
349	371	656	690	453	537	854	896

CASE FINISH (HUTCH)							
3 HIGH OVERALL							
1 HIGH STORAGE, FINISHED TOP, 40-1/2" (3HF)				1 HIGH STORAGE, INTEGRAL TOP, 41-5/8" (3HI)			
Journal Laminate	Flintwood	Veneer	Journal Laminate	Flintwood	Veneer	Journal Laminate	Flintwood
1417	2147	2255	1633	2473	2596	1685	2551
1456	2203	2315	1710	2590	2719	1753	2655
1473	2232	2343	1830	2773	2911	1911	2898
1496	2266	2381	1991	3014	3166	2073	3141
1553	2351	2468	1733	2626	2756		

4 HIGH OVERALL							
2 HIGH STORAGE, FINISHED TOP, 54" (4HF)				2 HIGH STORAGE, INTEGRAL TOP, 55-1/8" (4HI)			
Journal Laminate	Flintwood	Veneer	Journal Laminate	Flintwood	Veneer	Journal Laminate	Flintwood
1772	2683	2818	1985	3009	3159	2063	3122
1833	2777	2915	2098	3179	3339	2175	3297
1862	2823	2964	2288	3467	3639	2288	3467
1921	2909	3054	2406	3644	3825	2517	3814
2009	3046	3200	2635	3991	4192		
2106	3192	3352					
2197	3329	3496					
2294	3475	3650					

IF BACKBOARD IS SPECIFIED, ADD THE FOLLOWING:

Width	COM/						
	Gr. A	Gr. 1	Gr. 2	Gr. 3	Gr. 5	Gr. 6	Gr. 7
60" - 64"	71	83	96	110	161	181	202
66" - 96"	143	165	191	218	320	360	401

To determine overall price, add Door Finish price and Case Finish price together.

If Lock is specified, add 61

If Light is specified for 60" - 66", add 314

If Light is specified for 72" - 96", add 386