

WWGCW

Closed Overhead – Wood Doors

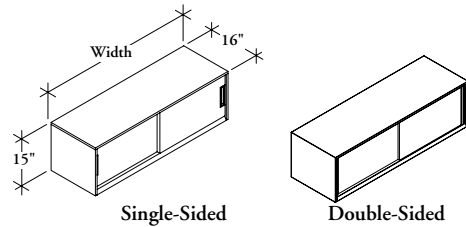

The Closed Overhead – Wood Doors mounts to the center Accessory Beam in a double-sided bench application providing secured overhead storage. It can also mount onto a Support Locker (WWGK) to provide storage and privacy in lateral applications.

WHAT'S INCLUDED

1 storage cabinet (single or double-sided).

NOTES

Please note that Spine Mounted Storage Stanchions (WWGT) or Lateral Mounted Storage Bracket (WWGB) must be specified separately.

If cabinet longer than 72" is desired in a spine application, two cabinets may be specified side-by-side (ex. for 78" (2"x39"), 84" (2"x42"), 90" (2"x45"), 96" (2"x48")).

If Double-Sided (D) is selected, orientation Left (L) or Right (R) must be chosen. Handedness is determined by the location of the door from the user's perspective.

Tackable Fabric back is not available on Double-Sided.

PRODUCT OPTIONS

Style	Height	Width	Orientation	Back Style
S Single-Sided with District Handle	15	30, 36, 39, 42, 45, 48, 54, 60, 66, 72	L Left R Right (Shown) N Not Applicable	M Metal W Whiteboard T Tackable Fabric
D Double-Sided with District Handle				
K Single-Sided with Interpret Handle				
L Double-Sided with Interpret Handle				

SAMPLE ORDER CODE

WWGCW S	15	60	N	W
----------------	-----------	-----------	----------	----------

PRODUCT OPTIONS CONTINUED

Case Finish	Secondary Color	Door Finish	Handle Finish	Key Option	Fabric Back Finish
Foundation	Foundation	Source Laminate	C All Match Case	K Key Alike R Key Random N No Key	NONE No Fabric Backstyle Panel Fabric
Mica	Mica	Flintwood	S Match Secondary Color		
Accent	Accent		E Exterior Match Case, Interior Match Secondary Color		
			I Interior Match Case, Exterior Match Secondary Color		

SAMPLE ORDER CODE

74	74	ZA	C	K	NONE
-----------	-----------	-----------	----------	----------	-------------

See pricing on following page.

W W G C W
Closed Overhead – Wood Doors
(Continued)

DIMENSIONS
INCHES / MM

PRICING

DIMENSIONS		SINGLE-SIDED WITH DISTRICT & INTERPRET HANDLE					
H	W	Foundation Case, Metal Front	Foundation Case, Source Laminate Front	Foundation Case, Flintwood Front	Mica/Accent Case, Metal Front	Mica/Accent Case, Source Laminate Front	Mica/Accent Case, Flintwood Front
15 / 381	30 / 762	789	1225	1313	814	1249	1337
15 / 381	36 / 914	821	1277	1367	849	1302	1394
15 / 381	39 / 991	855	1329	1422	881	1354	1449
15 / 381	42 / 1067	888	1379	1477	916	1406	1505
15 / 381	45 / 1143	920	1428	1529	949	1457	1557
15 / 381	48 / 1219	954	1482	1587	984	1510	1616
15 / 381	54 / 1372	986	1533	1642	1017	1563	1674
15 / 381	60 / 1524	1020	1584	1697	1051	1614	1729
15 / 381	66 / 1676	1052	1632	1749	1085	1664	1780
15 / 381	72 / 1829	1086	1685	1803	1120	1717	1836

DIMENSIONS		DOUBLE-SIDED WITH DISTRICT & INTERPRET HANDLE					
H	W	Foundation Case, Metal Front	Foundation Case, Source Laminate Front	Foundation Case, Flintwood Front	Mica/Accent Case, Metal Front	Mica/Accent Case, Source Laminate Front	Mica/Accent Case, Flintwood Front
15 / 381	30 / 762	869	1361	1459	894	1387	1486
15 / 381	36 / 914	905	1418	1520	932	1446	1549
15 / 381	39 / 991	941	1476	1584	971	1506	1612
15 / 381	42 / 1067	977	1533	1643	1008	1563	1675
15 / 381	45 / 1143	1013	1588	1702	1045	1618	1733
15 / 381	48 / 1219	1050	1646	1764	1083	1678	1798
15 / 381	54 / 1372	1086	1701	1825	1120	1734	1858
15 / 381	60 / 1524	1122	1758	1884	1156	1794	1920
15 / 381	66 / 1676	1157	1813	1945	1193	1849	1980
15 / 381	72 / 1829	1194	1873	2007	1231	1908	2045

If Whiteboard (W) Back is specified, add 63

If Single-Sided Tackable Fabric (T) Back is specified, add:

	COM	Gr. A	Gr. 1	Gr. 2	Gr. 3	Gr. 4	Gr. 5	Gr. 6	Gr. 7
30"	132	134	136	139	141	144	149	151	153
36"	150	152	155	159	163	167	171	175	178
39"	167	171	175	178	182	186	190	193	199
42"	184	187	191	196	201	206	209	212	215
45"	203	206	209	212	215	222	228	233	237
48"	217	225	229	234	238	244	251	255	260
54"	237	242	248	252	257	263	271	275	279
60"	254	259	264	271	275	280	287	294	301
66"	273	277	281	287	294	302	309	314	321
72"	280	286	293	299	306	313	320	327	332