

## W W G C M

### Closed Overhead – Metal Doors

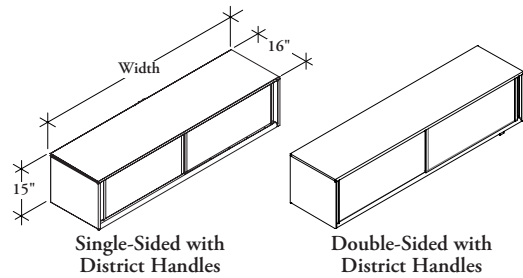

The Closed Overhead – Metal Doors mounts to the center Accessory Beam in a double-sided bench application providing secured overhead storage. It can also mount onto a Support Locker (WWGK) to provide storage and privacy in lateral applications.

#### WHAT'S INCLUDED

1 storage cabinet (single or double-sided).

#### NOTES

Please note that Spine Mounted Storage Stanchions (WWGT) or Lateral Mounted Storage Bracket (WWGB) must be specified separately.

If cabinet longer than 72" is desired in a spine application, two cabinets may be specified side-by-side (ex. for 78" (2"x39"), 84" (2"x42"), 90" (2"x45"), 96" (2"x48")).

If Double-Sided (D) is selected, orientation Left (L) or Right (R) must be chosen. Handedness is determined by the location of the door from the user's perspective.

Tackable Fabric back is not available on Double-Sided.

#### PRODUCT OPTIONS

Style	Height	Width	Orientation	Back Style
<b>S</b> Single-Sided with District Handle	15	30, 36, 39, 42, 45, 48, 54, 60, 66, 72	<b>L</b> Left <b>R</b> Right (Shown) <b>N</b> Not Applicable	<b>M</b> Metal <b>W</b> Whiteboard <b>T</b> Tackable Fabric
<b>D</b> Double-Sided with District Handle				
<b>K</b> Single-Sided with Interpret Handle				
<b>L</b> Double-Sided with Interpret Handle				

#### SAMPLE ORDER CODE

<b>WWGCM S</b>	<b>15</b>	<b>60</b>	<b>N</b>	<b>W</b>
----------------	-----------	-----------	----------	----------

#### PRODUCT OPTIONS CONTINUED

Case Finish	Door Finish	Handle Finish	Key Option	Fabric Back Finish
Foundation	Foundation	<b>C</b> All Match Case	<b>K</b> Key Alike <b>R</b> Key Random <b>N</b> No Key	<b>NONE</b> No Fabric Backstyle Panel Fabric
Mica	Mica	<b>D</b> All Match Door		
Accent	Accent	<b>E</b> Exterior Match Case, Interior Match Door <b>I</b> Interior Match Case, Exterior Match Door		

#### SAMPLE ORDER CODE

<b>74</b>	<b>90</b>	<b>C</b>	<b>K</b>	<b>NONE</b>
-----------	-----------	----------	----------	-------------

See pricing on following page.

**W W G C M**  
**Closed Overhead – Metal Doors**  
**(Continued)**

DIMENSIONS INCHES / MM		PRICING	
H	W	SINGLE-SIDED (S)	
		Foundation	Mica/Accent
15 / 381	30 / 762	1429	1472
15 / 381	36 / 914	1488	1534
15 / 381	39 / 991	1547	1596
15 / 381	42 / 1067	1609	1658
15 / 381	45 / 1143	1666	1717
15 / 381	48 / 1219	1726	1779
15 / 381	54 / 1372	1786	1840
15 / 381	60 / 1524	1846	1902
15 / 381	66 / 1676	1902	1963
15 / 381	72 / 1829	1964	2024

DIMENSIONS INCHES / MM		PRICING	
H	W	DOUBLE-SIDED (D)	
		Foundation	Mica/Accent
15 / 381	30 / 762	1569	1618
15 / 381	36 / 914	1639	1689
15 / 381	39 / 991	1705	1756
15 / 381	42 / 1067	1768	1821
15 / 381	45 / 1143	1834	1890
15 / 381	48 / 1219	1898	1959
15 / 381	54 / 1372	1964	2024
15 / 381	60 / 1524	2028	2093
15 / 381	66 / 1676	2094	2160
15 / 381	72 / 1829	2162	2227

If Whiteboard (W) Back is specified, add 77

If Tackable Fabric Back (T) is specified, add;

	COM	Gr. A	Gr. 1	Gr. 2	Gr. 3	Gr. 4	Gr. 5	Gr. 6	Gr. 7
30"	157	159	165	168	171	174	177	180	182
36"	179	181	184	190	197	202	205	209	212
39"	202	205	209	212	217	225	230	233	238
42"	222	226	231	235	240	246	253	256	260
45"	242	246	253	256	260	266	273	281	287
48"	262	269	274	283	288	293	300	305	314
54"	287	292	297	302	309	318	325	329	334
60"	304	313	319	325	329	336	347	354	361
66"	327	332	338	347	354	362	374	379	385
72"	336	346	353	358	369	378	384	392	401