

The Split Base Feed delivers power from the floor to the underside of the worksurface. It is wired to the building power supply in two places for New York city wiring restrictions.

#### WHAT'S INCLUDED

1 base feed harness, junction box, I-connector, mounting hardware

#### NOTES

Can be directly connected to the Power Module (WWEPM) when I-Connector (WWEIC) is removed.

## W W E B F S Split Base Feed

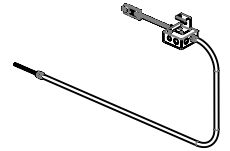

#### PRODUCT OPTIONS

Mounting Style	Wire System	Length	Country of Installation	PVC Free Option
<b>S</b> For Mounting on a Single-Sided Frame	<b>8T</b> 8-Wire Isolated Ground	18, 72	<b>A</b> Canada/USA	<b>~</b> Standard
<b>D</b> For Mounting on a Double-Sided Frame	<b>8K</b> 8-Wire Dual Isolated			<b>V</b> PVC Free
	<b>7T</b> 7-Wire Non Isolated Ground			
	<b>7K</b> 7-Wire Dual Non Isolated			

#### SAMPLE ORDER CODE

<b>WWEBFS S</b>	<b>8K</b>	<b>72</b>	<b>A</b>	<b>V</b>
-----------------	-----------	-----------	----------	----------

#### DIMENSIONS

L
18 / 457
72 / 1829

#### PRICING

##### MOUNTING ON A SINGLE FRAME (S) & DOUBLE-SIDED FRAME (D)

##### 8-WIRE ISOLATED GROUND (8T) & 7-WIRE NON ISOLATED GROUND (7T)

Standard	PVC Free
429	473
495	545

##### 8-WIRE DUAL ISOLATED (8K) & 7-WIRE DUAL NON ISOLATED (7K)

Standard	PVC Free
548	603
628	691