

Three-High Storage Cabinets

Pre-configured Storage Cabinets provide enclosed storage in heights to match Lateral Files.

WHAT'S INCLUDED

1 cabinet case, 2 doors, 2 shelves, hardware, lock and keys.

NOTES

Not all configurations are available as Xpress. Please see Xpress catalogue and/or specification software for details.

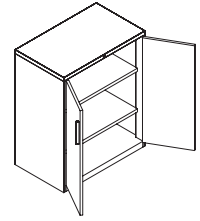

PRODUCT OPTIONS

Height	Depth	Width	Front Finish Style	Pull Style	Case & Metal Front Finish	Non-Metal Front Finish	Key Style
L Letter (36.8")	18, 20	30, 36, 42	D0 Seamless	A Full Pull (metal front)	Foundation	Seamless Colors	K Keyed Alike
C Combo (40")			D1 Metal	B Rectangular Handle Pull	Mica Accent	Flintwood	R Keyed Randomly
B Binder (41.6")			D District Handle Pull (non-metal)				

SAMPLE ORDER CODE

LSC31 C	20	36	D1	A	74	R
----------------	-----------	-----------	-----------	----------	-----------	----------

DIMENSIONS INCHES / MM

D	W
18 / 457	30 / 762
18 / 457	36 / 914
18 / 457	42 / 1067
20 / 508	30 / 762
20 / 508	36 / 914
20 / 508	42 / 1067
18 / 457	30 / 762
18 / 457	36 / 914
18 / 457	42 / 1067
20 / 508	30 / 762
20 / 508	36 / 914
20 / 508	42 / 1067
18 / 457	30 / 762
18 / 457	36 / 914
18 / 457	42 / 1067
20 / 508	30 / 762
20 / 508	36 / 914
20 / 508	42 / 1067

PRICING

METAL FRONT	
Foundation	Mica/Accent
LETTER HEIGHT Xpress	
1041	1214
1117	1293
1177	1370
1041	1214
1117	1293
1177	1370
COMBO HEIGHT Xpress	
1080	1258
1154	1339
1215	1411
1080	1258
1154	1339
1215	1411
BINDER HEIGHT	
1100	1293
1174	1360
1236	1433
1100	1293
1174	1360
1236	1433

SEAMLESS FRONT	
Foundation	Mica/Accent
LETTER HEIGHT	
1517	1688
1664	1841
1734	1930
n/a	n/a
n/a	n/a
n/a	n/a
COMBO HEIGHT	
1562	1735
1708	1895
1780	1976
n/a	n/a
n/a	n/a
n/a	n/a
BINDER HEIGHT	
1579	1777
1729	1913
1802	2001
n/a	n/a
n/a	n/a
n/a	n/a

FLINTWOOD FRONT	
Foundation	Mica/Accent
LETTER HEIGHT	
1757	1801
1876	1920
1980	2034
n/a	n/a
n/a	n/a
n/a	n/a
COMBO HEIGHT	
1831	1868
1945	1994
2054	2104
n/a	n/a
n/a	n/a
n/a	n/a
BINDER HEIGHT	
1866	1935
1984	2031
2091	2138
n/a	n/a
n/a	n/a
n/a	n/a

If Rectangular Handle Pull (B) is specified on a Metal Front (D1), add 45