

ledger – storage cabinets

Xpress

LSC21

Two-High Storage Cabinets

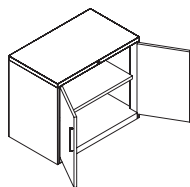

Pre-configured Storage Cabinets provide enclosed storage in heights to match Lateral Files.

WHAT'S INCLUDED

1 cabinet case, 2 doors, 1 shelf, hardware, lock and keys.

NOTES

Not all configurations are available as Xpress. Please see Xpress catalogue and/or specification software for details.

Full Pull style is finished to match drawer front. Rectangular and District Handle Pull styles will default to Platinum.

PRODUCT OPTIONS

Height	Depth	Width	Front Finish Style	Pull Style	Case & Metal Front Finish	Non-Metal Front Finish	Key Style
L Letter (25.6")	18, 20	30, 36, 42	D0 Seamless	A Full Pull (metal front)	Foundation	Seamless Colors Flintwood	K Keyed Alike R Keyed Randomly
C Combo (27.2")			D1 Metal	B Rectangular Handle Pull	Mica		
B Binder (28.8")				D District Handle Pull (non-metal)	Accent		

SAMPLE ORDER CODE

LSC21 L	18	30	D1	A	74		K
---------	----	----	----	---	----	--	---

DIMENSIONS INCHES / MM

D	W
18 / 457	30 / 762
18 / 457	36 / 914
18 / 457	42 / 1067
20 / 508	30 / 762
20 / 508	36 / 914
20 / 508	42 / 1067
18 / 457	30 / 762
18 / 457	36 / 914
18 / 457	42 / 1067
20 / 508	30 / 762
20 / 508	36 / 914
20 / 508	42 / 1067
18 / 457	30 / 762
18 / 457	36 / 914
18 / 457	42 / 1067
20 / 508	30 / 762
20 / 508	36 / 914
20 / 508	42 / 1067

PRICING

METAL FRONT

	Foundation	Mica/Accent
LETTER HEIGHT Xpress		
	832	971
	894	1034
	950	1101
	832	971
	894	1034
	950	1101
COMBO HEIGHT Xpress		
	852	989
	913	1059
	971	1125
	852	989
	913	1059
	971	1125
BINDER HEIGHT		
	872	1011
	930	1082
	987	1164
	872	1011
	930	1082
	987	1164

SEAMLESS FRONT

	Foundation	Mica/Accent
LETTER HEIGHT		
	1232	1368
	1342	1485
	1440	1591
	n/a	n/a
	n/a	n/a
	n/a	n/a
COMBO HEIGHT		
	1253	1393
	1396	1542
	1462	1616
	n/a	n/a
	n/a	n/a
	n/a	n/a
BINDER HEIGHT		
	1277	1416
	1417	1565
	1483	1658
	n/a	n/a
	n/a	n/a
	n/a	n/a

FLINTWOOD FRONT

	Foundation	Mica/Accent
LETTER HEIGHT		
	1431	1475
	1535	1578
	1633	1681
	n/a	n/a
	n/a	n/a
	n/a	n/a
COMBO HEIGHT		
	1468	1510
	1573	1612
	1668	1719
	n/a	n/a
	n/a	n/a
	n/a	n/a
BINDER HEIGHT		
	1507	1550
	1609	1654
	1706	1782
	n/a	n/a
	n/a	n/a
	n/a	n/a

If Rectangular Handle Pull (B) is specified on a Metal Front (D1), add 51