

# mounted storage & accessories

**Xpress**

## RSBSO

### Sit-On Cabinet – Open with Sliding Door

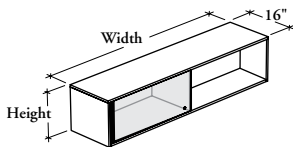

This cabinet provides a convenient semi-closed storage space above the worksurface. Its back accessory function can be specified.

#### WHAT'S INCLUDED

1 sit-on cabinet, 1 back accessory (as specified), 1 sliding door, 1 sliding door pull, 1 divider, lock and keys (if specified).

#### WHAT'S EXCLUDED

Desk-Mounted Shelf.

#### NOTES

Can be mounted directly on Modular or Spine Desks or on the Desk-Mounted Shelf (RSBMS).

Frosted (FT) is a single-sided etched tempered glass which is facing inward of cabinet.

**Xpress** Not all configurations are available as Xpress. Please see Xpress catalogue and/or specification software for details.

#### PRODUCT OPTIONS

Configuration (Door Side)	Accessory Option	Height	Depth	Width	Laminate Case and Divider Finish	Door Style	Door Finish	Pull Finish	Accessory Finish (If applicable)	Key Style
<b>L</b> Left (Shown)	<b>F</b> Fabric Tackboard	<b>D</b> 13" Desk-Mounted	16	30, 36, 42, 48, 54, 60, 66, 72, 78, 84	Source Laminate	<b>F</b> Flintwood	Flintwood	Foundation	Source Laminate	<b>K</b> Keyed Alike
<b>R</b> Right	<b>L</b> Laminate <b>W</b> Whiteboard	<b>S</b> 15" Shelf-Mounted				<b>G</b> Glass <b>L</b> Laminate	<b>Standard Glass:</b> <b>CL</b> Clear <b>FT</b> Frosted <b>Back-Painted Glass</b> Source Laminate	Mica	Panel Fabric	<b>R</b> Keyed Randomly <b>N</b> No lock

#### SAMPLE ORDER CODE

<b>RSBSO</b>	<b>L</b>	<b>W</b>	<b>S</b>	<b>16</b>	<b>72</b>	<b>XS</b>	<b>G</b>	<b>FT</b>	<b>E</b>	<b>R</b>
--------------	----------	----------	----------	-----------	-----------	-----------	----------	-----------	----------	----------

#### DIMENSIONS INCHES / MM

D	W
16 / 406	30 / 762
16 / 406	36 / 914
16 / 406	42 / 1067
16 / 406	48 / 1219
16 / 406	54 / 1372
16 / 406	60 / 1524
16 / 406	66 / 1676
16 / 406	72 / 1829
16 / 406	78 / 1981
16 / 406	84 / 2134

#### PRICING

FABRIC TACKBOARD (F)										LAMINATE (L)		WHITEBOARD (W)	
A/COM	Gr. 1	Gr. 2	Gr. 3	Gr. 4	Gr. 5	Gr. 6	Gr. 7	Source Laminate		Source Laminate		Source Laminate	
LAMINATE DOORS (L) (Source Laminate)													
693	697	708	718	738	758	769	784	616				990	
766	774	783	790	811	826	842	854	674				1083	
844	849	859	870	889	910	925	941	741				1206	
910	917	931	944	967	992	1009	1026	802				1440	
983	991	1009	1018	1047	1074	1094	1112	867				1580	
1062	1074	1085	1101	1127	1155	1176	1197	929				1676	
1136	1144	1162	1175	1206	1236	1258	1279	992				1775	
1202	1212	1228	1245	1275	1308	1333	1357	1051				1876	
1273	1287	1306	1322	1356	1391	1417	1440	1116				1975	
1346	1359	1377	1393	1426	1460	1487	1513	1177				2108	

Pricing is continued on the following page.

## RSBSO Sit-On Cabinet – Open with Sliding Door (Continued)

**DIMENSIONS  
INCHES / MM**

D	W
16 / 406	30 / 762
16 / 406	36 / 914
16 / 406	42 / 1067
16 / 406	48 / 1219
16 / 406	54 / 1372
16 / 406	60 / 1524
16 / 406	66 / 1676
16 / 406	72 / 1829
16 / 406	78 / 1981
16 / 406	84 / 2134

16 / 406	30 / 762
16 / 406	36 / 914
16 / 406	42 / 1067
16 / 406	48 / 1219
16 / 406	54 / 1372
16 / 406	60 / 1524
16 / 406	66 / 1676
16 / 406	72 / 1829
16 / 406	78 / 1981
16 / 406	84 / 2134

16 / 406	30 / 762
16 / 406	36 / 914
16 / 406	42 / 1067
16 / 406	48 / 1219
16 / 406	54 / 1372
16 / 406	60 / 1524
16 / 406	66 / 1676
16 / 406	72 / 1829
16 / 406	78 / 1981
16 / 406	84 / 2134

**PRICING**

FABRIC TACKBOARD (F)								LAMINATE (L)	WHITEBOARD (W)
A/COM	Gr. 1	Gr. 2	Gr. 3	Gr. 4	Gr. 5	Gr. 6	Gr. 7	Source Laminate	
<b>GLASS DOORS (G) (Clear (CL))</b>									
720	724	735	745	765	785	796	811	643	1015
788	796	805	812	833	848	864	876	696	1107
861	866	876	887	906	927	942	958	758	1221
922	929	943	956	979	1004	1021	1038	814	1451
987	995	1013	1022	1051	1078	1098	1116	871	1583
1063	1075	1086	1102	1128	1156	1177	1198	930	1678
1137	1145	1163	1176	1207	1237	1259	1280	993	1777
1215	1225	1241	1258	1288	1321	1346	1370	1064	1884
1289	1303	1322	1338	1372	1407	1433	1456	1132	1992
1369	1382	1400	1416	1449	1483	1510	1536	1200	2130
<b>GLASS DOORS (G) (Frosted (FT)/Back-Painted)</b>									
779	783	794	804	824	844	855	870	702	1076
848	856	865	872	893	908	924	936	756	1166
921	926	936	947	966	987	1002	1018	818	1282
982	989	1003	1016	1039	1064	1081	1098	874	1512
1048	1056	1074	1083	1112	1139	1159	1177	932	1644
1125	1137	1148	1164	1190	1218	1239	1260	992	1737
1195	1203	1221	1234	1265	1295	1317	1338	1051	1836
1272	1282	1298	1315	1345	1378	1403	1427	1121	1945
1349	1363	1382	1398	1432	1467	1493	1516	1192	2050
1429	1442	1460	1476	1509	1543	1570	1596	1260	2193
<b>FLINTWOOD DOORS (F) (Flintwood)</b>									
845	849	860	870	890	910	921	936	768	1144
952	960	969	976	997	1012	1028	1040	860	1271
1059	1064	1074	1085	1104	1125	1140	1156	956	1422
1155	1162	1176	1189	1212	1237	1254	1271	1047	1685
1259	1267	1285	1294	1323	1350	1370	1388	1143	1853
1367	1379	1390	1406	1432	1460	1481	1502	1234	1982
1474	1482	1500	1513	1544	1574	1596	1617	1330	2115
1577	1587	1603	1620	1650	1683	1708	1732	1426	2251
1678	1692	1711	1727	1761	1796	1822	1845	1521	2379
1771	1784	1802	1818	1851	1885	1912	1938	1602	2536