

This cabinet is a metal mounted storage unit that provides above worksurface storage capabilities.

WHAT'S INCLUDED

1 overhead cabinet, column- or wall-mounting supports, pulls, lock and keys, and components as listed below:

	Widths	
	24" to 48"	54" to 84"
Door	1	2
Divider	n/a	1

WHAT'S EXCLUDED

Structural Columns.

NOTES

This cabinet is shipped knocked down.

This cabinet has a 21 1/2" clearance between the top of the desk to the bottom of the cabinet.

Specify the width according to the width of the desk over which the overhead cabinet is mounted. Column-Mounted Overhead Cabinet width is actually 2.5" less.

Soft Touch (2) and Standard T/O/S (4) pulls are only available in limited Foundation colors. Refer to the specification software for details.

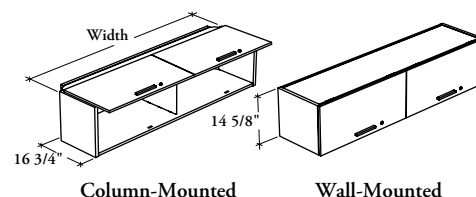

PRODUCT OPTIONS

Mounted Style	Depth	Width	Door Finish	Case Finish	Pull Style	Pull Finish	Key Style	Motion Control Mechanism
C Column-Mounted	16	24, 30, 36, 42, 48, 54, 60, 66, 72, 78, 84	Foundation Mica	Foundation Mica	1 Standard Expansion 2 Soft Touch 4 Standard T/O/S 6 Arched 7 Elliptical 9 Rectilinear	Foundation Accent Mica	K Keyed Alike R Keyed Randomly N No Lock	2 With Motion Control Mechanism
W Wall-Mounted								

SAMPLE ORDER CODE

ROCML W	16	24	E	E	9	K	N	2
----------------	-----------	-----------	----------	----------	----------	----------	----------	----------

DIMENSIONS INCHES / MM

D	W
16 / 406	24 / 610
16 / 406	30 / 762
16 / 406	36 / 914
16 / 406	42 / 1067
16 / 406	48 / 1219
16 / 406	54 / 1372
16 / 406	60 / 1524
16 / 406	66 / 1676
16 / 406	72 / 1829
16 / 406	78 / 1981
16 / 406	84 / 2134

PRICING

DOOR FINISH	
Foundation	Mica
1063	1090
1104	1127
1181	1208
1282	1304
1328	1353
1379	1404
1422	1447
1482	1513
1540	1570
1618	1649
1696	1728

If Mica case is specified, add 143.

If Motion Control Mechanism is specified, add 241 (24" – 48" widths).
add 482 (54" – 84" widths).