

freestanding storage & accessories

Xpress

R B C G

Half Wardrobe Unit with Drawers – Glass Door

The Half Wardrobe Unit provides a lockable storage area to store garments and other items combined with the filing capabilities of a pedestal (letter- and legal-size paper).

WHAT'S INCLUDED

1 half wardrobe unit, 1 coat rod, pulls, levelers, lock and keys, and accessories listed below:

	Drawer Configurations		Heights		
	6612	1212	51"	66" or 72"	
Pencil Tray	1	n/a	Shelf	1	2
Drawer Divider	1	n/a			
12" Hanging File Bar	1	2			

WHAT'S EXCLUDED

Top for Solid Storage Cabinet and Hang-On Kit.

NOTES

Top on 51" height overlaps side and back panels for a cleaner look and to fit with Elevated Desktop Cabinets.

Holes at 1 1/4" intervals on the inside walls of side panels of the top section allow for shelf adjustment.

The Half Wardrobe Unit is handed and must be specified left or right. The handed end is determined by the location of the drawers.

Width of drawers is fixed. Only the wardrobe width varies.

Hanging file bars are included along the width only.

Frosted (FT) is a single-sided etched tempered glass which is facing inward of storage.

Soft Touch (2) and Standard T/O/S (4) pulls are only available in limited Foundation colors. Refer to the specification software for details.

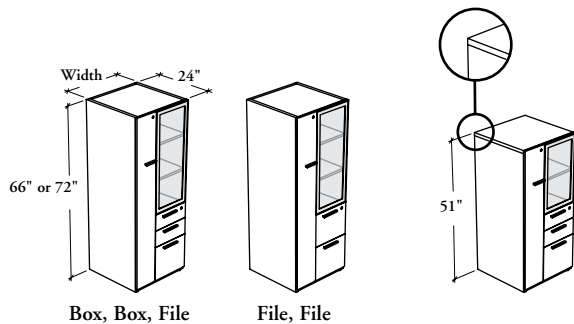

Xpress Not all glass door finishes are available as Xpress, Please see Xpress catalogue and/or specification software for details.

PRODUCT OPTIONS

Configuration	Depth	Configuration	Drawer Front and Door Finish	Door Frame Finish	Glass Door Finish	Pull Style	Pull Finish	Key Style	Glass Door Lock
B Box, Box, File	24	L Left	Source Laminate	Foundation	Standard Glass: CL Clear	1 Standard Expansion	Foundation	K Keyed Alike	0 No
	Width		Foundation Laminate	Accent					
F File, File	24, 30, 36	R Right (Shown)	Flintwood	Mica	FT Frosted	4 Standard T/O/S	Mica		1 Yes
	Height		Edge Trim Finish	AC Clear Anodized	Back-Painted Glass				
	51, 66, 72		Edge Trim Colors			7 Elliptical			
			Case Finish			9 Rectilinear			
			Source Laminate						

SAMPLE ORDER CODE

RBCG														
F	24	36	72	R	FX	XG	AC	FT	9	E	R	1		

DIMENSIONS INCHES / MM

D	W	H
24 / 610	24 / 610	51 / 1295
24 / 610	24 / 610	66 / 1676
24 / 610	24 / 610	72 / 1829
24 / 610	30 / 762	51 / 51
24 / 610	30 / 762	66 / 1676
24 / 610	30 / 762	72 / 1829
24 / 610	36 / 914	51 / 51
24 / 610	36 / 914	66 / 1676
24 / 610	36 / 914	72 / 1829

PRICING

FILE, FILE (F)			FROSTED GLASS DOOR (FT)/ BACK-PAINTED GLASS DOOR		
CLEAR GLASS DOOR (CL)					
Source Laminate	Foundation Laminate	Flintwood	Source Laminate	Foundation Laminate	Flintwood
2335	2532	4233	2439	2636	4337
2777	2972	4671	2914	3109	4808
2901	3110	4872	3068	3277	5039
2618	2868	4811	2722	2972	4915
3061	3311	5250	3198	3448	5387
3195	3465	5475	3362	3632	5642
2816	3098	5271	2920	3202	5375
3365	3651	5821	3502	3788	5958
3508	3822	6078	3675	3989	6245

GLASS DOOR LOCK (1)
55
55
55
55
55
55
55
55
55
55
55

R B C G

Half Wardrobe Unit with Drawers –
Glass Door (Continued)

DIMENSIONS
INCHES / MM

D	W	H
24 / 610	24 / 610	51 / 1295
24 / 610	24 / 610	66 / 1676
24 / 610	24 / 610	72 / 1829
24 / 610	30 / 762	51 / 1295
24 / 610	30 / 762	66 / 1676
24 / 610	30 / 762	72 / 1829
24 / 610	36 / 914	51 / 1295
24 / 610	36 / 914	66 / 1676
24 / 610	36 / 914	72 / 1829

PRICING

BOX,BOX, FILE (F)					
CLEAR GLASS DOOR (CL)			FROSTED GLASS DOOR (FT)/ BACK-PAINTED GLASS DOOR		
Source Laminate	Foundation Laminate	Flintwood	Source Laminate	Foundation Laminate	Flintwood
2376	2574	4271	2480	2678	4375
2815	3008	4733	2952	3145	4870
2942	3141	4930	3109	3308	5097
2660	2906	4848	2764	3010	4952
3098	3344	5305	3235	3481	5442
3232	3496	5536	3399	3663	5703
2856	3138	5310	2960	3242	5414
3406	3682	5873	3543	3819	6010
3545	3851	6134	3712	4018	6301

GLASS DOOR
LOCK (I)

55
55
55
55
55
55
55
55
55