

ez suspended storage

J Z B F F

EZ Suspended Credenza – Lateral File – Single-Sided

This suspended credenza must be installed on-module under a EZ Fence Beam to provide high density filling and organized storage on a single-sided application.

WHAT'S INCLUDED

1 ez suspended credenza, 2 drawers, mounting hardware, lock and keys (as specified) and accessories as listed below:

Widths	
48" or 54"	60" to 72"

15" Hanging File Bar 1 2 per drawer

WHAT'S EXCLUDED

EZ Fence Beam, Chicago EZ Fence Beam and File Drawer Organizer.

NOTES

When Front Style (M or N) is specified, only Metal Front Finish is available.

When Front Style (S or T) is specified, only Laminate Front Finish is available.

When Front Style (M or S) is specified, Pull Style and Pull and Bag Holder Finish are **not** available.

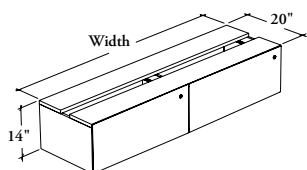

PRODUCT OPTIONS

Front Style	EZ Fence Leg Style	Case Height	Depth	Width	Front Finish
M Metal N Metal with Pull S Solid T Solid with Pull	A Angled	14	20	48, 54, 60, 66, 72	Metal Front: Foundation Accent Mica Laminate Front: Source Laminate Foundation Laminate

SAMPLE ORDER CODE

JZBFF S	A	14	20	72	3D
----------------	----------	-----------	-----------	-----------	-----------

PRODUCT OPTIONS CONTINUED

Edge Trim Finish (Laminate Front Only)	Case Finish	Pull Style (If Applicable)	Pull Finish (If Applicable)	Leg Mounting Hardware Finish	Key Style
Edge Trim Colors	Source Laminate	C Cityline Recessed	Foundation Mica Accent	Foundation Mica Accent	K Keyed Alike R Keyed Randomly N No Lock

SAMPLE ORDER CODE CONTINUED

4D	3D			60	R
-----------	-----------	--	--	-----------	----------

See Pricing on the following page.

J Z B F F
EZ Suspended Credenza – Lateral
File – Single-Sided (Continued)

DIMENSIONS
INCHES / MM

H	D	W
14 / 356	20 / 508	48 / 1219
14 / 356	20 / 508	54 / 1372
14 / 356	20 / 508	60 / 1524
14 / 356	20 / 508	66 / 1676
14 / 356	20 / 508	72 / 1829

PRICING

METAL FRONT (M) or METAL FRONT WITH PULL (N)

2279
2311
2342
2373
2405

SOLID FRONT (S) or SOLID FRONT WITH PULL (T)

Source Laminate	Foundation Laminate
2279	2359
2311	2400
2342	2442
2373	2482
2405	2524