

freestanding storage

JNFTWF

Freestanding Tower with Drawers and Wardrobe – Front Access

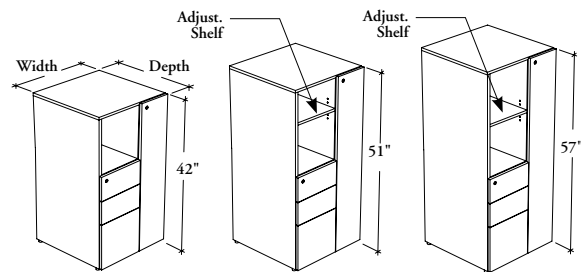

Front Access, Open Style,
Box, Box, File or File, File

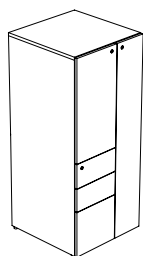

Front Access,
Door Style,
Box, Box, File or
File, File

These freestanding towers provide storage area to store garments and other items and combine the filing capabilities of a pedestal.

WHAT'S INCLUDED

1 freestanding tower with half wardrobe, levelers, 1 coat hook (if 18" depth) or 1 coat rod (if 24" or 30" depth), locks and keys (if specified), and accessories as listed below:

	Height		
	42"	51"	57"
Compartment (Front Access)	1	2	2
Adjust. Shelf	n/a	1	1
Adjust. Shelf (Inside Wardrobe)	1	1	1
Drawer Configuration			
	B	F	
Pencil Drawer	1	n/a	
Drawer Divider	1	n/a	
12" Hang. File Bar	1	2	

WHAT'S EXCLUDED

Box Drawer Organizer, File Drawer Organizer and Hang-On Kit.

NOTES

Holes at 1 1/4" intervals on the inside walls of side panels of the top section and wardrobe allow for shelf adjustment.

Depth and width of drawers is fixed.

Included hanging file bars are to be installed along the width only.

This storage unit has a central locking system.

PRODUCT OPTIONS

Front Style	Style	Drawer Configuration	Depth	Width	Height	Orientation	Front Finish	Edge Trim Finish (Laminate Front Only)	Case Finish	Key Style
S Solid	D Door O Open	B Box, Box, File (Shown) F File, File	18, 24, 30	24, 30	42, 51, 57	L Full Door on Left R Full Door on Right (Shown)	Source Laminate Foundation Laminate	Edge Trim Colors	Source Laminate	K Keyed Alike R Keyed Randomly N No Lock

SAMPLE ORDER CODE

JNFTWF	O	B	18	24	42	L	XG	SS	XG	N
S										

DIMENSIONS INCHES / MM

D	W	H
18 / 457	24 / 610	42 / 1067
18 / 457	24 / 610	51 / 1295
18 / 457	24 / 610	57 / 1448
18 / 457	30 / 762	42 / 1067
18 / 457	30 / 762	51 / 1295
18 / 457	30 / 762	57 / 1448
24 / 610	24 / 610	42 / 1067
24 / 610	24 / 610	51 / 1295
24 / 610	24 / 610	57 / 1448

PRICING

OPEN (O)	
FILE, FILE (F)	BOX, BOX, FILE (B)
Source Laminate	Source Laminate
Foundation Laminate	Foundation Laminate
1404	1456
1521	1571
1596	1647
1506	1559
1623	1673
1688	1738
1496	1547
1609	1661
1688	1738
1480	1530
1612	1664
1698	1749
1601	1652
1737	1789
1814	1865
1570	1622
1700	1752
1790	1840

Pricing is continued on the following page.

J N F T W F

Freestanding Tower with Drawers and Wardrobe – Front Access (Continued)

DIMENSIONS
INCHES / MM

D	W	H
24 / 610	30 / 762	42 / 1067
24 / 610	30 / 762	51 / 1295
24 / 610	30 / 762	57 / 1448
30 / 762	24 / 610	42 / 1067
30 / 762	24 / 610	51 / 1295
30 / 762	24 / 610	57 / 1448
30 / 762	30 / 762	42 / 1067
30 / 762	30 / 762	51 / 1295
30 / 762	30 / 762	57 / 1448

18 / 457	24 / 610	42 / 1067
18 / 457	24 / 610	51 / 1295
18 / 457	24 / 610	57 / 1448

18 / 457	30 / 762	42 / 1067
18 / 457	30 / 762	51 / 1295
18 / 457	30 / 762	57 / 1448

24 / 610	24 / 610	42 / 1067
24 / 610	24 / 610	51 / 1295
24 / 610	24 / 610	57 / 1448

24 / 610	30 / 762	42 / 1067
24 / 610	30 / 762	51 / 1295
24 / 610	30 / 762	57 / 1448

30 / 762	24 / 610	42 / 1067
30 / 762	24 / 610	51 / 1295
30 / 762	24 / 610	57 / 1448

30 / 762	30 / 762	42 / 1067
30 / 762	30 / 762	51 / 1295
30 / 762	30 / 762	57 / 1448

PRICING

OPEN (O) (CONTINUED)			
FILE, FILE (F)		BOX, BOX, FILE (B)	
	Source Laminate	Foundation Laminate	
	1596	1691	1647
	1712	1825	1763
	1758	1884	1809
	1585	1660	1636
	1698	1791	1749
	1775	1879	1826
	1688	1781	1738
	1800	1915	1853
	1893	2019	1943

DOOR (D)			
	1464	1565	1517
	1579	1700	1630
	1655	1792	1708
	1593	1718	1643
	1708	1860	1759
	1785	1956	1836
	1560	1660	1611
	1679	1801	1733
	1752	1888	1802
	1689	1813	1739
	1802	1957	1856
	1880	2050	1931
	1663	1762	1713
	1783	1905	1835
	1856	1990	1906
	1791	1915	1841
	1906	2059	1958
	1974	2145	2027