

# freestanding storage

## JNFTTS

### Freestanding Tower with Two Full Solid Doors

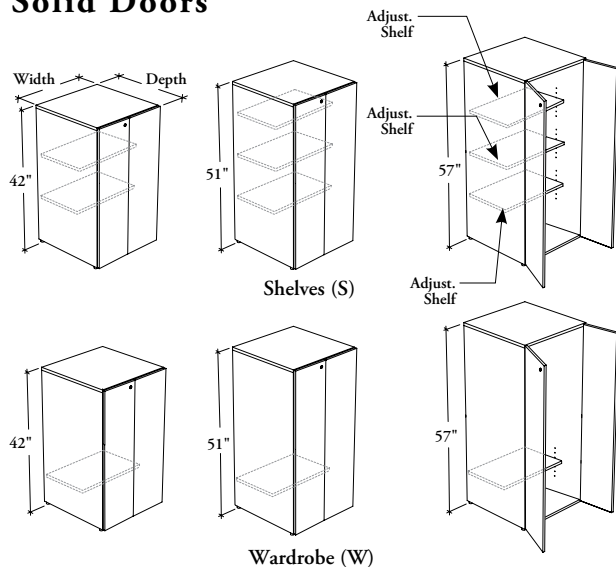

These freestanding towers provide a storage space for garments and other items.

#### WHAT'S INCLUDED

1 freestanding tower, levelers, 1 coat rod (wardrobe only), locks and keys (if specified), and accessories as listed below:

	Interior Configuration					
	S			W		
Heights	42"	51"	57"	42"	51"	57"
Adjust. Shelf	2	3	3	1	1	1

#### WHAT'S EXCLUDED

Hang-On Kit.

#### NOTES

Can be used freestanding or connected to a worksurface with Hang-On Kit.

Holes at 1 1/4" intervals on the inside walls of side panels allow for shelf adjustment.

Depth 18" is **not** available when Wardrobe (W) is specified.

#### PRODUCT OPTIONS

Front Style	Interior Configuration	Depth	Width	Height	Door Front Finish	Edge Trim Finish	Case Finish	Key Style
S Solid	S Shelves	18, 24, 30	24, 30, 36	42, 51, 57	Source Laminate Foundation Laminate	Edge Trim Colors	Source Laminate	<b>K</b> Keyed Alike <b>R</b> Keyed Randomly <b>N</b> No Lock
	W Wardrobe							

#### SAMPLE ORDER CODE

JNFTTS S	S	18	24	42	3D	4D	3D	K
----------	---	----	----	----	----	----	----	---

#### DIMENSIONS INCHES / MM

D	W	H
18 / 457	24 / 610	42 / 1067
18 / 457	24 / 610	51 / 1295
18 / 457	24 / 610	57 / 1448
18 / 457	30 / 762	42 / 1067
18 / 457	30 / 762	51 / 1295
18 / 457	30 / 762	57 / 1448
18 / 457	36 / 914	42 / 1067
18 / 457	36 / 914	51 / 1295
18 / 457	36 / 914	57 / 1448
24 / 610	24 / 610	42 / 1067
24 / 610	24 / 610	51 / 1295
24 / 610	24 / 610	57 / 1448

#### PRICING

WARDROBE (W)		SHELVES (S)	
Source Laminate	Foundation Laminate	Source Laminate	Foundation Laminate
n/a	n/a	1226	1346
n/a	n/a	1363	1510
n/a	n/a	1480	1643
n/a	n/a	1344	1494
n/a	n/a	1491	1675
n/a	n/a	1608	1813
n/a	n/a	1452	1633
n/a	n/a	1598	1818
n/a	n/a	1712	1957
1255	1373	1321	1442
1393	1540	1462	1608
1509	1672	1574	1739

Pricing is continued on the following page.

**J N F T T S**  
**Freestanding Tower with Two Full Solid Doors (Continued)**

**DIMENSIONS**  
**INCHES / MM**

D	W	H
24 / 610	30 / 762	42 / 1067
24 / 610	30 / 762	51 / 1295
24 / 610	30 / 762	57 / 1448
24 / 610	36 / 914	42 / 1067
24 / 610	36 / 914	51 / 1295
24 / 610	36 / 914	57 / 1448
30 / 762	24 / 610	42 / 1067
30 / 762	24 / 610	51 / 1295
30 / 762	24 / 610	57 / 1448
30 / 762	30 / 762	42 / 1067
30 / 762	30 / 762	51 / 1295
30 / 762	30 / 762	57 / 1448
30 / 762	36 / 914	42 / 1067
30 / 762	36 / 914	51 / 1295
30 / 762	36 / 914	57 / 1448

**PRICING**

WARDROBE (W)	
Source Laminate	Foundation Laminate
1332	1482
1479	1661
1593	1799
1416	1597
1563	1783
1675	1921
1369	1491
1509	1655
1625	1789
1445	1597
1593	1776
1711	1916
1531	1713
1677	1897
1801	2046

SHELVES (S)	
Source Laminate	Foundation Laminate
1470	1619
1616	1800
1732	1937
1470	1650
1616	1836
1730	1975
1436	1558
1574	1721
1691	1856
1587	1737
1732	1917
1847	2052
1587	1767
1732	1952
1854	2100