

freestanding storage

JNFCP

Combo Pedestal

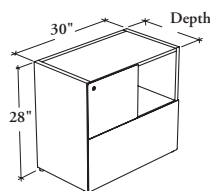

Open, Files (O)

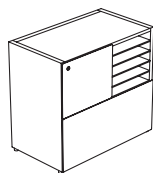

Shelves, Files (S)

This product provides storage and filing below the worksurface. It can be used freestanding or attached to the worksurface.

WHAT'S INCLUDED

1 combo pedestal (1 15" file drawer/1 30" file drawer), levelers, supporting kit (as specified), 1 12" hanging file bar, 2 15" hanging file bars, locks and keys (if specified), and accessories listed below:

	Configuration	
	O	S
Touch Latch Drawer	2	2
Open Compartment	1	n/a
Removeable Metal Shelf	n/a	4

WHAT'S EXCLUDED

Storage Organizers.

NOTES

The Combo Pedestal is a handed product and must be specified left (Shown) or right. The handed end is determined by the location of the 15" file drawer.

When 18" deep pedestal is specified, the Freestanding Application (F) is **not** available.

The 12" hanging file bar installs along the width in the 15" file drawer.

The 15" hanging file bars install along the depth in the 30" file drawer.

This storage has a central locking system and is also equipped with an interlock system that prevents opening more than one drawer at a time.

PRODUCT OPTIONS

Front Style	Configuration	Depth	Width	Height	Application
M Metal (Shown)	O Open, Files	18, 24	30	28	A Attached to Worksurface
S Solid	S Shelves, Files				F Freestanding

SAMPLE ORDER CODE

JNFCP S	O	24	30	28	F
----------------	----------	-----------	-----------	-----------	----------

PRODUCT OPTIONS CONTINUED

Orientation	Drawer Front Finish	Edge Trim Finish (Laminate Front Only)	Case Finish	Shelf Finish (Configuration (S) only)	Key Style
L Upper Drawer on Left (Shown)	Metal Front: (for metal front style)	Edge Trim Colors	Source Laminate	Foundation	K Keyed Alike
R Upper Drawer on Right	Foundation Mica Accent Laminate Front: (for solid front style) Source Laminate Foundation Laminate			Mica Accent	R Keyed Randomly N No Lock

SAMPLE ORDER CODE

L	XM	SB	XM		K
----------	-----------	-----------	-----------	--	----------

See Pricing on the following page.

J N F C P
Combo Pedestal (Continued)

DIMENSIONS
INCHES / MM

D	W	H
18 / 457	30 / 762	28 / 711
24 / 610	30 / 762	28 / 711

18 / 457	30 / 762	28 / 711
24 / 610	30 / 762	28 / 711

PRICING

METAL FRONT (M)		SOLID FRONT (S)	
OPEN, FILE (O)			
		Source Laminate	Foundation Laminate
	1077	1077	1134
	1182	1182	1240
SHELVES, FILES (S)			
	1200	1200	1258
	1304	1304	1362