

freestanding storage

J N F B W F

Beam Tower with Drawers and Wardrobe – Front Access

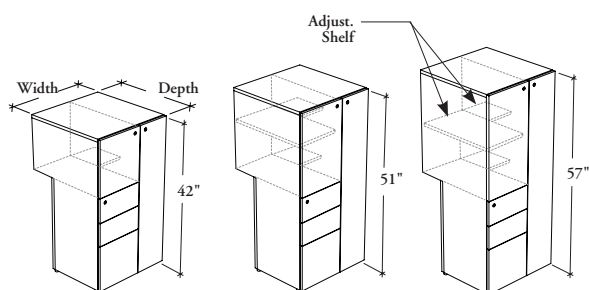

Front Access,
Box, Box, File or File, File

These beam towers provide storage area to store garments and other items combined the filing capabilities of a pedestal, while supporting the front of a worksurface and let a beam pass-through.

WHAT'S INCLUDED

1 beam tower with half wardrobe, levelers, 1 cable pass-through ring (as specified), 1 coat hook, locks and keys (if specified), beam mounting hardware, and accessories as listed below:

	Height			Position		Drawer Config.			
	42"	51"	57"	E	I	B	F		
Adjust. Shelf (on both compartment)	n/a	1	1	Hang-On Kit	1	2	Pencil Drawer Drawer Divider 12" Hang. File Bar	1 1 1	n/a n/a 2

WHAT'S EXCLUDED

Cable Pass-Through Cover (if applicable), Box Drawer Organizer and File Drawer Organizer.

NOTES

Included hanging file bars are to be installed along the width only.

Holes at 1 1/4" intervals on the inside walls of side panels of the top section and wardrobe allow for shelf adjustment.

Depth and width of drawers is always fixed. Only the high section depth can vary.

With Cable Pass-Through option is **not** applicable with In-Line position (I).

Cable Pass-Through Ring comes in a Platinum Coordinate.

When End of Station (E) position is specified, only the (N) or (S) Cable Pass-Through option is available.

This storage unit has a central locking system.

PRODUCT OPTIONS

Front Style	Drawer Configuration	Depth	Width	Height	Position
S Solid	B Box, Box, File (Shown) F File, File	24, 30	24, 30	42, 51, 57	E End of Station I In-Line

SAMPLE ORDER CODE

JNFBWF S	F	24	24	42	E
-----------------	----------	-----------	-----------	-----------	----------

PRODUCT OPTIONS CONTINUED

Orientation	Front Finish	Edge Trim Finish (Laminate Front Only)	Case Finish	Cable Pass-Through	Key Style
L Full Door on Left R Full Door on Right (Shown)	Source Laminate Foundation Laminate	Edge Trim Colors	Source Laminate	N No Pass-Through (Shown) S Standard-Height Pass-Through X Not Applicable	K Keyed Alike R Keyed Randomly N No Lock

SAMPLE ORDER CODE

L	XG	SS	XG	N	K
----------	-----------	-----------	-----------	----------	----------

See Pricing on the following page.

J N F B W F

**Beam Tower with Drawers and
Wardrobe – Front Access (Continued)**

**DIMENSIONS
INCHES / MM**

D	W	H
24 / 610	24 / 610	42 / 1067
24 / 610	24 / 610	51 / 1295
24 / 610	24 / 610	57 / 1448
24 / 610	30 / 762	42 / 1067
24 / 610	30 / 762	51 / 1295
24 / 610	30 / 762	57 / 1448
30 / 762	24 / 610	42 / 1067
30 / 762	24 / 610	51 / 1295
30 / 762	24 / 610	57 / 1448
30 / 762	30 / 762	42 / 1067
30 / 762	30 / 762	51 / 1295
30 / 762	30 / 762	57 / 1448

PRICING

FILE, FILE (F)		BOX, BOX, FILE (B)	
Source Laminate	Foundation Laminate	Source Laminate	Foundation Laminate
1432	1523	1478	1570
1542	1654	1590	1702
1609	1733	1655	1780
1550	1664	1596	1711
1655	1796	1703	1842
1725	1881	1772	1929
1526	1617	1572	1664
1636	1748	1684	1796
1703	1827	1749	1874
1644	1758	1690	1805
1749	1890	1797	1936
1812	1969	1860	2016