

The Bookcase provides open storage within the workstation.

JNFBL Bookcase

WHAT'S INCLUDED

1 bookcase, 4 levelers, supporting kit (includes with 28" height only) and adjustable shelf as listed below:

Adjustable Shelves	
28" or 29" high	1
42" high	2
51" or 57" high	3

28" or 29" high
42" high
51" or 57" high

WHAT'S EXCLUDED

Hang-On Kit.

NOTES

- 28" high Bookcase must be used under worksurfaces.
- Top on 29" to 57" heights overlaps side and back panels for a cleaner look.
- Holes at 1 1/4" intervals on the inside walls of side panels allow for shelf adjustment.
- The shelves and case construction are 1" thick.
- Two rows of standard letter-size binders will not fit in the 28" high Bookcase.

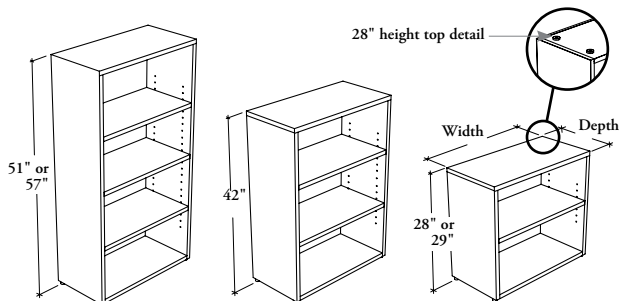

PRODUCT OPTIONS

Depth	Width	Height	Finish
15, 18	18, 24, 30, 36	28, 29, 42, 51, 57	Source Laminate

SAMPLE ORDER CODE

JNFBL 15	18	28	3D
----------	----	----	----

DIMENSIONS INCHES / MM

PRICING

D	W	28" or 29" HEIGHT	42" HEIGHT	51" or 57" HEIGHT
15 / 381	18 / 457	556	829	868
15 / 381	24 / 610	602	865	907
15 / 381	30 / 762	650	902	943
15 / 381	36 / 914	699	938	984
18 / 457	18 / 457	579	870	911
18 / 457	24 / 610	623	907	947
18 / 457	30 / 762	670	942	983
18 / 457	36 / 914	718	980	1021