

# freestanding storage

## J N F B G

### Beam Tower with Full Glass Door

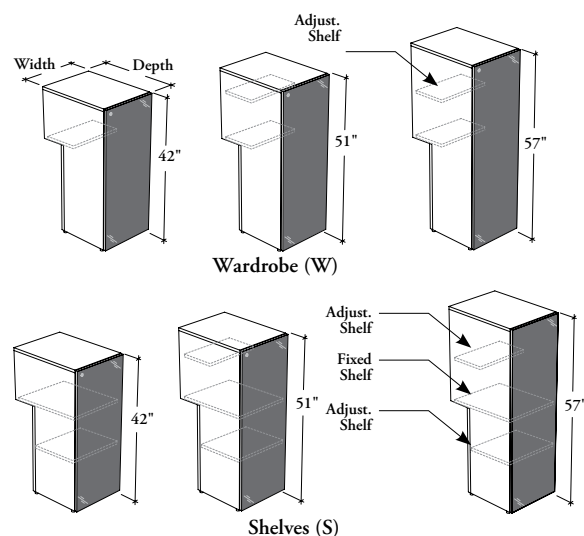

These beam towers provide storage area to store garments and other items, while supporting the front of a worksurface and let a beam pass-through.

#### WHAT'S INCLUDED

1 beam tower, levelers, 1 cable pass-through ring (as specified), 1 (12" w) or 2 (18" w) coat hooks (wardrobe only), locks and keys (if specified), beam mounting hardware, and accessories as listed below:

	Interior Configuration						Position	
	S			W			E	I
Heights	42"	51"	57"	42"	51"	57"		
Adjust. Shelf	1	2	2	n/a	1	1	Hang-On Kit	
Fixed Shelf	1	1	1	n/a	n/a	n/a		1 2

#### WHAT'S EXCLUDED

Cable Pass-Through Cover (if applicable).

#### NOTES

Holes at 1 1/4" intervals on the inside walls of side panels allow for shelf adjustment.

With Cable Pass-Through option is **not** applicable with In-Line position (I).

Cable Pass-Through Ring comes in a Platinum Coordinate.

When End of Station (E) position is specified, only the (N) or (S) Cable Pass-Through option is available.

#### PRODUCT OPTIONS

Interior Configuration	Depth	Width	Height	Position	Orientation
<b>S</b> Shelves	24, 30	12, 18	42, 51, 57	<b>E</b> End of Station	<b>L</b> Door Swing – Left
<b>W</b> Wardrobe				<b>I</b> In-Line	<b>R</b> Door Swing – Right (Shown)

#### SAMPLE ORDER CODE

<b>JNFBG W</b>	<b>24</b>	<b>18</b>	<b>51</b>	<b>I</b>	<b>R</b>
----------------	-----------	-----------	-----------	----------	----------

#### PRODUCT OPTIONS CONTINUED

Door Frame Finish	Glass Door Finish	Case Finish	Cable Pass-Through	Key Style
Foundation Mica Accent	Back-Painted	Source Laminate	<b>N</b> No Pass-Through (Shown) <b>S</b> Standard-Height Pass-Through <b>X</b> Not Applicable	<b>K</b> Keyed Alike <b>R</b> Keyed Randomly <b>N</b> No Lock

#### SAMPLE ORDER CODE

<b>53</b>	<b>K1</b>	<b>3D</b>	<b>X</b>	<b>K</b>
-----------	-----------	-----------	----------	----------

See Pricing on the following page.

**J N F B G**  
**Beam Tower with Full Glass Door**  
**(Continued)**

**DIMENSIONS**  
**INCHES / MM**

D	W	H
24 / 610	12 / 305	42 / 1067
24 / 610	12 / 305	51 / 1295
24 / 610	12 / 305	57 / 1448
24 / 610	18 / 457	42 / 1067
24 / 610	18 / 457	51 / 1295
24 / 610	18 / 457	57 / 1448
30 / 762	12 / 305	42 / 1067
30 / 762	12 / 305	51 / 1295
30 / 762	12 / 305	57 / 1448
30 / 762	18 / 457	42 / 1067
30 / 762	18 / 457	51 / 1295
30 / 762	18 / 457	57 / 1448

**PRICING**

**WARDROBE (W)**

Back-Painted
1333
1436
1559
1507
1609
1735
1380
1482
1598
1551
1655
1747

**SHELVES (S)**

Back-Painted
1400
1499
1619
1640
1750
1883
1445
1544
1632
1643
1748
1840

**KEY UPCHARGE**

Keyed Alike or Keyed Randomly
56
56
56
56
56
56
56
56
56
56
56
56
56
56