

beam-mounted storage



J N B S O

Suspended Credenza – Open with Lateral File

This storage must be installed on-module, between two structural legs and on front of a structural beam, to provide filing and open storage.

WHAT'S INCLUDED

1 credenza, 1 drawer, lock and keys (as specified), mounting hardware and accessories listed below:

	Width	
	42" to 54"	60" to 84"
12" Hanging File Bar	1	2 (if 18" depth)
15" Hanging File Bar	1	2 (if 24" depth)

WHAT'S EXCLUDED

Structural Beam, Chicago Structural Beam, EZ Fence Beam, Chicago EZ Fence Beam, EZ Fence Beam for Corridor, Chicago EZ Fence Beam for Corridor, EZ Structural Legs, Structural Legs and File Drawer Organizer.

NOTES

Included hanging file bars are to be installed along the depth only.

Beam Configuration must match the beam on which the storage will be mounted.

The Support Mounting Hardware Finish can be specified to match the case or the leg to which the storage is mounted to. See the application guide section for details.

When Front Style (M or N) is specified, only Metal Drawer Front Finish is available.

When Front Style (S or T) is specified, only Laminate Drawer Front Finish is available.

When Front Style (M or S) is specified, Pull Style and Pull Finish are **not** available.

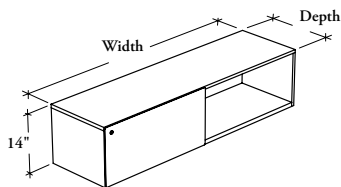

PRODUCT OPTIONS

Front Style	Structural Leg Style	Case Height	Depth	Width	Width Reduction	Beam Configuration
M Metal (Shown) N Metal with Pull S Solid T Solid with Pull	A Angled	14 14" (Datum Height 24")	18, 24	42, 48, 54, 60, 66, 72, 78, 84	FF Full Legs FH Full/Shared Legs HH Shared Legs_ None/Full Leg NH None/Shared Leg NN None Leg	D Double-Sided S Single-Sided

SAMPLE ORDER CODE

JNBSO S	A	14	18	72	HH	D
---------	---	----	----	----	----	---

PRODUCT OPTIONS CONTINUED

Orientation	Front Finish	Edge Trim Finish (for Laminate Front only)	Case Finish	Pull Style (for Front Style (N or T) only)	Pull Finish (for Front Style (N or T) only)	Key Style	Support Mounting Hardware Finish
L Drawer on Left (Shown) R Drawer on Right	Metal Front: (for metal front style) Foundation Mica Accent Laminate Front: (for solid front style) Source Laminate Foundation Laminate	Edge Trim Colors	Source Laminate	C Cityline Recessed	Foundation Mica Accent	K Keyed Alike R Keyed Randomly N No Lock	Foundation Mica Accent Coordinate Colors

SAMPLE ORDER CODE

L	3D	4D	3D			R	60
---	----	----	----	--	--	---	----

See Pricing on the following page.

J N B S O
Suspended Credenza – Open with Lateral File (Continued)

DIMENSIONS
INCHES / MM

H	D	W
14 / 356	18 / 457	42 / 1067
14 / 356	18 / 457	48 / 1219
14 / 356	18 / 457	54 / 1372
14 / 356	18 / 457	60 / 1524
14 / 356	18 / 457	66 / 1676
14 / 356	18 / 457	72 / 1829
14 / 356	18 / 457	78 / 1981
14 / 356	18 / 457	84 / 2134
14 / 356	24 / 610	42 / 1067
14 / 356	24 / 610	48 / 1219
14 / 356	24 / 610	54 / 1372
14 / 356	24 / 610	60 / 1524
14 / 356	24 / 610	66 / 1676
14 / 356	24 / 610	72 / 1829
14 / 356	24 / 610	78 / 1981
14 / 356	24 / 610	84 / 2134

PRICING

METAL FRONT (M) or METAL FRONT WITH PULL (N)	SOLID FRONT (S) or SOLID FRONT WITH PULL (T)	
	Source Laminate	Foundation Laminate
954	954	974
1071	1071	1102
1189	1189	1231
1307	1307	1357
1424	1424	1485
1531	1531	1592
1639	1639	1698
1747	1747	1807
1070	1070	1090
1188	1188	1218
1306	1306	1346
1422	1422	1472
1540	1540	1600
1647	1647	1709
1755	1755	1814
1862	1862	1922