

ez suspended storage

UNDERSTANDING EZ SUSPENDED STORAGE	186
EZ SUSPENDED CREDENZA BASICS	187
PLANNING WITH EZ SUSPENDED CREDENZAS	190
PLANNING WITH BEAM-MOUNTED STORAGE	193
PLANNING WITH POWER & DATA – EZ SUSPENDED CREDENZA – MEDIA CENTER – SINGLE-SIDED	195
DRAWERS & OPENING SIZING CHART – EZ SUSPENDED CREDENZA	196
INTEGRATING ACCESSORIES (OPTIONAL) – EZ SUSPENDED CREDENZA	199
LOCK CHART – EZ SUSPENDED CREDENZA	200
EZ SUSPENDED SHELF BASICS	201
GRAIN DIRECTION – EZ SUSPENDED STORAGE	202

understanding ez suspended storage

The EZ Fence Structure allows the mounting of a variety of EZ Suspended Storage creating a functional environment while keeping an impression of lightness.



All EZ Suspended Credenzas in this section are only compatible with the EZ Fence Structure

- EZ Suspended Storage must always be used with 20" deep EZ Fence Legs (JZSFS) and EZ Fence Beams (JZSBB or JZSCB)
- Suspended Credenzas found in the Beam-Mounted Storage section can also be used with the EZ Fence Structure. In these cases, Single- or Double-Sided EZ Structural Legs must be used. Refer on page 193 and Beam-Mounted Storage section for more details

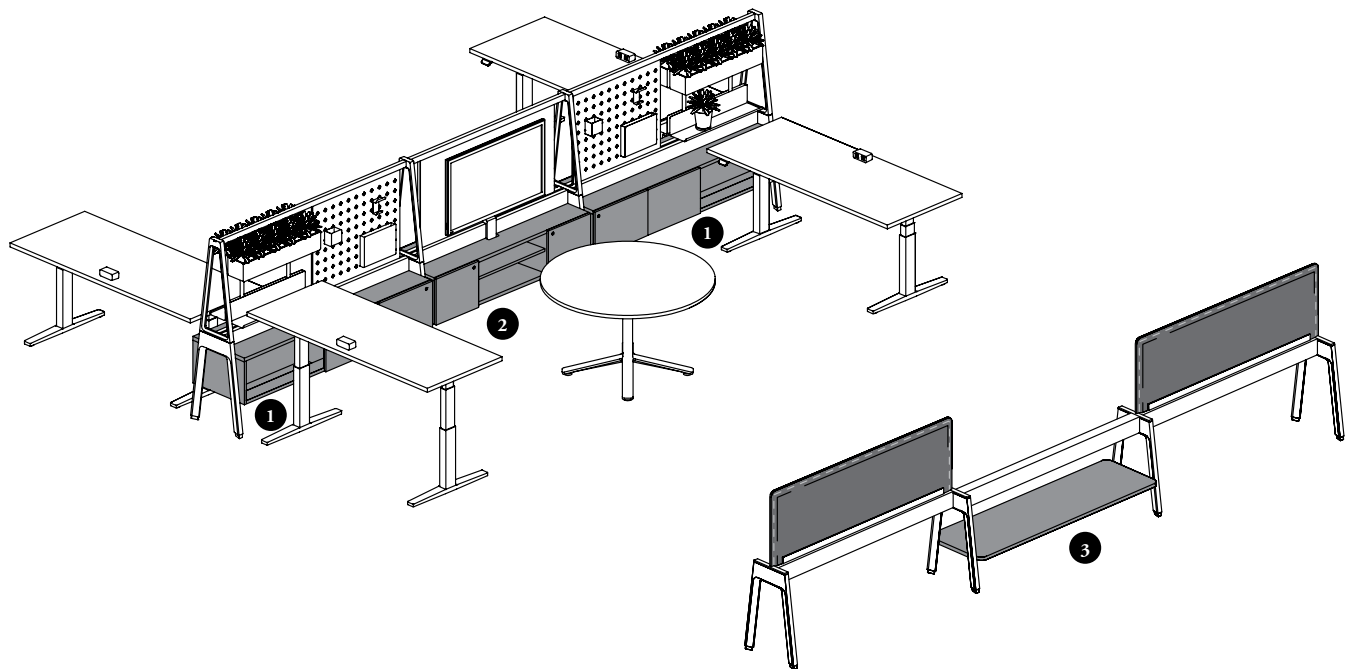

Suspended Storage are offered in three configurations:

- 1 EZ Suspended Credenzas are offered in on- and off-module format. Credenzas provide high density filing and organized storage under an EZ Fence Beam
- 2 EZ Suspended Credenza – Media Center combined with Solid Lift and Drop Media Tile (JZTSM) allow media presentation in casual space. This credenza provides storage and wire management solution under an EZ Fence Beam
- 3 EZ Suspended Shelf provides open storage below EZ Fence Beam

ez suspended credenza basics

The EZ Suspended Credenzas are storage units that can be mounted centered under an EZ Fence Beam or Chicago EZ Fence Beam. They are offered in many configurations to give optimal functionality to one or both sides of the EZ Fence Structure.

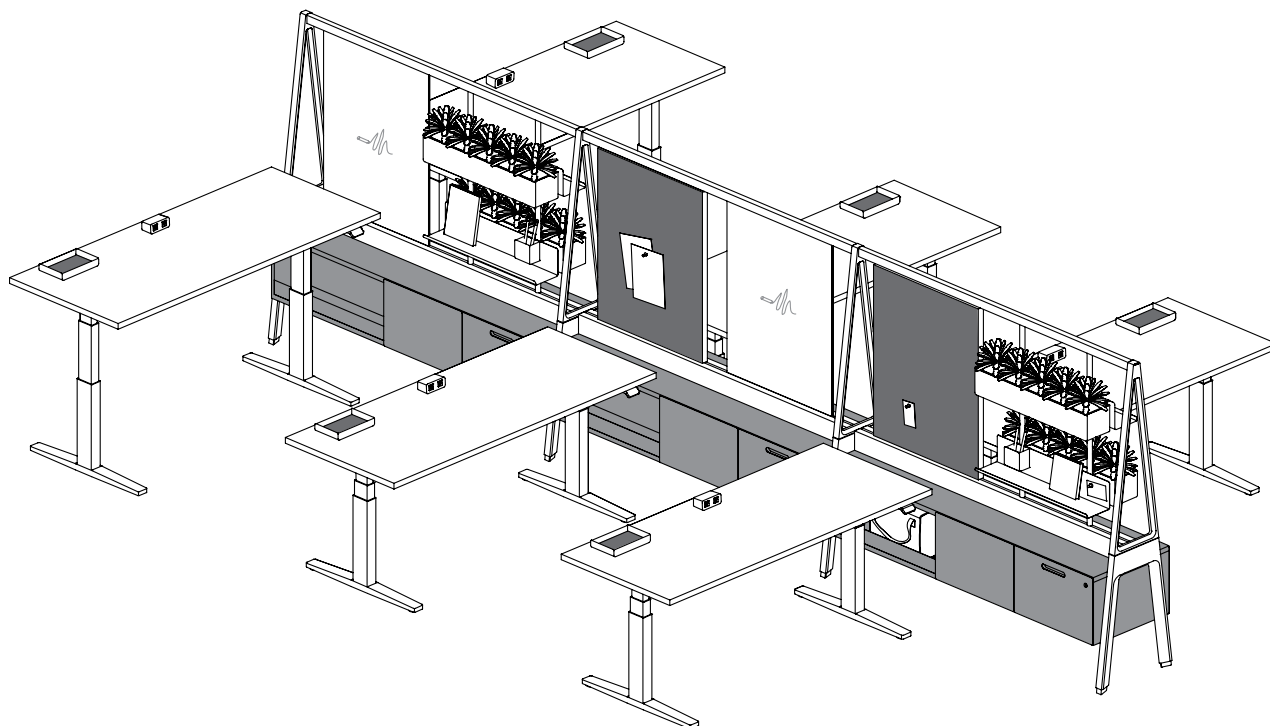

Finishes

Case Finishes: Source Laminate

Metal Front Finishes: Foundation, Mica and Accent

Solid Front Finishes: Source Laminate and Foundation Laminate

Edge Trim Finishes (Laminate Front only): Edge Trim Colors

Pull and/or Bag Holder Finishes (If Applicable): Foundation, Mica and Accent

Leg Mounting Hardware Finishes*: Foundation, Mica and Accent

* Can be specified to match the leg finish on which the storage is mounted (recommended)

Cable Pass-Through Ring Finish: Platinum (Shared Credenza only)

Grommet with Cover Finish: Color coordinate with the case (Media Center Credenza only)

Pass-Through Metal Channel Finish: Match Leg Mounting Hardware finish (Media Center Credenza only)

Metal Scallop Ring Finish: Match Leg Mounting Hardware finish (Media Center Credenza only)

ez suspended credenza basics (continued)

- All EZ Suspended Credenza styles can be mounted on EZ Fence Leg (JZSFS) only
- Compatible with EZ Fence Beam (JZSBB) or Chicago EZ Fence Beam (JZSCB)
- Front Style is available in Metal (M), Metal with Pull (N), Solid (S) or Solid with Pull (T) styles, except for EZ Suspended Credenza – Media Center – Single-Sided available with Solid Front Style (S) only
- Drawers come with Cityline Recessed (C) pull, when Front Style (N or T) is specified. Doors come with **no** pull

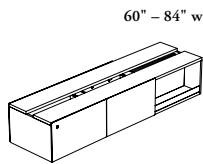

EZ Suspended Credenza – Lateral File and Cubby – Shared (JZBSO)

- Available for Angled (A) EZ Fence Leg Style
- Available in 20" depth only
- Case height is 14"
- Widths include 60" – 84" (6" increments)
- Available in Drawer on Left/Right orientations
- File Drawers are available with lock (Keyed Alike (K) or Keyed Randomly (R)) or no lock (N)

TOP VIEW

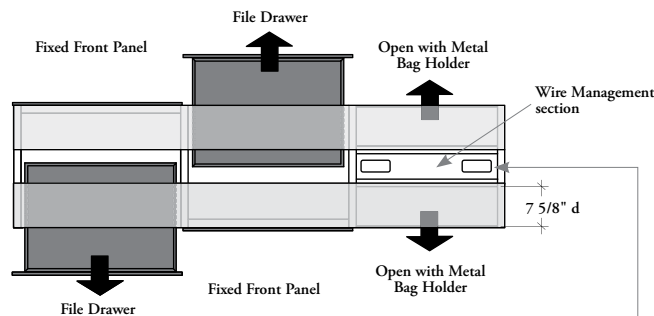

- This credenza must be mounted on-module between two EZ Fence Legs
- Width is nominal
- This style is handed
- One side of the open section have a removable back panel and two cable pass-through rings at the bottom to allow the passage of wires (base feed, data, height-adjustable table cable) through the credenza and allow access to the beam above

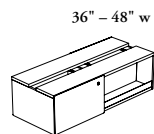
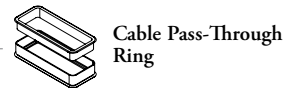

EZ Off-Module Suspended Credenza – Lateral File and Cubby – Shared (JZBDO)

- Available for Angled (A) EZ Fence Leg Style
- Available in 20" depth only
- Case height is 14"
- Widths include 36" – 48" (6" increments)
- File Drawers can be configured left or right configuration
- File Drawers are available with lock (Keyed Alike (K) or Keyed Randomly (R)) or no lock (N)

TOP VIEW

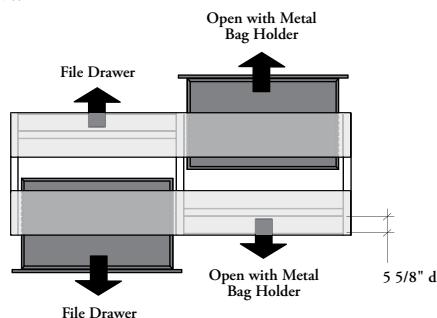

- This credenza must be mounted off-module on an EZ Fence Structure, only one side of the credenza must be mounted on an EZ Fence Leg. The other side is floating (**no** leg or support is needed)
- The actual width of the credenza is 1 1/2" shorter than its nominal dimension
- This style is handed
- No wire management through the credenza

ez suspended credenza basics (continued)

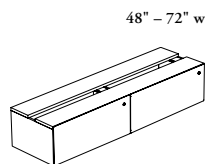

EZ Suspended Credenza – Lateral File – Single-Sided (JZBFF)

- Available for Angled (A) EZ Fence Leg Style
- Available in 20" depth only
- Case height is 14"
- Widths include 48" – 72" (6" increments)
- File Drawers are available with lock (Keyed Alike (K) or Keyed Randomly (R)) or no lock (N)

TOP VIEW

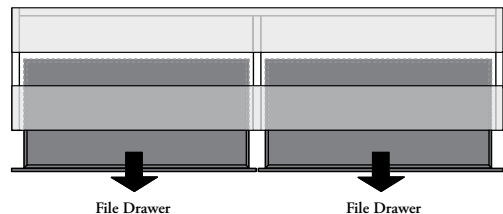

- This credenza must be mounted on-module between two EZ Fence Legs
- Width is nominal
- No wire management through the credenza

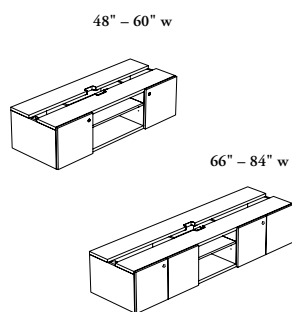

EZ Suspended Credenza – Media Center – Single-Sided (JZBSM)

- Only Solid Front Style (S) is available
- Available for Angled (A) EZ Fence Leg Style
- Available in 20" depth only
- Case height is 14"
- Widths include 48" – 84" (6" increments)
- Hinged Doors are available with lock (Keyed Alike (K) or Keyed Randomly (R)) or no lock (N)

TOP VIEW

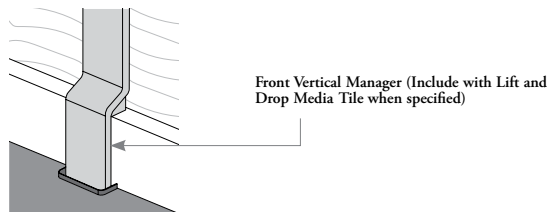
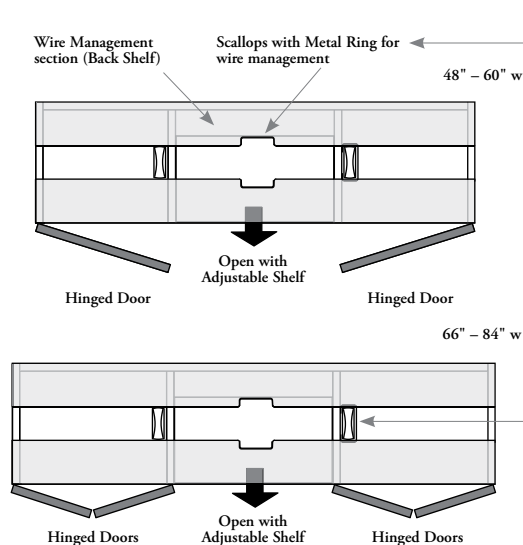

- This credenza must be mounted on-module between two EZ Fence Legs
- Width is nominal
- Comes with an adjustable shelf to manage electronic devices in the open section. The shelf is short at the back to leave a space to route cables

Wire Management Details

- On the credenza top, two scallops with Metal Rings are included to allow wire management between the open section of the credenza and the Lift and Drop Media Tile. The scallops allow the integration of Front Vertical Manager
- In the door sections, two Grommets with Covers and one Pass-Through Metal Channel are included to allow discreet infeed through credenza

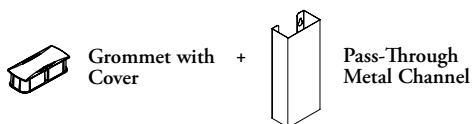

planning with ez suspended credenzas

The following should be considered when planning with Expansion Cityline EZ Suspended Credenzas.

on-module application

- An EZ Suspended Credenza is mounted centered under the EZ Fence Beam and have the same depth than the EZ Fence Leg
- The credenza is equally shared on each side of the beam
- Three EZ Suspended Credenzas listed below must be used on-module on an EZ Fence Structure:
 - EZ Suspended Credenza – Lateral File and Cubby – Shared (JZBSO)
 - EZ Suspended Credenza – Lateral File – Single-Sided (JZBFF)
 - EZ Suspended Credenza – Media Center – Single-Sided (JZBSM)

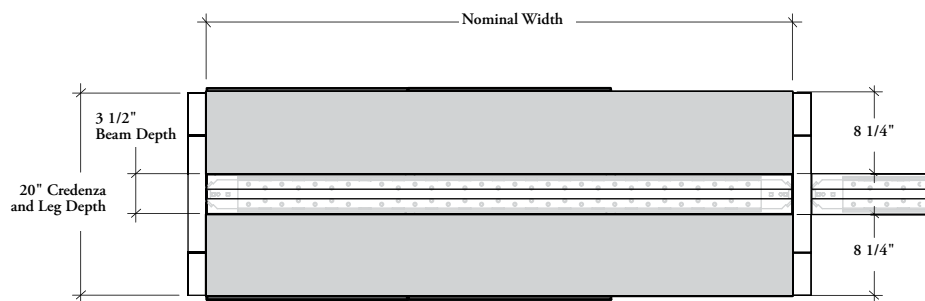

- These credenza are nominal width and will fit between two EZ Fence Legs

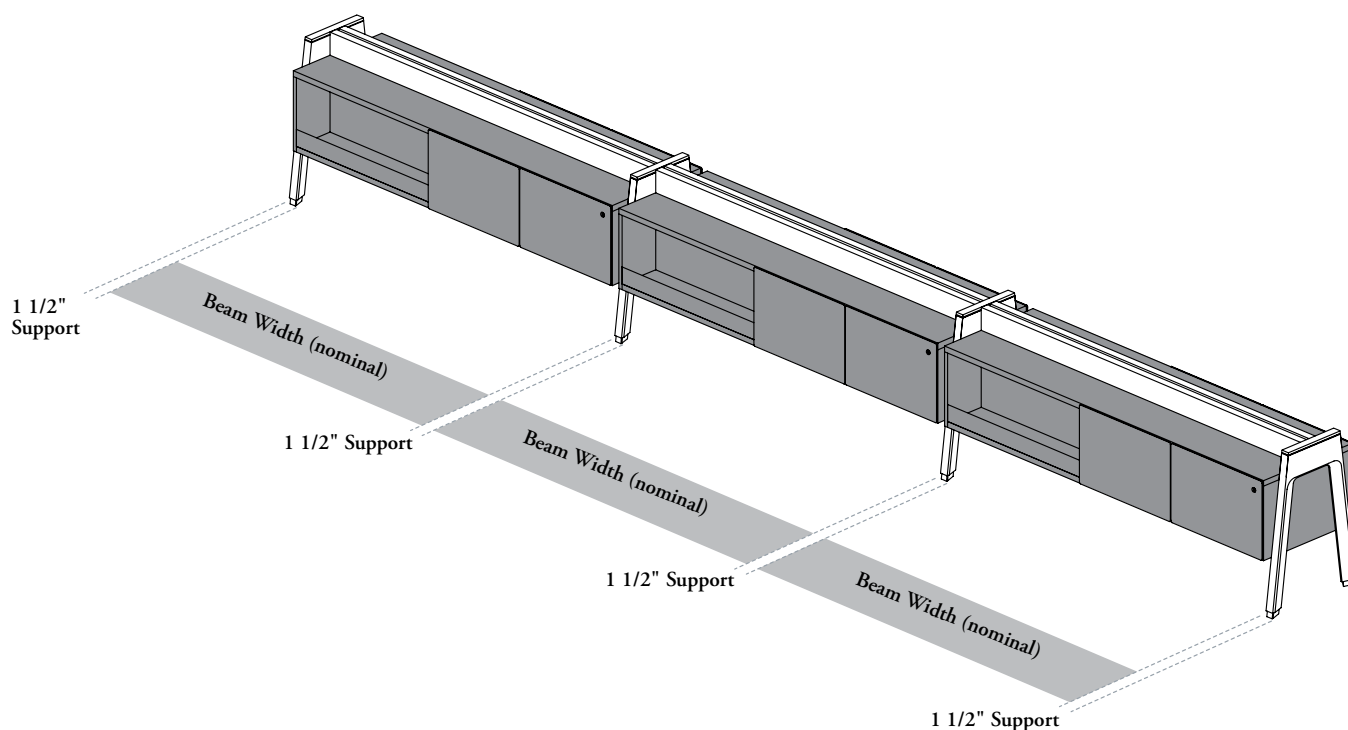

planning with ez suspended credenzas (continued)

off-module applications

- Only EZ Off-Module Suspended Credenza – Lateral File and Cubby – Shared (JZBDO) must be used off-module
- The credenza is equally shared on each side of the beam

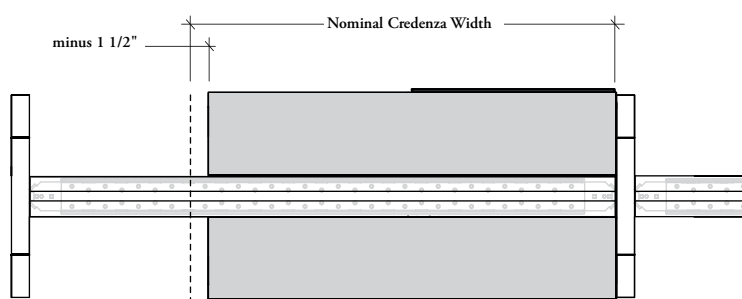

- The actual width of the credenza is 1 1/2" shorter than its nominal dimension

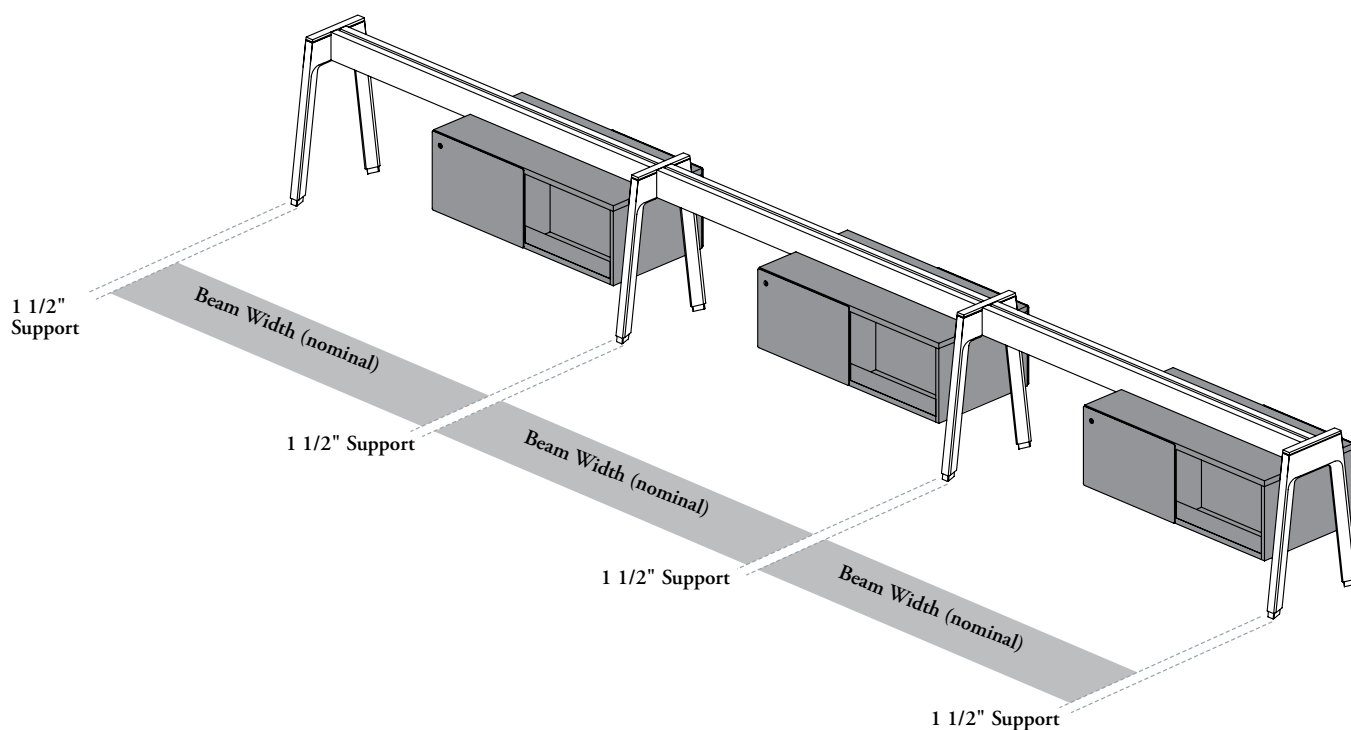

planning with ez suspended credenzas (continued)

off-module applications (continued)

EZ Off-Module Credenza with Height-Adjustable Tables

- The EZ Off-Module Suspended Credenza – Lateral File and Cubby – Shared (JZBDO) can be combined with hiSpace or Navigate Height-Adjustable Tables to create smaller footprint workstations
- Since the credenza is already 1 1/2" shorter than its nominal dimension, it is easy to combine the credenza with a Height-Adjustable Table while keeping the required 1" pinch gap all around the worksurface

Example: A 42" wide credenza on a 72" wide EZ Fence Beam leaves a 31 1/2" opening, perfect for a 29" deep table

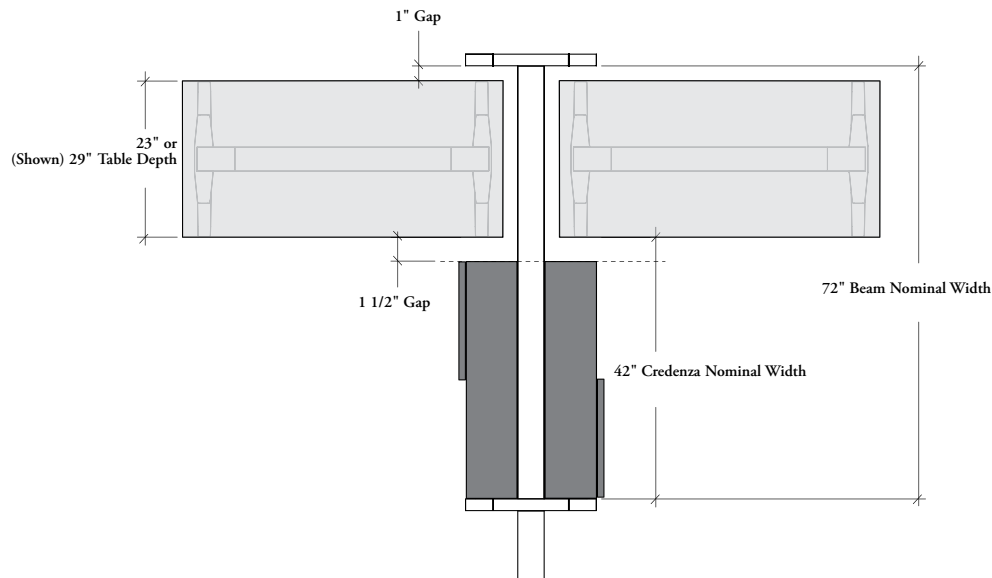

EZ Off-Module Credenza with Run-Off EZ Fence

- An EZ Off-Module Suspended Credenza – Lateral File and Cubby – Shared (JZBDO) is the only credenza that can be used with a Run-Off for EZ Fence (JZWRF)
- The EZ Off-Module Suspended Credenza **cannot** overlap the Run-Off for EZ Fence

Example: A 42" wide credenza on a 72" wide EZ Fence Beam leaves a 30" nominal opening for a 29" worksurface. The gap will be 2 1/2"

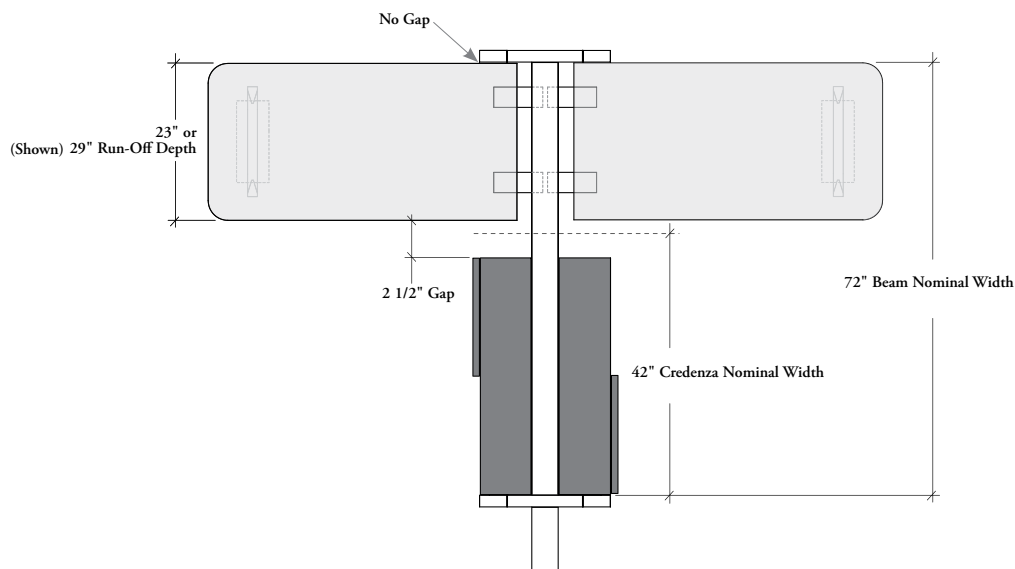

planning with beam-mounted storage

The Suspended Credenzas from Beam-Mounted Storage section can also be mounted to an EZ Fence Beam when supported by Single- or Double-Sided EZ Structural Legs

on-module applications with beam-mounted storage – suspended credenzas

- Two Beam-Mounted Storage styles are compatible with EZ Fence Structure:
 - Suspended Credenzas (JNBSE, JNBSE, JNBSEO and JNBSC)
 - Semi-Suspended Credenzas (JNBDE, JNBDO, JNBDOO and JNBDC)
- They must be specified with None Leg Width Reduction (NN)
- Semi-Suspended Credenzas must be specified with One Foot (O) when not attached to a Storage Cabinet for Height-Adjustable Run-Off (JNHSC)
- When mounted on Single-Sided EZ Structural Legs, the depth of the Beam-Mounted Credenza must match the depth of the leg. Beam Configuration must be specified Single-Sided (S)
- When mounted on Double-Sided EZ Structural Legs, the depth of the Beam-Mounted Credenza must be the half depth of the leg. Beam Configuration must be specified Double-Sided (D)

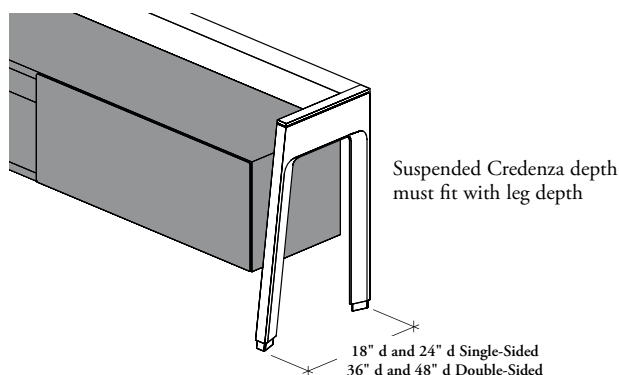
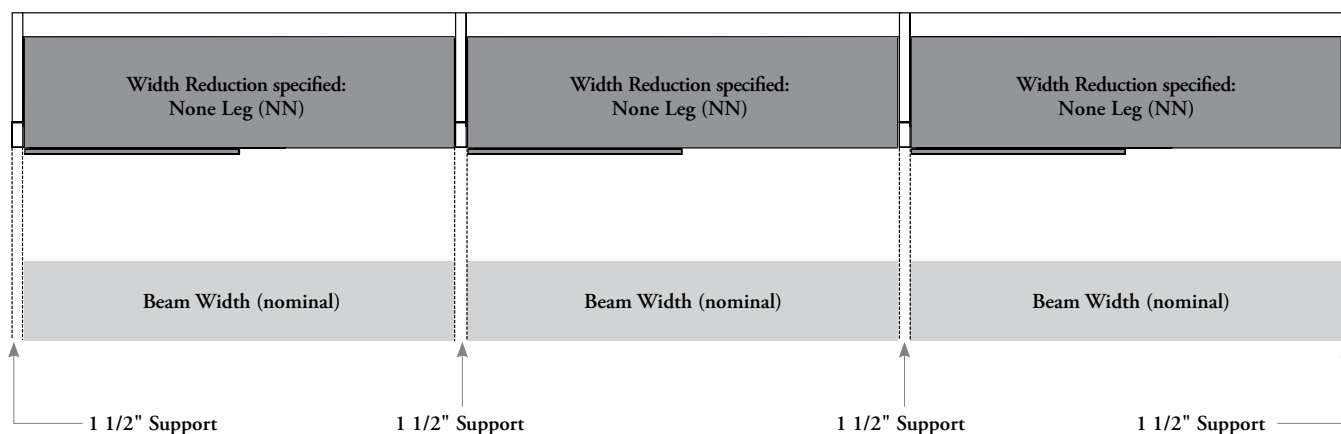
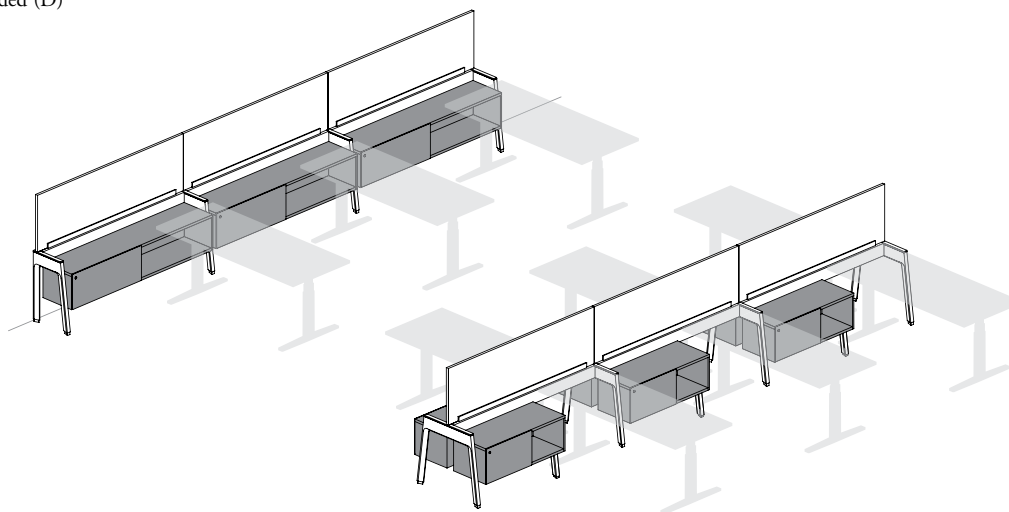

planning with beam-mounted storage (continued)

on-module applications with beam-mounted storage – suspended credenzas (continued)

Combined with Storage Cabinet for Height-Adjustable Run-Off

- Only one Beam-Mounted Storage style can be placed on-module with this application:
 - Suspended Credenzas (JNBSF, JNBSO, JNBSEO and JNBSC)
- Height-Adjustable Run-Off – Bevel Base (JNHB) and Storage Cabinet for Height-Adjustable Run-Off (JNHSC) are compatible with the EZ Fence Structure, but need to be a specific configuration. The Suspended Credenza must always be specified with None Leg Width Reduction (NN)

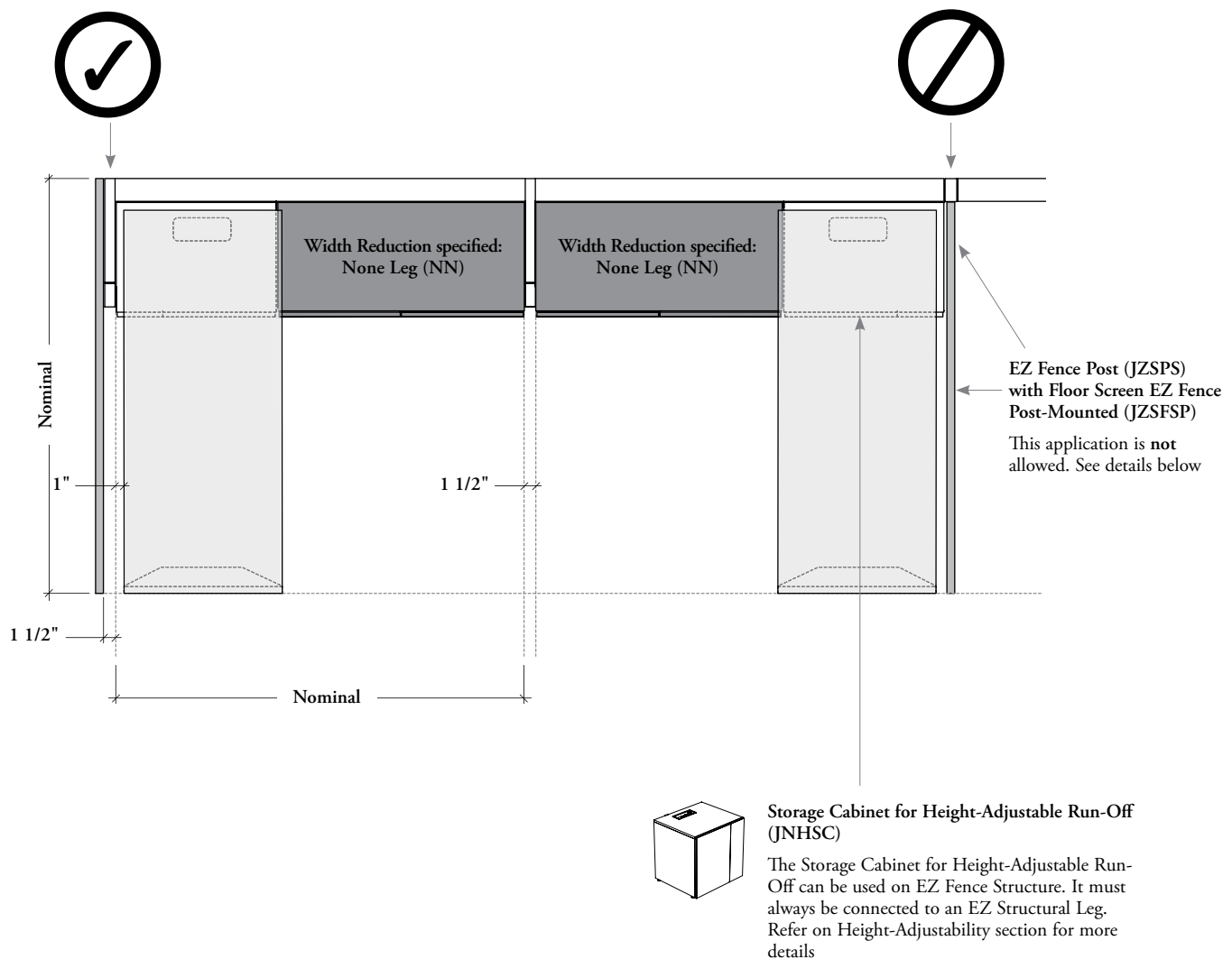

planning with power & data – ez suspended credenza – media center – single-sided

cable managements with ez suspended credenza – media center

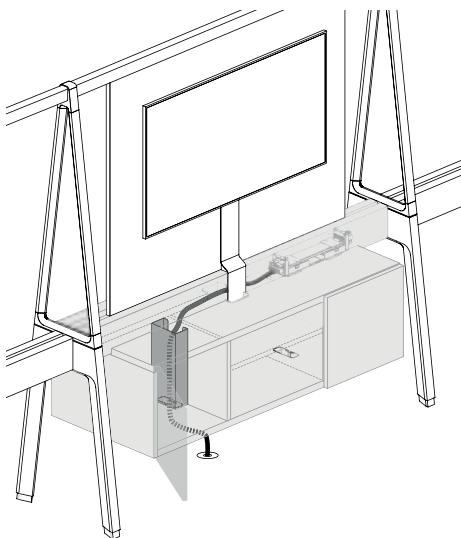

Base Feed/Data Cables

- Base Feed and data cables can be routed from floor to EZ Fence Beam, through the EZ Suspended Credenza – Media Center – Single-Sided (JZBSM)
- In the door sections, two Grommets with Covers and one Pass-Through Metal Channel are included to allow discreet infeed through credenza

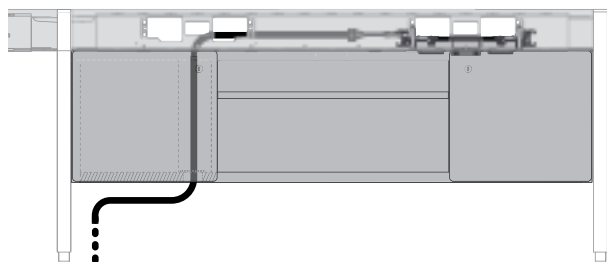

Power Box Position (JNEPB or JNECPB) & Orientation in Media Center

– Facing Down (D) Position (Shown)

- Power Box Facing Down is recommended to discreetly feed electronic device cables
- Power Box in center position is **not** recommended, cables can be visible through the open section and can have interference with electronic devices installed in the credenza

– Facing Side (B) Position

- Power Box Facing Side is **NOT** recommended to feed electronic device cables, and cannot be specified in center position when combined with a Media Tile with Front Vertical Manager (F)
- For more details on Power Box, refer to Lighting, Electrics & Communications section

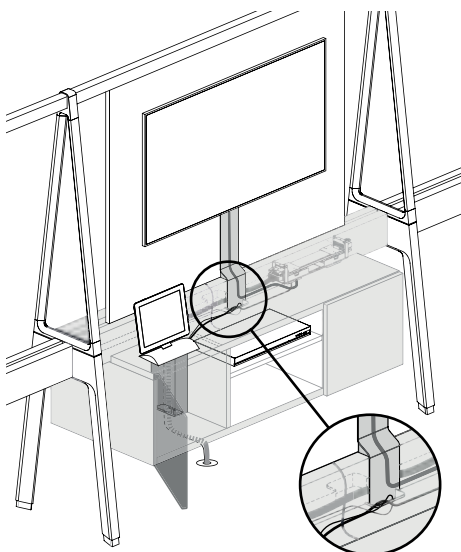

Electronic Devices Cable Management

This EZ Suspended Credenza allows passage of electronic device cables from the open section of the credenza to the top by the two scallops located on both sides of the EZ Fence Beam

drawers & opening sizing chart – ez suspended credenza

The following illustrates Expansion Cityline EZ Suspended Credenza drawers and open sections nominal widths.

EZ Suspended Credenza – Lateral File and Cubby – Shared (JZBSO)

60" Width

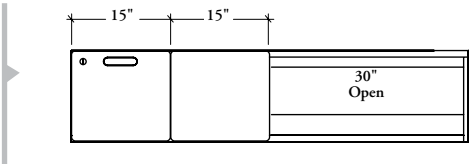

66" Width

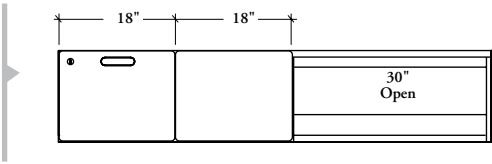

72" Width

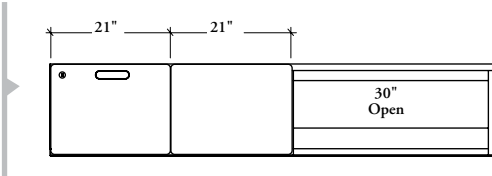

78" Width

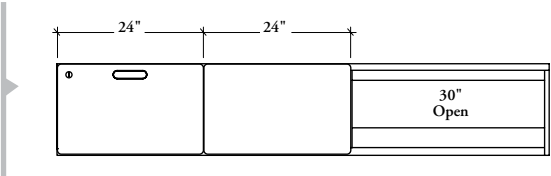

84" Width

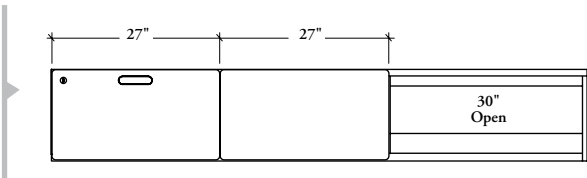

EZ Off-Module Suspended Credenza – Lateral File and Cubby – Shared (JZBDO)

36" Width

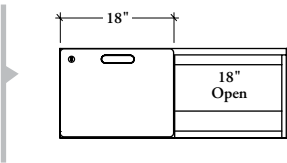

42" Width

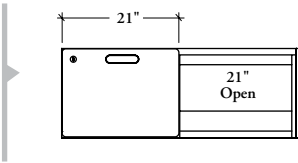

48" Width

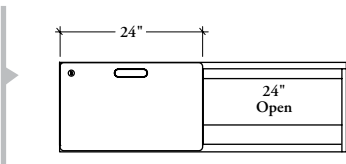

drawers & opening sizing chart – ez suspended credenza (continued)

EZ Suspended Credenza – Lateral File – Single-Sided (JZBFF)

48" Width

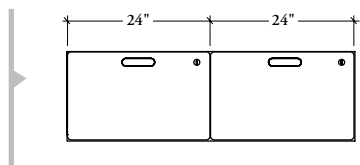

54" Width

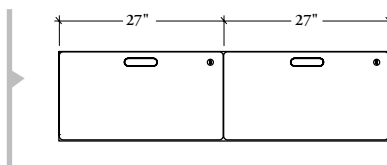

60" Width

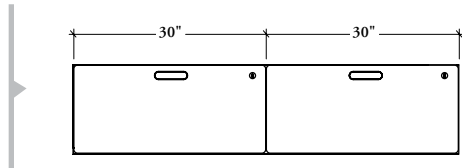

66" Width

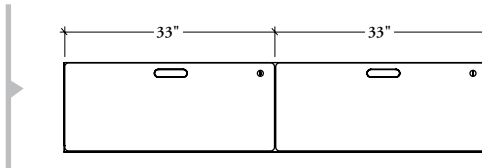

72" Width

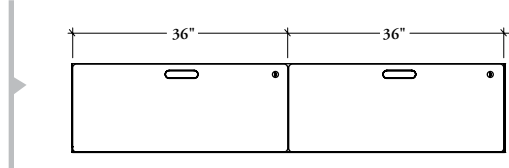

EZ Suspended Credenza – Media Center – Single-Sided (JZBSM)

Single Door

48" Width

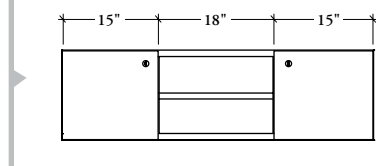

54" Width

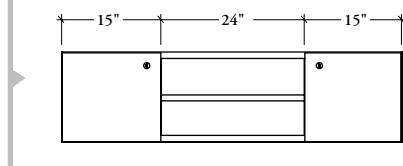

60" Width

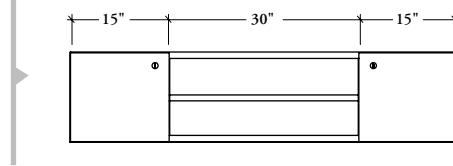

Double Doors

66" Width

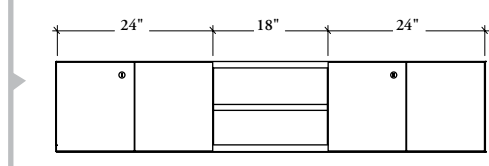

72" Width

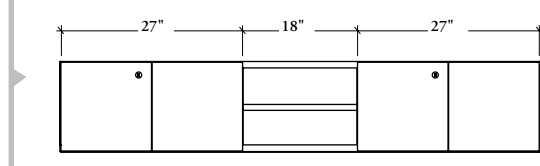

78" Width

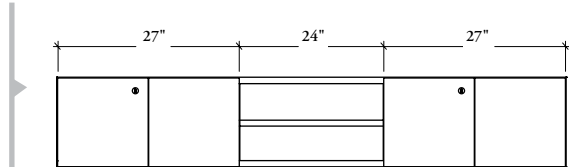

84" Width

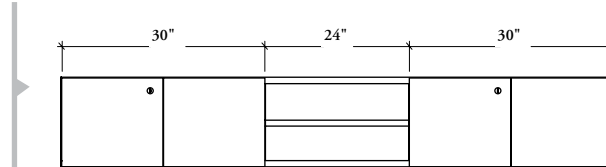

drawers & opening sizing chart – ez suspended credenza (continued)

Lateral file drawer storage capacities are shown below.

- Drawers have full extension slides
- Filing can be front-to-back and/or side-to-side
- The drawer inner-dimensions are listed below
- Hanging File Bars are supplied in sufficient quantity to accomplish all that is shown below

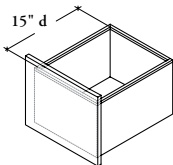
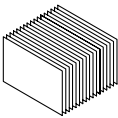
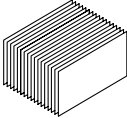
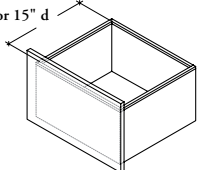
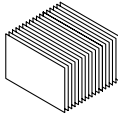
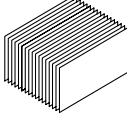
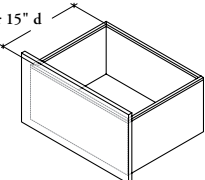
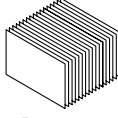
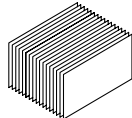
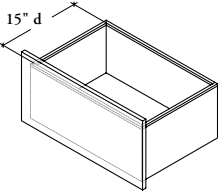
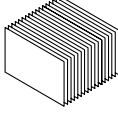
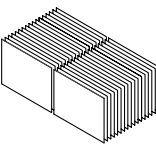
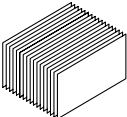
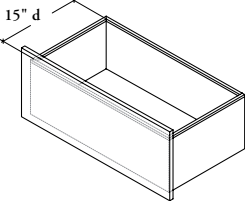
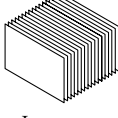
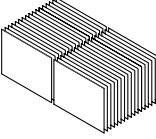
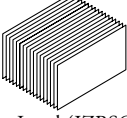
	One Filing Section	Two Filing Sections	
	Front-to-Back	Front-to-Back	Side-to-Side
15" wide drawer			
	 • Letter	n/a	 • Legal (JZBSO or JZBFF)
18" or 21" wide drawer			
	 • Letter • Legal	n/a	 • Letter (JZBDO) • Legal (JZBSO or JZBFF)
24" or 27" wide drawer			
	 • Letter • Legal	n/a	 • Letter (JZBDO) • Legal (JZBSO or JZBFF)
30" or 33" wide drawer			
	 • Letter • Legal	 • Letter (30" wide) • Letter (33" wide)	 • Legal (JZBSO or JZBFF)
36" wide drawer			
	 • Letter • Legal	 • Letter • Legal	 • Legal (JZBSO or JZBFF)



Hanging File Bar (JNFALB) can be ordered separately for replacement of original bars

integrating accessories (optional) – ez suspended credenza

Accessories can be integrated with Expansion Cityline EZ Suspended Credenzas to increase functionality.

Can be specified separately, refer to the Accessories section for details

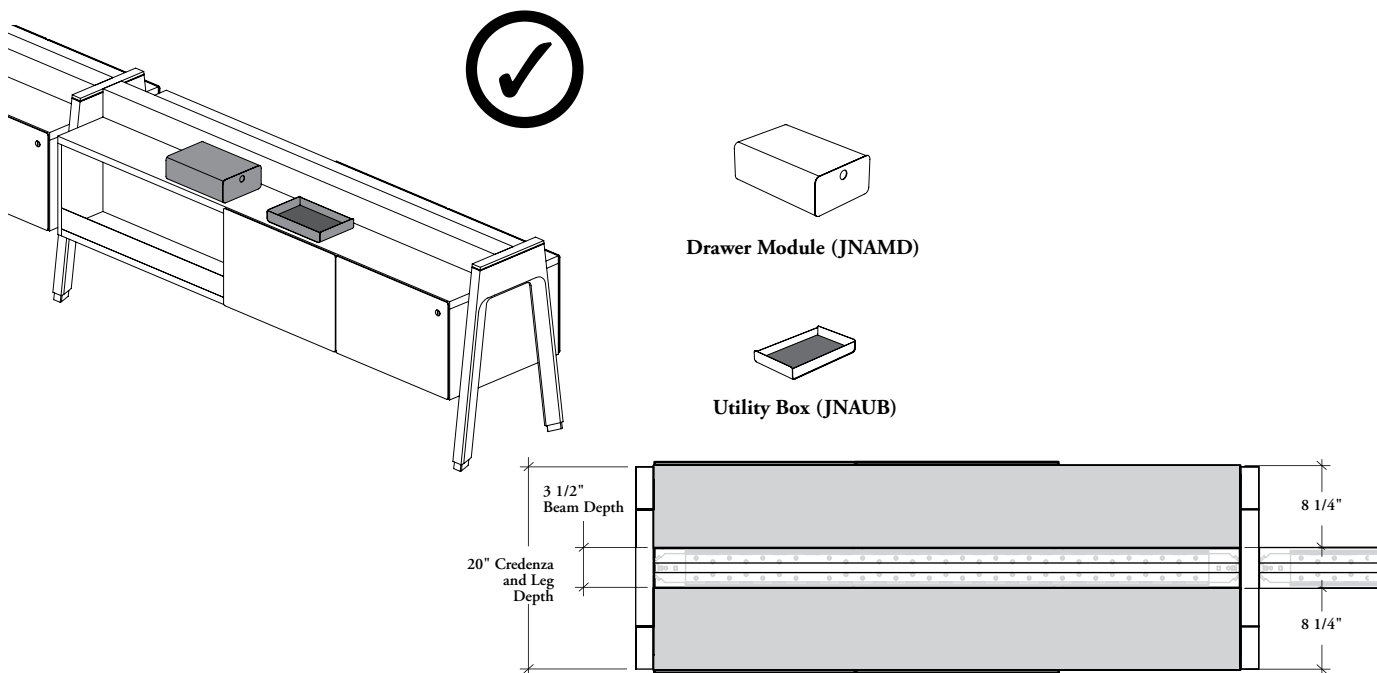

- Only Pocket Drawer Module (JNAMD^P) and the Utility Box (JNAUB) can be used on top of an EZ Suspended Credenza
- Seat Pad (JNACF) or Fabric Seat Cushion (JNACU) **cannot** be used on top of an EZ Suspended Credenza

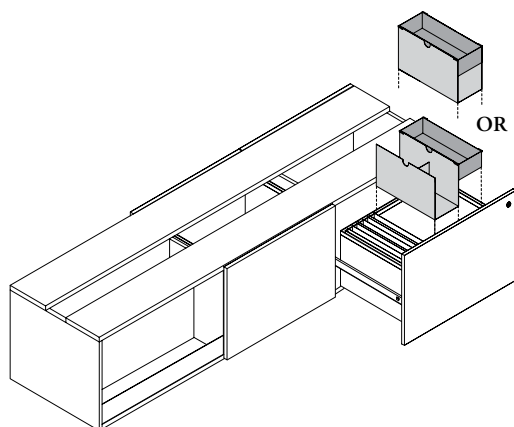

File Drawer Organizer (JNASO)

- The File Drawer Organizer (letter- or legal-size) can be used in file drawers for additional organization, they add functionality to File drawers
- Organizer and drawer depths must be specified accordingly:

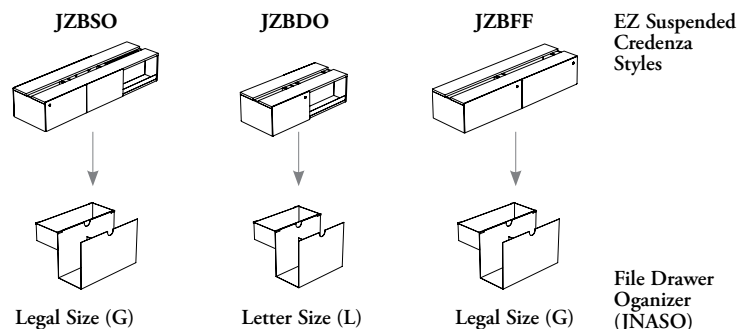

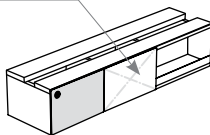
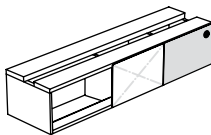
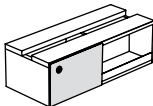
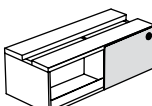
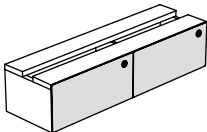
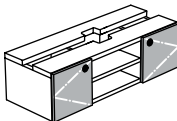
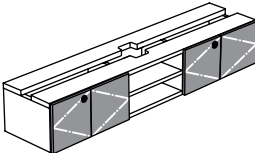

lock chart – ez suspended credenza

If specified, all closed storage come with a lock and key set and can be keyed alike or randomly. A Key Chart must accompany every order, otherwise, orders will be shipped keyed randomly

	number of locks
<div><div><div>Fixed Panel</div><div>Drawer on Left</div><div></div></div><div><div>Drawer on Right</div><div></div></div></div> <div>JZBSO</div> <div></div> <div>2 x</div>	
<div><div>Drawer on Left</div><div></div></div> <div><div>Drawer on Right</div><div></div></div>	2 x
<div><div></div></div> <div>JZBFF</div> <div></div> <div>2 x</div>	
<div><div><div>48" to 60" w</div><div></div></div><div><div>66" – 84" w</div><div></div></div></div> <div>JZBSM</div> <div></div> <div>2 x</div>	

JZBDO

2 x

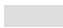
 Lockable Double Doors  Lockable Single Door  Lockable Single Drawer

ez suspended shelf basics

The EZ Suspended Shelf are fixed between two EZ Fence Legs and provides open storage below an EZ Fence Beam.

- The dimensions listed are actuals
- **Cannot** be installed on EZ Fence Legs – Low Height (JZSFL)

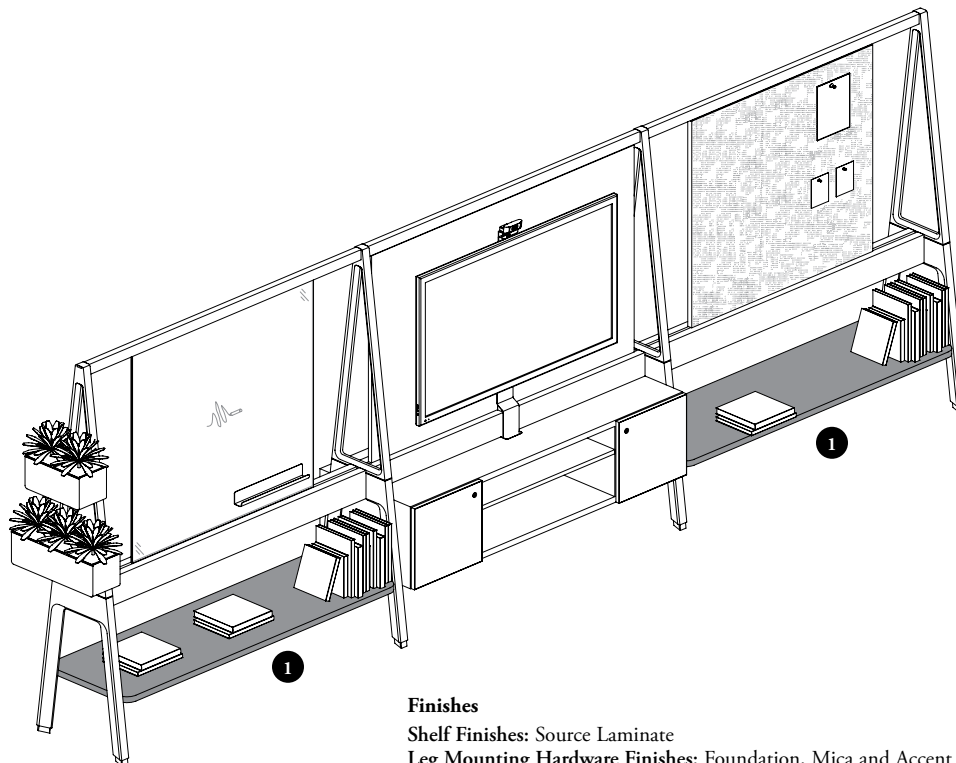

Finishes

Shelf Finishes: Source Laminate

Leg Mounting Hardware Finishes: Foundation, Mica and Accent

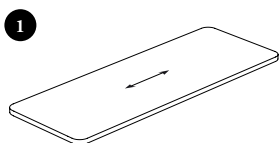

EZ Suspended Shelf – Solid (JZBSH)

- Available 1" thick and two-sided finished
- Only available with 2" radius corners
- Available 18" deep only
- Widths include 48" – 84" (6" increments)
- Can be used under EZ Structural Beam (JZSBB) or Chicago EZ Structural Beam (JZSCB) and fixed between two EZ Fence Legs (JZSFS)

EZ Suspended Shelf Position

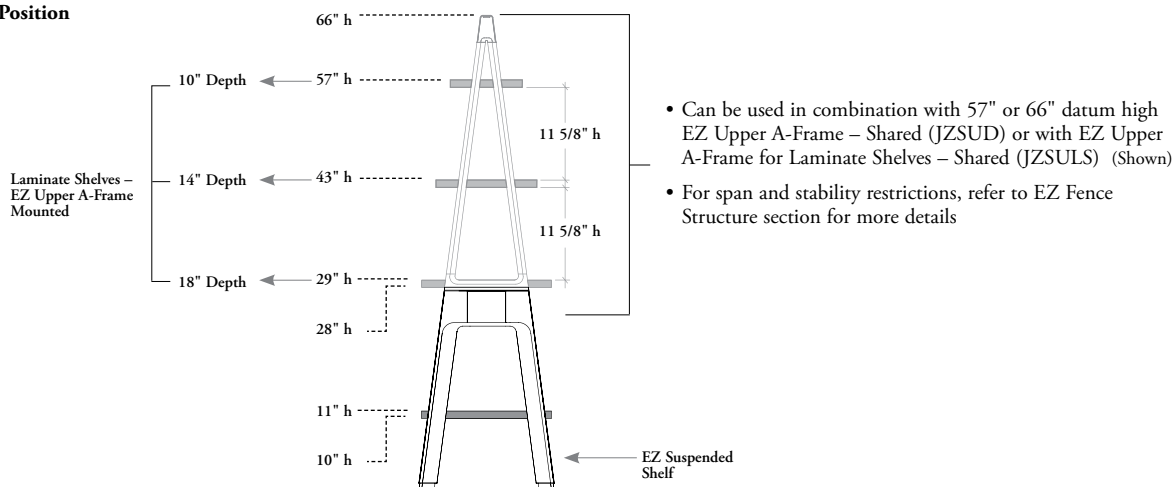

grain direction – ez suspended storage

Below is the grain direction applied on EZ Suspended Storage. Attention the grain direction is important when planning with EZ Suspended Storage.

- Grain/patterns are **not** "centered" on storage unit and shelves
- Includes Source and Foundation Laminate (Standard, Finegrain and Straightgrain)
- The following examples demonstrate this. Laminates **do not** have one-way grain direction but rather a bi-directional grain pattern

es suspended credenzas – shared

Same thing each side

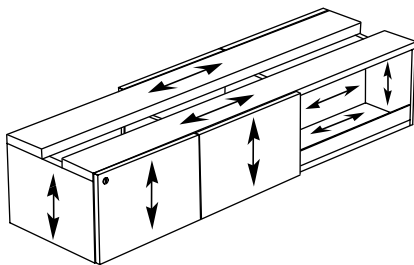

ez suspended credenzas – single-sided

Front

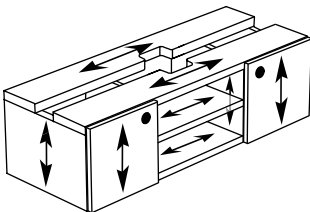
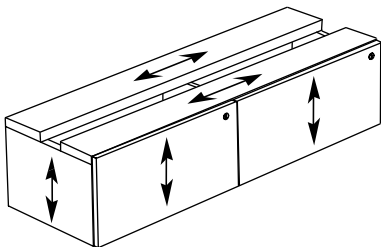

Back

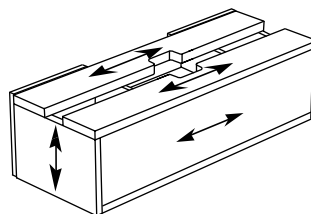

suspended shelf

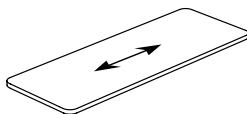

Laminate Grains \longleftrightarrow = Grain Direction = 