

base cabinets

Xpress

CEBCBS

Base Cabinet for Blind Corner – Door

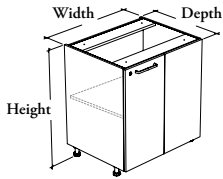

WHAT'S INCLUDED

1 base cabinet, adjustable feet, clips for toe kick – front, pull (as specified), locks and keys (as specified), mounting hardware and 1 adjustable shelf.

WHAT'S EXCLUDED

Countertop (CEWCT), Toe Kick – Front (CEATF) and Toe Kick – Side (CEATS).

NOTES

32" high cabinet is suitable for People with Reduced Mobility.

When Flintwood Door and Fixed Panel Front Finish is specified, only Not Applicable (NA) Edge Trim Finish is available.

When Stainless (8) or Drilled On-Site – No Pull (Z) Pull Style is specified, Pull Finish is **not** available.

Shelf(ves) are 24" deep for all cabinet depths.

The Fixed Panel is always half the width of the cabinet.

Holes at 1 1/4" intervals allow for shelf adjustment.

Additional Shelves for Cabinet (CEACS) are available and must be specified separately.

Xpress See *Xpress Program* and/or specification software for finishes availability.

PRODUCT OPTIONS

Depth	Width	Height	Fixed Panel Position	Hinge Style	Door & Fixed Panel Front Finish
24, 29	24, 27, 30, 33, 36	32, 35	L Fixed Panel – Left R Fixed Panel – Right (Shown)	S Standard – Soft Close	Source Laminate Foundation Laminate Grade 2 Laminate Flintwood (No Cathedral)

SAMPLE ORDER CODE

CEBCBS 24	30	35	L	S	3G
------------------	-----------	-----------	----------	----------	-----------

PRODUCT OPTIONS CONTINUED

Edge Trim Finish	Case Finish	Pull Style		Pull Finish (If Applicable)	Key Style
Edge Trim Colors NA Not Applicable	Source Laminate	1 Standard Expansion 8 Stainless (ADA) 9 Rectangular E Edge – Standard	F Edge – Small M Modern Straight (ADA) S Slim (Shown) Z Drilled On-Site – No Pull	Foundation Accent Mica	K Keyed Alike R Keyed Randomly N No Lock

SAMPLE ORDER CODE CONTINUED

4G	3G	S	52	N
-----------	-----------	----------	-----------	----------

See Pricing on the following page.

C E B C B S

**Base Cabinet for Blind Corner –
Door (Continued)**

**DIMENSIONS
INCHES / MM**

D	W	H
24 / 610	24 / 610	32 / 813
24 / 610	27 / 686	32 / 813
24 / 610	30 / 762	32 / 813
24 / 610	33 / 838	32 / 813
24 / 610	36 / 914	32 / 813
24 / 610	24 / 610	35 / 889
24 / 610	27 / 686	35 / 889
24 / 610	30 / 762	35 / 889
24 / 610	33 / 838	35 / 889
24 / 610	36 / 914	35 / 889
29 / 737	24 / 610	32 / 813
29 / 737	27 / 686	32 / 813
29 / 737	30 / 762	32 / 813
29 / 737	33 / 838	32 / 813
29 / 737	36 / 914	32 / 813
29 / 737	24 / 610	35 / 889
29 / 737	27 / 686	35 / 889
29 / 737	30 / 762	35 / 889
29 / 737	33 / 838	35 / 889
29 / 737	36 / 914	35 / 889

PRICING

LEFT (F) OR RIGHT (R) FIXED PANEL			
DOOR & FIXED PANEL FRONT FINISH			
Source Laminate	Foundation Laminate	Grade 2 Laminate	Flintwood
983	1107	1262	1249
1021	1160	1317	1303
1059	1214	1343	1329
1095	1265	1399	1385
1133	1318	1463	1448
1018	1155	1306	1293
1056	1210	1363	1349
1096	1267	1389	1375
1133	1321	1450	1435
1173	1378	1519	1503
1020	1144	1299	1286
1060	1199	1356	1342
1100	1255	1384	1370
1138	1308	1443	1428
1177	1362	1507	1492
1066	1203	1355	1341
1107	1261	1414	1400
1149	1320	1443	1428
1188	1376	1505	1490
1230	1435	1576	1560