

finishing components

Xpress

CEATF

Toe Kick – Front

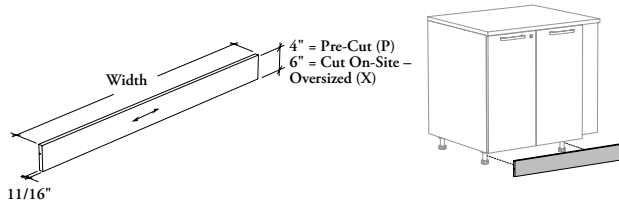

WHAT'S INCLUDED

1 toe kick.

NOTES

Cut On-Site – Oversize (X) configuration is 6" high and is recommended to ensure a gap-free, perfect fit once the cabinets are installed and leveled.

To determine the correct Toe Kick Width and to minimize on-site cutting, refer to the Application Guide.

Mounting Clips are provided with Base Cabinets to ensure the right quantity of clips is included.

When Flintwood Toe Kick Finish is specified, only Not Applicable (NA) Edge Trim Finish is available.

Compatible with all Base Cabinets except for:

- Base Cabinet for Sink – People with Reduced Mobility – Doors (CEBKRS)
- Base Cabinet for Sink – People with Reduced Mobility – Open (CEBKRO)

Compatible with all Storage Cabinets except for:

- Countertop – Microwave Section(s) and Doors (CECM)
- Recycling/Disposal Unit – Standard Bins (CESRUS)
- Recycling/Disposal Unit – XL Bins (CESRUX)

Xpress See *Xpress Program* and/or specification software for finishes availability.

PRODUCT OPTIONS

Cabinet Toe Kick Height	Toe Kick Height Configuration	Width	Toe Kick Finish	Edge Trim Finish
04	P Pre-Cut X Cut On-Site – Oversized	011, 012, 013, 014, 015, 016, 017, 018, 019, 020, 021, 022, 023, 024, 025, 026, 027, 028, 029, 030, 031, 032, 033, 034, 035, 036, 037, 038, 039, 040, 041, 042, 043, 044, 045, 046, 047, 048, 049, 050, 051, 052, 053, 054, 055, 056, 057, 058, 059, 060, 061, 062, 063, 064, 065, 066, 067, 068, 069, 070, 071, 072, 073, 074, 075, 076, 077, 078, 079, 080, 081, 082, 083, 084, 085, 086, 087, 088, 089, 090, 091, 092, 093, 094, 095, 096, 097, 098, 099, 100, 101, 102, 103, 104, 105, 106, 107	Source Laminate Foundation Laminate Grade 2 Laminate Flintwood (No Cathedral)	Edge Trim Colors NA Not Applicable

SAMPLE ORDER CODE

CEATF 04	P	060	XG	SS
-----------------	----------	------------	-----------	-----------

DIMENSIONS INCHES / MM

PRICING

W	4" CABINET TOE KICK HEIGHT							
	PRE-CUT (P)				CUT ON-SITE OVERSIZED (X)			
	Source Laminate	Foundation Laminate	Grade 2 Laminate	Flintwood	Source Laminate	Foundation Laminate	Grade 2 Laminate	Flintwood
11 / 279	21	29	37	140	23	31	39	147
12 / 305	21	30	39	143	24	33	42	150
13 / 330	22	32	42	145	25	35	45	153
14 / 356	23	34	44	147	26	37	47	156
15 / 381	24	35	47	150	27	38	50	159
16 / 406	24	36	48	152	28	40	52	162
17 / 432	25	38	51	154	29	42	55	165
18 / 457	26	40	53	156	30	44	57	168
19 / 483	27	41	56	159	31	45	60	171
20 / 508	28	42	57	162	33	47	62	175
21 / 533	29	44	60	164	34	49	65	178
22 / 559	30	46	62	167	35	51	67	181
23 / 584	31	48	65	169	36	53	70	184
24 / 610	31	48	67	171	37	54	73	187
25 / 635	32	50	69	174	37	55	74	190
26 / 660	33	52	72	176	38	57	77	193
27 / 686	34	54	74	178	39	59	79	196
28 / 711	34	55	76	180	40	61	82	199

Pricing is continued on the following page.

C E A T F

Toe Kick – Front (Continued)

**DIMENSIONS
INCHES / MM**

PRICING

4" CABINET TOE KICK HEIGHT

PRE-CUT (P)

TOE KICK FINISH

W	Source Laminate	Foundation Laminate	Grade 2 Laminate	Fintwood
29 / 737	35	56	78	183
30 / 762	36	58	81	185
31 / 787	37	60	83	187
32 / 813	37	61	85	190
33 / 838	38	62	87	192
34 / 867	39	64	90	194
35 / 889	40	66	93	197
36 / 914	40	67	94	199
37 / 940	41	69	97	201
38 / 965	42	70	99	203
39 / 991	44	72	102	207
40 / 1016	45	74	104	209
41 / 1041	45	75	106	211
42 / 1067	46	77	108	214
43 / 1092	47	78	111	216
44 / 1118	48	80	113	218
45 / 1143	48	81	115	220
46 / 1168	49	83	118	223
47 / 1194	50	84	120	225
48 / 1219	51	86	123	227
49 / 1245	51	87	124	230
50 / 1270	52	89	127	232
51 / 1295	53	91	129	234
52 / 1321	54	92	132	237
53 / 1346	54	93	133	239
54 / 1372	55	95	136	241
55 / 1397	56	97	138	243
56 / 1422	57	99	141	246
57 / 1448	57	99	143	248
58 / 1473	59	101	145	251
59 / 1499	60	103	148	254
60 / 1524	61	105	150	256
61 / 1549	61	105	152	258
62 / 1575	62	107	154	261
63 / 1600	63	109	157	263
64 / 1626	64	111	159	265
65 / 1651	64	112	161	267
66 / 1676	65	113	163	270
67 / 1702	66	115	166	272
68 / 1727	67	117	169	274
69 / 1753	67	118	170	277
70 / 1778	68	120	173	279
71 / 1803	69	121	175	281
72 / 1829	70	123	178	283
73 / 1854	70	124	179	286
74 / 1880	71	126	182	288
75 / 1905	72	127	184	290
76 / 1930	73	129	187	293
77 / 1956	74	130	188	296
78 / 1981	75	132	191	298

CUT ON-SITE OVERSIZED (X)

Source Laminate	Foundation Laminate	Grade 2 Laminate	Fintwood
41	62	84	202
42	64	87	205
43	66	89	208
44	68	92	211
45	69	94	214
46	71	97	217
47	73	100	220
48	75	102	223
49	77	105	226
50	78	107	229
51	79	109	233
52	81	111	236
53	83	114	239
54	85	116	242
55	86	119	245
56	88	121	248
57	90	124	251
58	92	127	254
59	93	129	257
60	95	132	260
61	97	134	263
62	99	137	266
63	101	139	269
64	102	142	272
65	104	144	275
65	105	146	278
66	107	148	281
67	109	151	284
68	110	154	287
70	112	156	291
71	114	159	294
72	116	161	297
73	117	164	300
74	119	166	303
75	121	169	306
76	123	171	309
77	125	174	312
78	126	176	315
79	128	179	318
80	130	182	321
80	131	183	324
81	133	186	327
82	134	188	330
83	136	191	333
84	138	193	336
85	140	196	339
86	141	198	342
87	143	201	345
89	145	203	349
90	147	206	352

Pricing is continued on the following page.

finishing components

Xpress

CEATF

Toe Kick – Front (Continued)

DIMENSIONS
INCHES / MM

PRICING

W	4" CABINET TOE KICK HEIGHT							
	PRE-CUT (P)				CUT ON-SITE OVERSIZED (X)			
	TOE KICK FINISH							
	Source Laminate	Foundation Laminate	Grade 2 Laminate	Fintwood	Source Laminate	Foundation Laminate	Grade 2 Laminate	Fintwood
79 / 2007	76	134	194	301	91	149	209	355
80 / 2032	77	135	196	303	92	150	211	358
81 / 2057	78	137	199	305	93	152	214	361
82 / 2083	78	138	200	307	94	154	216	364
83 / 2108	79	140	203	310	95	156	219	367
84 / 2134	80	142	205	312	95	157	220	370
85 / 2159	81	143	208	314	96	158	223	373
86 / 2184	81	144	209	317	97	160	225	376
87 / 2210	82	146	212	319	98	162	228	379
88 / 2235	83	148	214	321	99	164	230	382
89 / 2261	84	149	217	324	100	165	233	385
90 / 2286	84	150	219	326	101	167	236	388
91 / 2311	85	152	221	328	102	169	238	391
92 / 2337	86	154	224	330	103	171	241	394
93 / 2362	87	156	226	333	104	173	243	397
94 / 2388	87	156	228	335	105	174	246	399
95 / 2413	88	158	230	337	106	176	248	402
96 / 2438	90	160	233	341	108	178	251	406
97 / 2464	91	162	235	343	109	180	253	409
98 / 2489	91	163	237	345	109	181	255	412
99 / 2515	92	164	239	347	110	182	257	415
100 / 2540	93	166	242	350	111	184	260	418
101 / 2565	94	168	245	352	112	186	263	421
102 / 2591	94	169	246	354	113	188	265	424
103 / 2616	95	170	249	357	114	189	268	427
104 / 2642	96	172	251	359	115	191	270	430
105 / 2667	97	174	254	361	116	193	273	433
106 / 2692	97	175	255	364	117	195	275	436
107 / 2718	98	177	258	366	118	197	278	439