

storage for secondary desk basics

Expansion Casegoods offers storage options for Secondary Desk Applications. The storage attaches under a secondary desk and provides additional storage and stability to the workstation.

All dimensions in this section are nominal

- ❗ Must be mounted under a 20" or 24" deep Low or High Secondary Desk (B_MSD, BH_SR, BH_SB or BH_SL) only
- Can be specified Center (C) or End (M or X) position – worksurface thicknesses as secondary desks
- Door and Drawer Fronts come with Rectilinear Pulls (9) only. The pulls are flush with front of gable
- The end position must be specified next to a secondary desk gable in order compensate its thickness creepage
- All storage products include levelers with a minimum adjustment range of 1"

Depth Storage for Secondary Desk

Depth varies when specified in-front or not in-front of Height-Adjustable Mechanism:

In Front of Height-Adjustable Mechanism (No):

- 20" or 24" Secondary Desk depth = 18" storage depth

In Front of Height-Adjustable Mechanism (Yes) (Shown):

- 20" Secondary Desk depth = 12" storage depth
- 24" Secondary Desk depth = 16" storage depth

The storage depth is smaller to clear the Height-Adjustable Mechanism

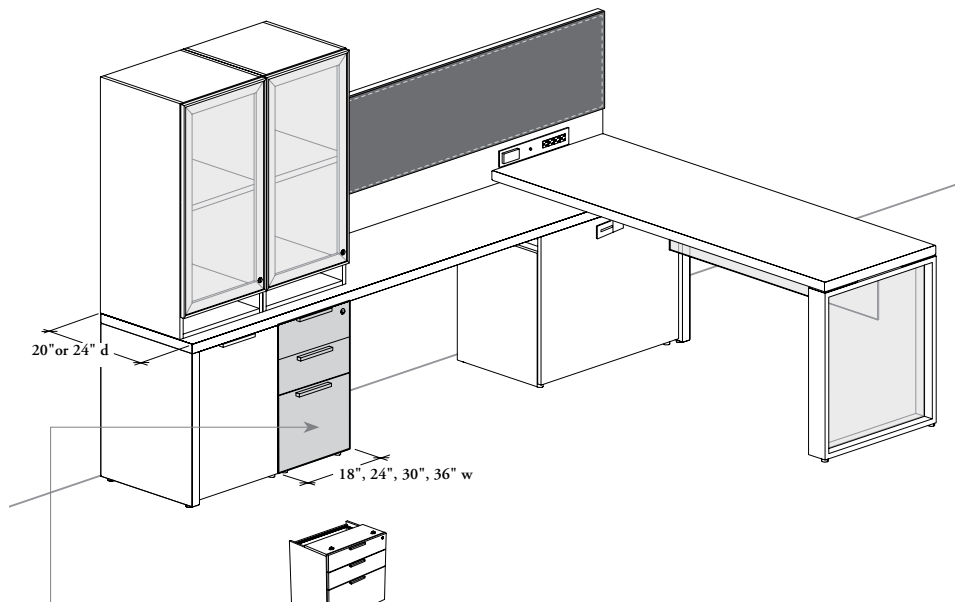

Stretch Pedestal – Secondary Desk (BSSP)

- Provides closed storage under a High (H) Secondary Desk
- For an ergonomic and accessibility reasons, it is **not** recommended to use this storage under a worksurface perpendicular to a high secondary desk
- **Cannot** be specified in front of Height-Adjustable Mechanism (N)
- Has a central locking system and full extension drawers that can accommodate both letter- and legal-size paper
- Box drawer include an anodized pencil tray with mounting brackets. File drawer includes one or two 15" cross file bar(s)

Supporting Brackets

- Two supporting brackets are provided with all storage for secondary desk
- Mount to the underside of a secondary desk and to the top of a storage for secondary desk to provide additional support to secondary desk
- The supporting brackets are finished in Recycled Paint

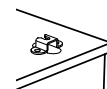

storage for secondary desk basics (continued)

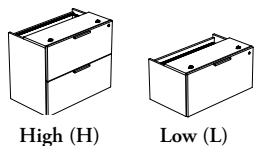
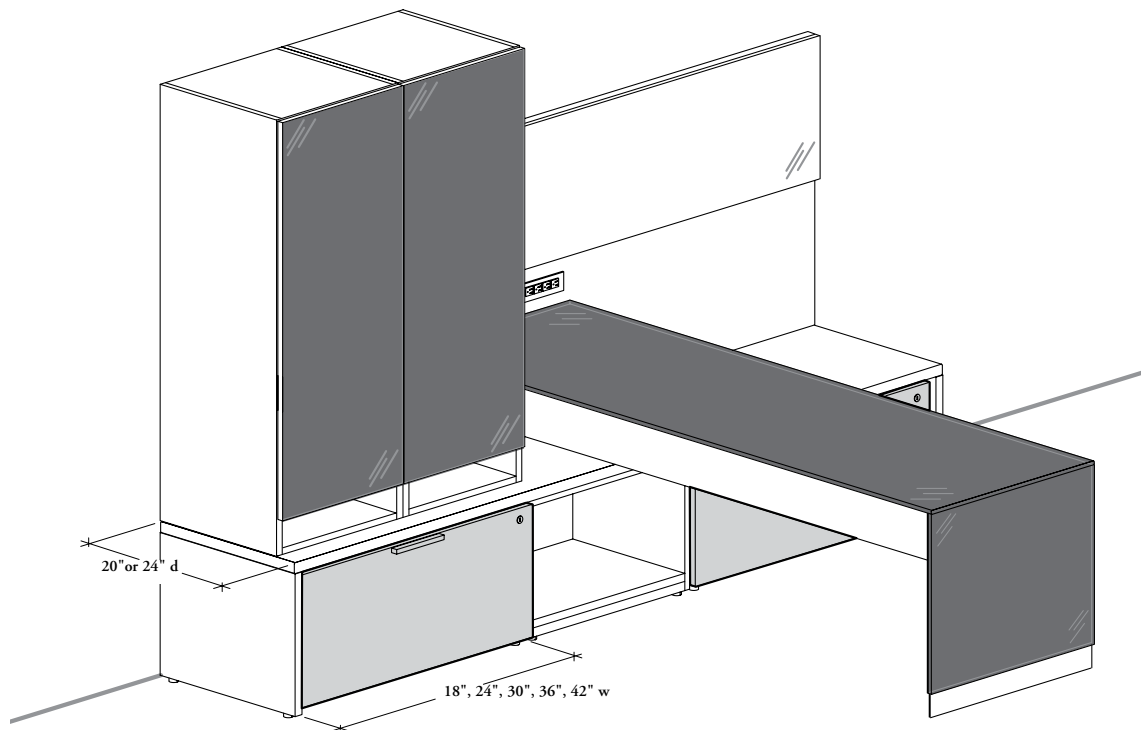

Lateral File – Secondary Desk (BSSL)

- Provides closed storage under a **High (H) or Low (L)** Secondary Desk
- Must be specified the same height than the secondary desk
- For a ergonomic and accessibility reasons, it is **not** recommended to used this storage under a worksurface perpendicular to a high or low secondary desk
- **Cannot** be specified in front of Height-Adjustable Mechanism (N)
- When a 30" wide Lateral File for Secondary Desk – End Position (M or X) is specified, it **cannot** accommodate side-to-side filing
- When a 42" wide Lateral File for Secondary Desk is specified, only End Position (M or X) is available and the file drawer width will be reduced by 6"
- Provides full extension slides that can accommodate both letter- and legal-size paper
- Equipped with an interlock system that prevents opening more than one drawer at a time (high version only)
- File drawer includes one or two 15" cross file bar(s)

storage for secondary desk basics (continued)

⚠ Storage for Secondary Desk is mandatory in front a Height-Adjustable Mechanism (Y), if a Open Section Cover (BSSCM) is not specified

Bookcase – Secondary Desks (BSSO)

- Provides open storage under a **High (H)** or **Low (L)** Secondary Desk
- Must be specified the same height than the secondary desk
- Can be used as a passive storage under a worksurface perpendicular to a low or high secondary desk
- Can be specified under a Run-Off, Run-Off with Glass Top, Overlapping Bridge or Height-Adjustable Worksurface. When specified, the storage allows to hide the Height-Adjustable Mechanism
- Can be specified under a Height-Adjustable Worksurface or return. When specified, the storage allows to hide the Height-Adjustable Mechanism
- Two height styles are available:

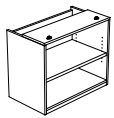

High (H)

- Must be specified under **High (H)** Secondary Desk only
- Comes with one adjustable shelf
- Adjustable shelf configurations has five holes in 1 1/4" intervals on the inside walls for shelf height adjustment
- The high version will **not** allow two rows of standard letter-size binders
- Additional shelves **cannot** be specified separately

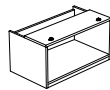

Low (L)

- Must be specified under **Low (L)** Secondary Desk only
- Comes with one open compartment

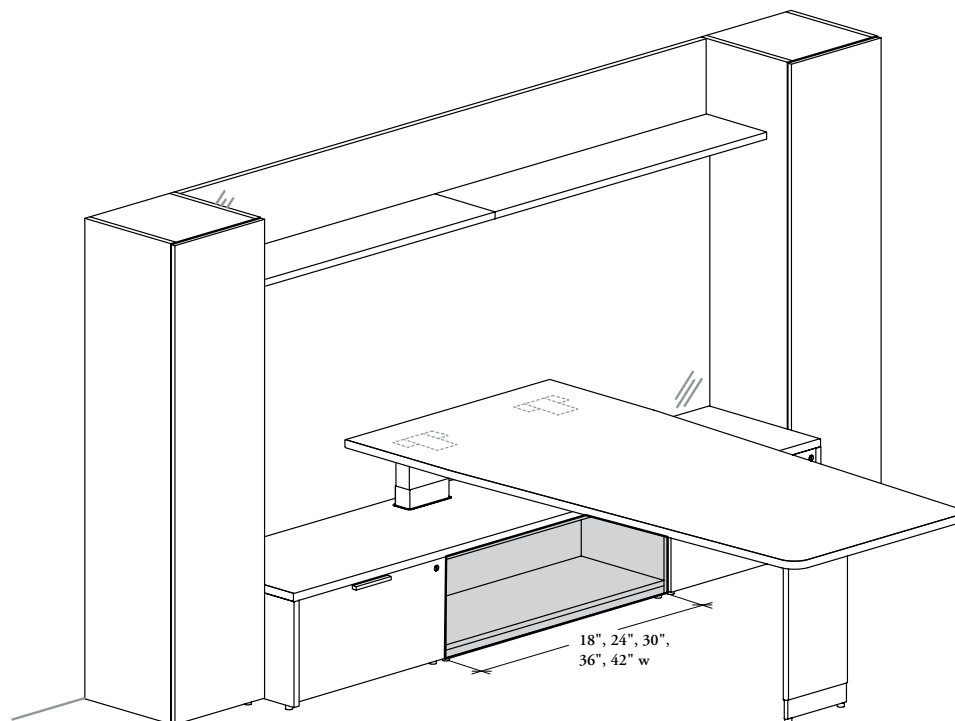

storage for secondary desk basics (continued)

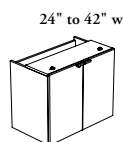
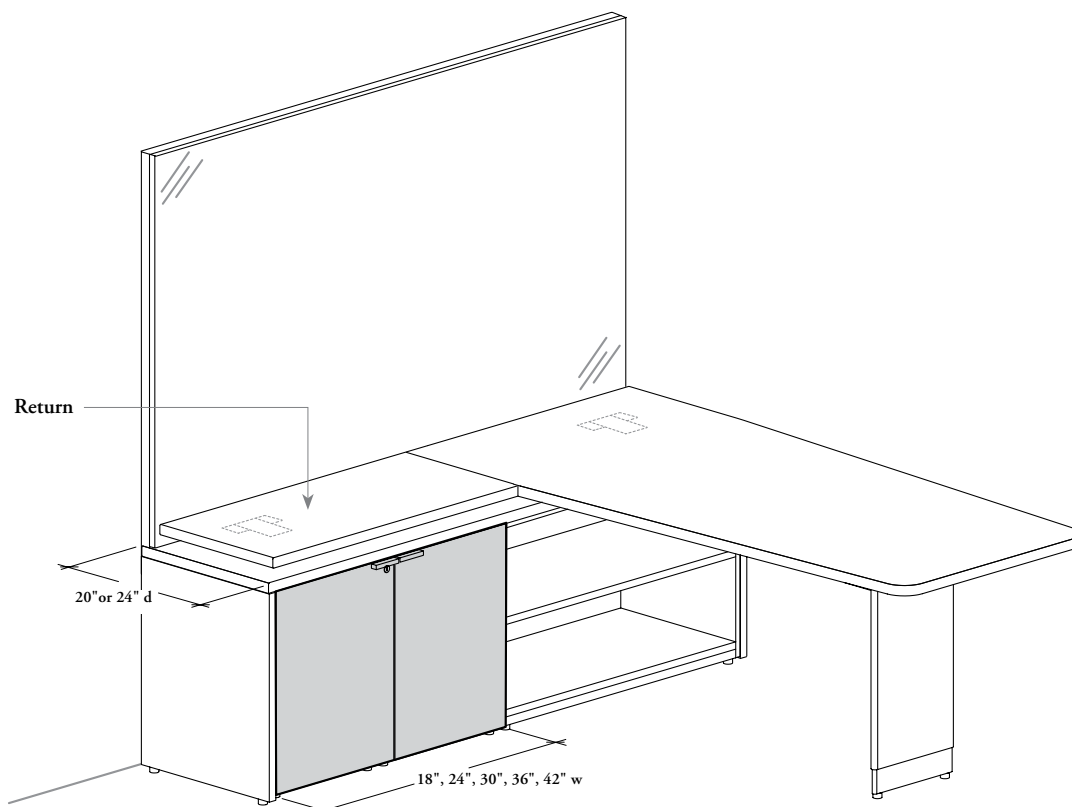

Storage Cabinet – Secondary Desk (BSSD)

- Provides closed storage under a **High (H)** Secondary Desk only
- Can be used as a passive storage under a worksurface perpendicular to a high secondary desk
- Can be specified under a Run-Off, Run-Off with Glass Top, Overlapping Bridge or Height-Adjustable Worksurface. When specified, the storage allows to hide the Height-Adjustable Mechanism
- For an ergonomic and accessibility reasons, it is **not** recommended to use this storage under a worksurface perpendicular to a high secondary desk
- Hinges allow the door to open up to 120°
- Comes with one adjustable shelf
- Additional shelves **cannot** be specified separately
- Adjustable shelf configurations have five holes in 1 1/4" intervals on the inside walls for shelf height adjustment
- This product will **not** allow storing two rows of standard letter-size binders
- 24" to 42" wide cabinets come with two doors. Only **Not Applicable (N)** Door Swing Direction is available
- Only 18" wide cabinet comes with one door. Left (Shown) or Right swing direction must be specified

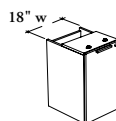

storage for secondary desk basics (continued)

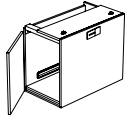

Multi-Functional Storage – Secondary Desk (BSSM)

- Provides closed storage under a High (H) Secondary Desk only. It can be used to hide a personal computer tower or a recycling bin
- Must be used as a passive storage under a worksurface perpendicular to a high secondary desk
- Can be specified under a Run-Off, Run-Off with Glass Top, Overlapping Bridge or Height-Adjustable Worksurface. When specified, the storage allows to hide the Height-Adjustable Mechanism
- Comes with one rectangular grommet on the front and one ventilation slot with ring on the back
- Can be specified left or right and needs 24" of nominal clear space to allow full door opening
- Hinged doors have no pull and no touch latch. They can be handled with the fingertips
- Shorter door acts as a paper slot
- Hinges allow the door to open up to 120°
- A single Multi-Functional Drawer will **not** disable the opening of the door but will block the paper slot

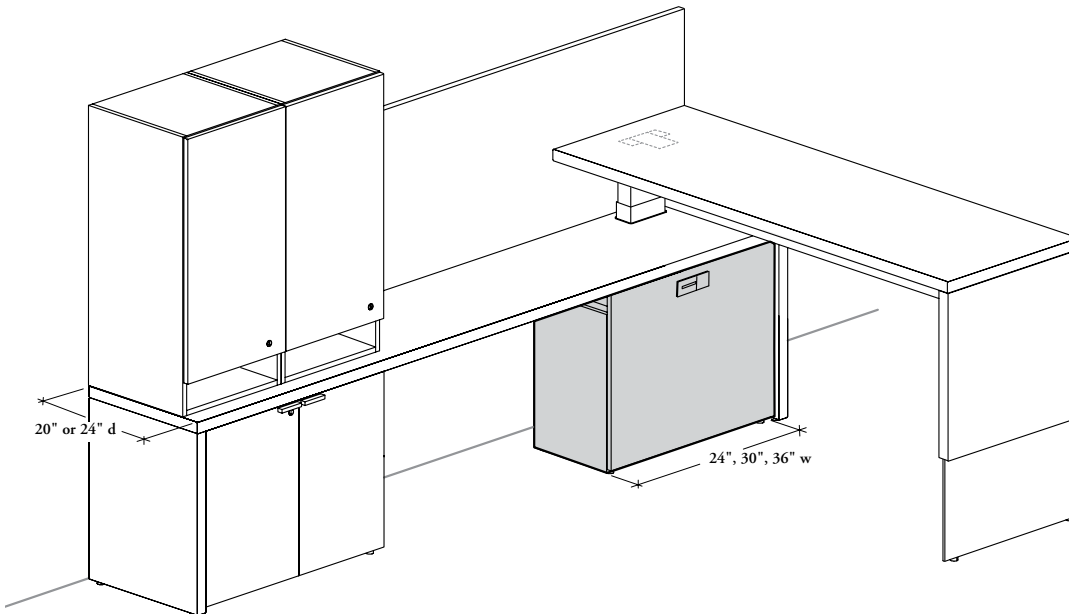

storage for secondary desk basics (continued)

Recycling/Waste Cabinet – Secondary Desk (BSSRW)

- Provides closed recycling and/or waste bin storage under a **High (H)** or **Low (L)** Secondary Desk
- For an ergonomic and accessibility reasons, it is **not** recommended to used this storage under a worksurface perpendicular to a high or low secondary desk
- Can be specified in front of Height-Adjustable Mechanism of height-adjustable return
- Comes with one flip-down door.
- Door have a pull and is **not** lockable

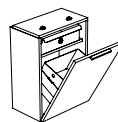

High (H)

- Must be specified under **High (H)** Secondary Desk only
- Comes with one Recycling Bin, one Waste Bin and one Fixed Shelf

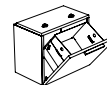

Low (L)

- Must be specified under **Low (L)** Secondary Desk only
- Comes with one Waste Bin only

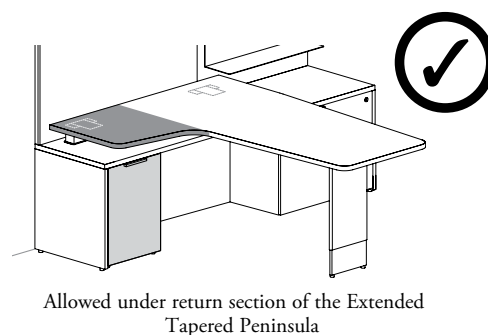
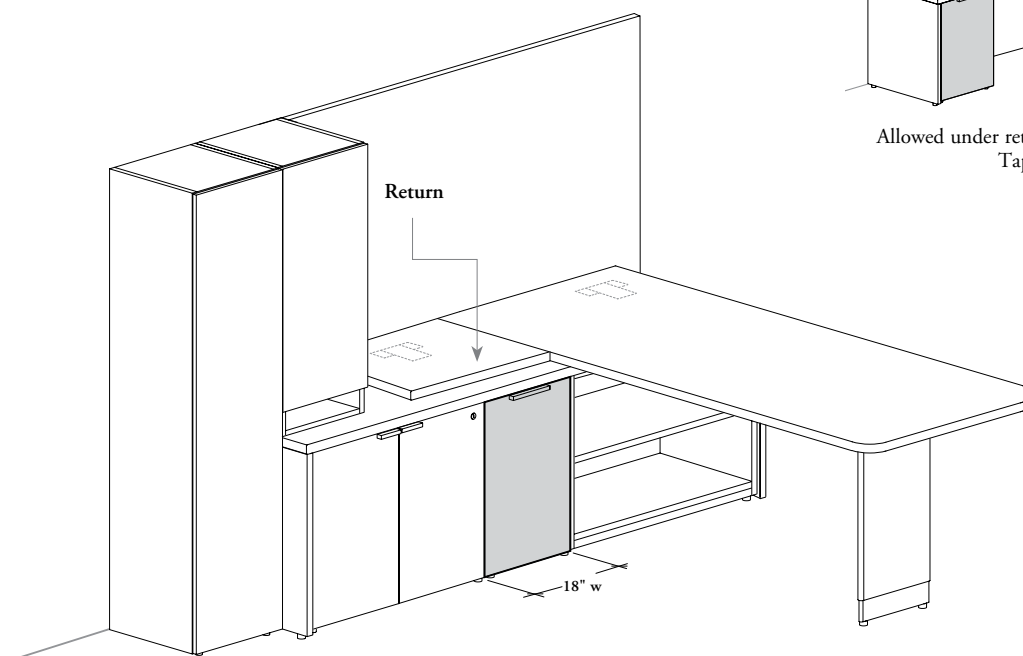

Opening Door Configurations

- With high configuration, the hinges allow the door to open up to 30°
- With low configuration, the hinges allow the door to open up to 40°

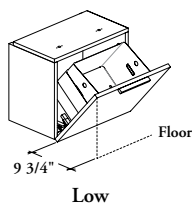
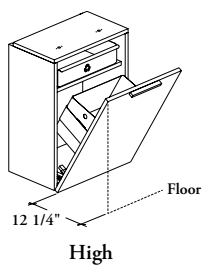

Recycling and Waste Bins Anatomy

Waste bin require a 20" wide x 12" hide bag (13 Liter Capacity) for a true fit. Waste bin include side detail to manage the excess of bag is used

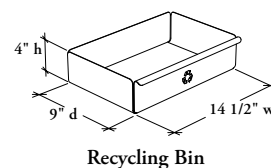
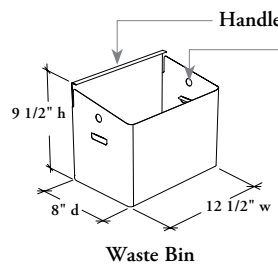

storage for secondary desk basics (continued)

- ❗ Open Section Cover – Secondary Desk is mandatory under a Height-Adjustable Worksurfaces, if a Storage for Secondary Desk (BSSO, BSSM, BSSD or BSSRW) is **not** specified
- Can be specified High (H) or Low (L) under Secondary Desk for Height-Adjustable Worksurfaces (BH_SR, BH_SB or BH_SL) only
- Width Reduction (M or X) must be specified for End – Off-Module (E) and Full Secondary Desk Width Position (F) in order to compensate the secondary desk gable(s) thickness creepage
- When Center Position (C) is specified, only None (N) Width Reduction is available
- Can be installed under the secondary desk alone or combined with other Storage for Secondary Desk

Open Section Cover – Secondary Desk (BSSCM)

- Can be used under a Secondary Desk to provide a continuous aesthetic
- Can hide the height-adjustable mechanism and provides a finishing element under a Secondary Desk
- 1" thick laminate panel

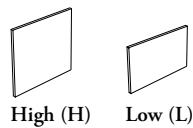

end – off-module configuration (E)

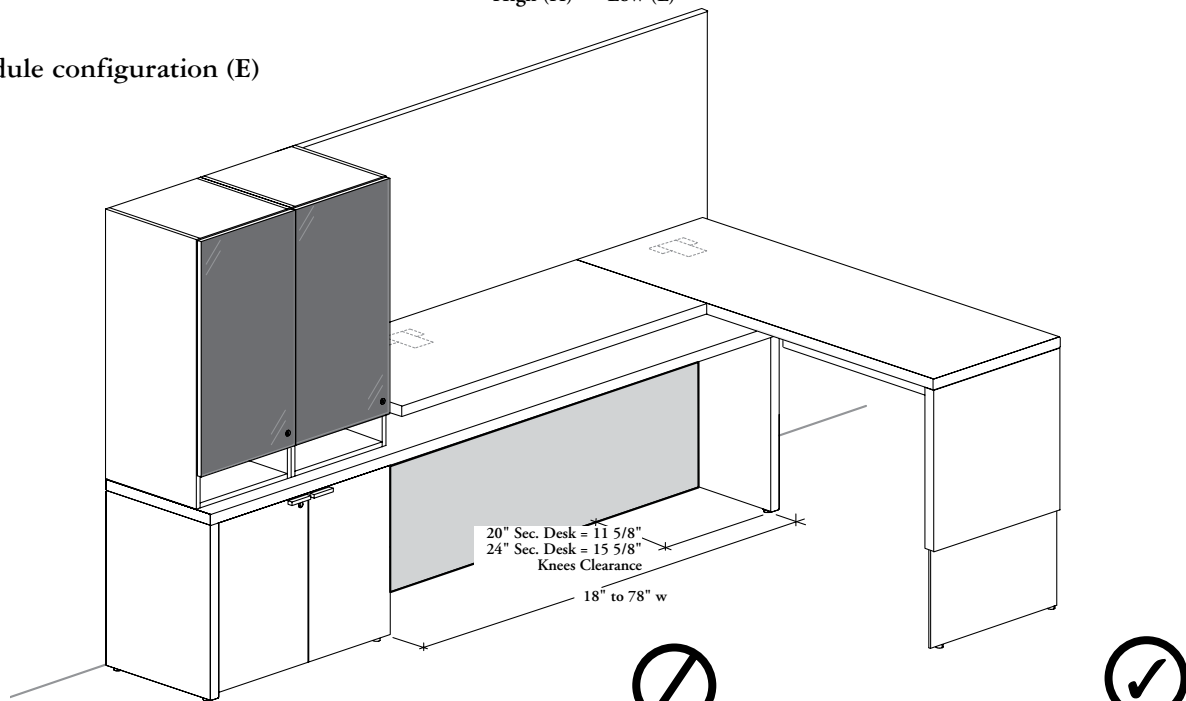

Restrictions

- A minimum 6" wide clearance must be preserved to allow the opening door of a Multi-Functional Storage – Secondary Desk (BSSM)
- For more details on Storage for Desk Applications, refer to page 413

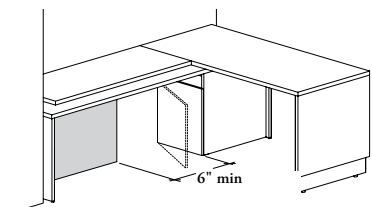
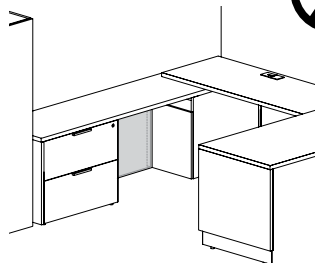

A nominal 24" of clear space is needed to allow full door opening of a Multi-Functional Storage. A Multi-Functional Drawer can be installed in this free space

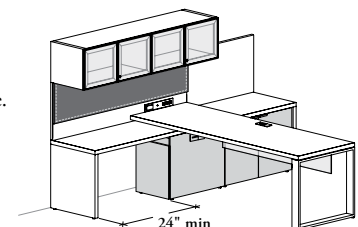

storage for secondary desk basics (continued)

center (C)

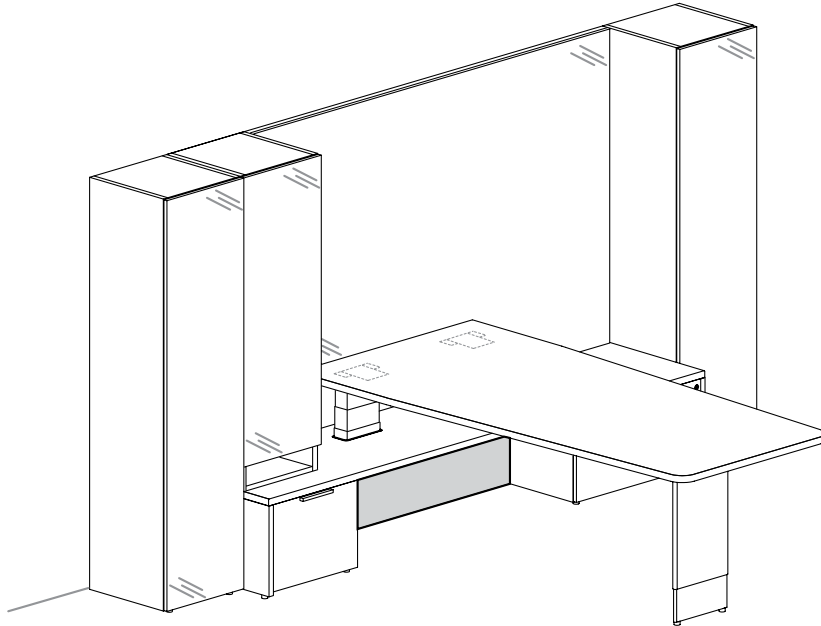

full secondary desk width (F)

When Full Secondary Desk Width (F) is specified, only 60" to 78" wide panel are available

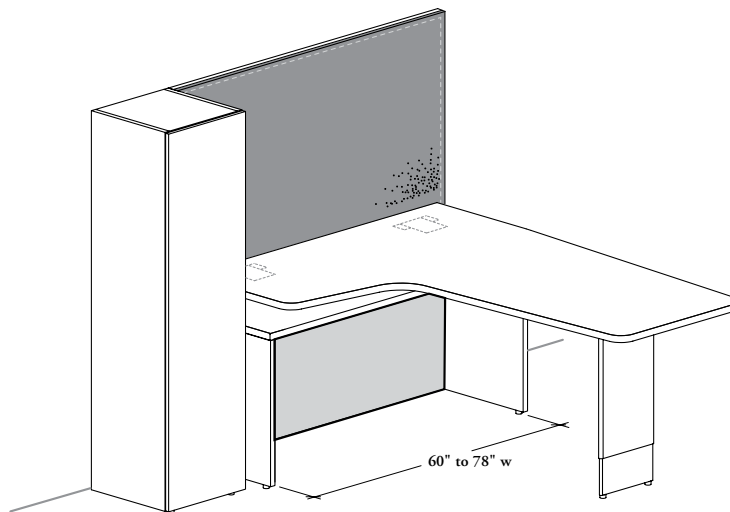

lateral file for secondary desk – center position – filing drawer capacities

Lateral file drawer storage capacities are shown below.

⚠ The dimensions listed below are inside drawer

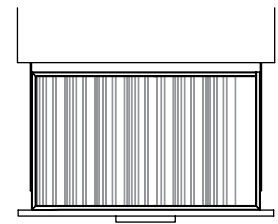
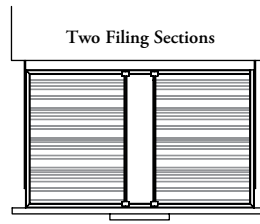
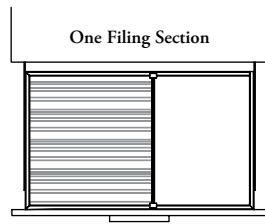

Front-to-Back

Front-to-Back

Side-to-Side

18" wide drawer

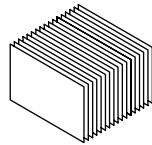
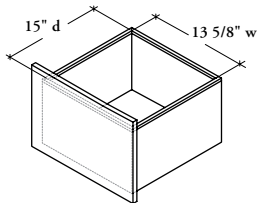

Paper Size Allowed:

- Letter
- A4

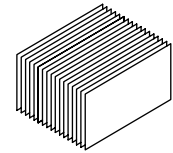

Paper Size Allowed:

- Legal

24" wide drawer

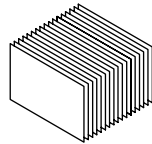
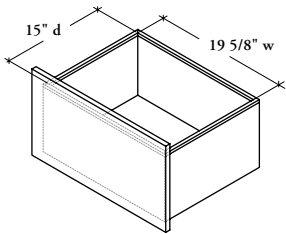

Paper Sizes Allowed:

- Letter
- A4
- Legal

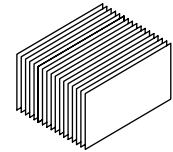

Paper Sizes Allowed:

- Letter*
- A4*
- Legal

30" wide drawer

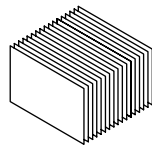
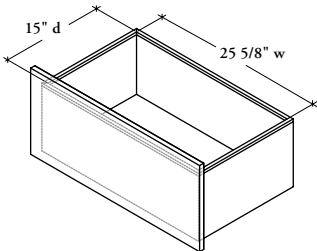

Paper Sizes Allowed:

- A4
- Legal

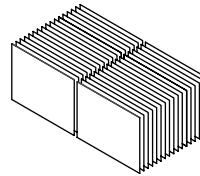

Paper Size Allowed:

- Letter

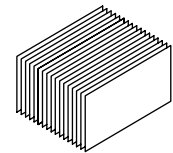

Paper Sizes Allowed:

- Letter*
- A4*
- Legal

36" wide drawer

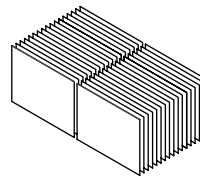
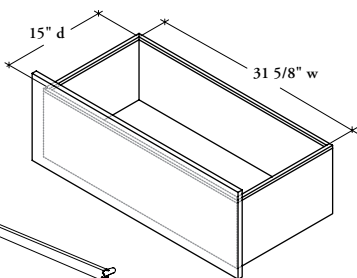

Paper Sizes Allowed:

- Letter
- A4
- Legal

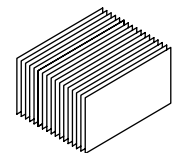

Paper Sizes Allowed:

- Letter*
- A4*
- Legal

* The Letter or A4 paper size is allowed but require optional Hanging File Bar (RSLB)

lateral file for secondary desk – end position – 1 3/16" work. thickness – filing drawer capacities

Lateral file drawer storage capacities are shown below.

! The dimensions listed below are inside drawer

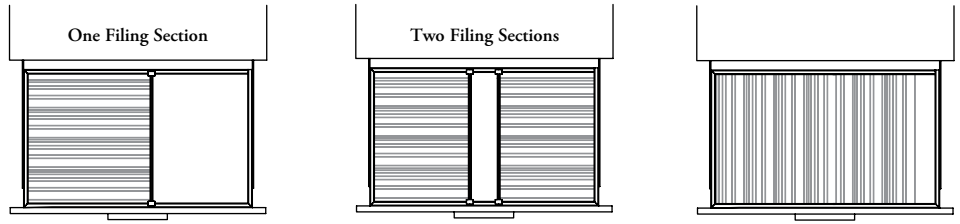

Front-to-Back

Front-to-Back

Side-to-Side

18" wide drawer

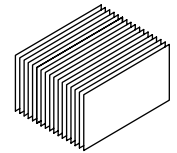
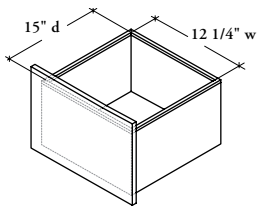

Paper Size Allowed:
• Legal

24" or 30" wide drawers

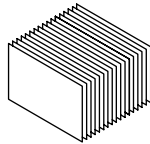
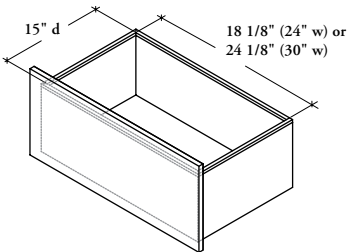

Paper Sizes Allowed:
• Letter
• A4
• Legal

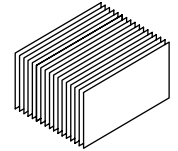

Paper Size Allowed:
• Legal

36" wide drawer

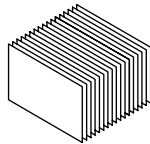
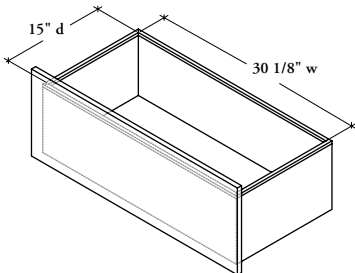

Paper Size Allowed:
• Legal

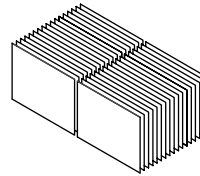

Paper Sizes Allowed:
• Letter
• A4

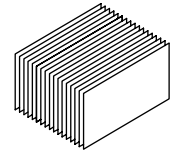

Paper Size Allowed:
• Legal

42" wide drawer

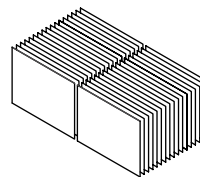
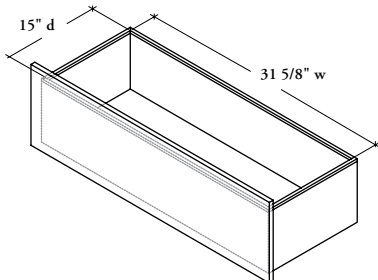

Paper Sizes Allowed:
• Letter
• A4
• Legal

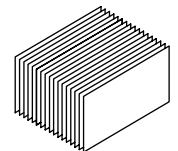

Paper Sizes Allowed:
• Letter**
• A4**
• Legal

** The Letter or A4 paper size is allowed but require optional 36" Hanging File Bar (RSLB36)

lateral file for secondary desk – end position – 1 9/16" work. thickness – filing drawer capacities

Lateral file drawer storage capacities are shown below.

! The dimensions listed below are inside drawer

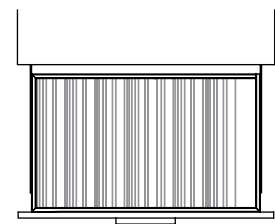
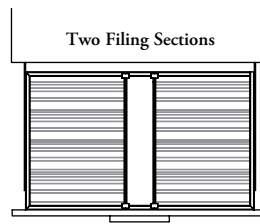
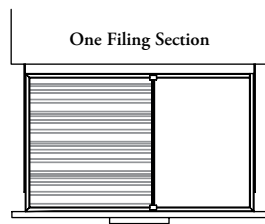

Front-to-Back

Front-to-Back

Side-to-Side

18" wide drawer

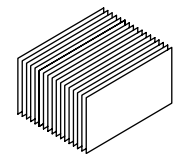
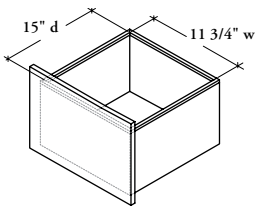

Paper Size Allowed:
• Legal

24" or 30" wide drawers

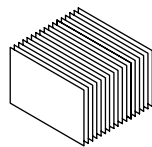
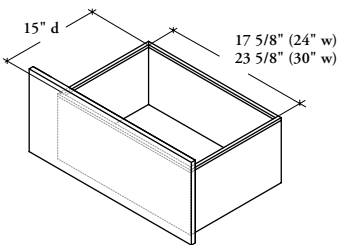

Paper Sizes Allowed:
• Letter
• A4
• Legal

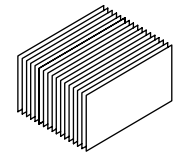

Paper Size Allowed:
• Legal

36" wide drawer

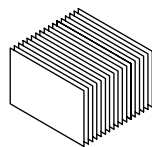
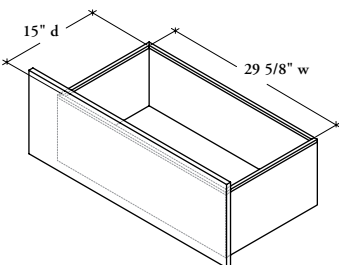

Paper Size Allowed:
• Legal

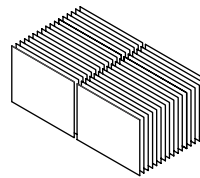

Paper Sizes Allowed:
• Letter
• A4

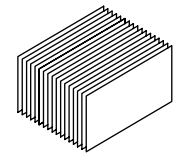

Paper Size Allowed:
• Legal

42" wide drawer

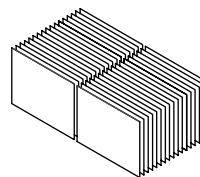
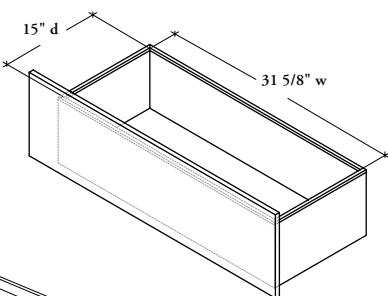

Paper Sizes Allowed:
• Letter
• A4
• Legal

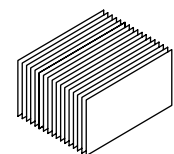

Paper Size Allowed:
• Letter**
• A4**
• Legal

** The Letter or A4 paper size is allowed but require optional 36" Hanging File Bar (RSLB36)

planning with storage for secondary desks

- ❗ The storage for secondary desk can be placed anywhere under low or high secondary desk (B_MSD, BH_SR, BH_SB or BH_SL)
- When a secondary desk exceeds the maximum span allowed, a Storage for Secondary Desk (BSSP, BSSL, BSSO, BSSD, BSSM or BSSRW) must be placed underside to maintain integrity
- The Open Section Cover – Secondary Desk (BSSCM) **cannot** be used to reduce unsupported span
- The restrictions illustrated below apply to Fixed-Height or Height-Adjustable Multi-Level Workstations

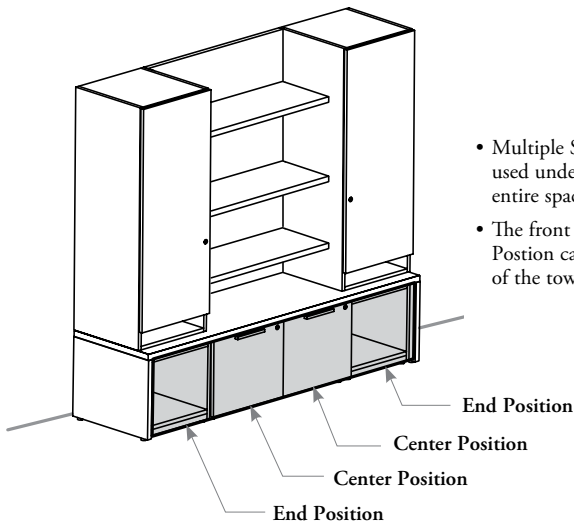

- Multiple Storage for Secondary Desk can be used under the same desk. They can fill the entire space available
- The front of Storage for Secondary Desk – End Position can perfectly be aligned with the front of the towers

