

# returns & credenzas

RETURN BASICS.....50

CREDENZA BASICS.....52

FILING DRAWER CAPACITIES – RETURNS & CREDENZAS.....54

PLANNING WITH RETURNS .....55

PLANNING WITH CREDENZAS .....56

PRODUCT OFFERING – RETURNS .....57

PRODUCT OFFERING – CREDENZAS .....58

LOCK CHART – RETURNS.....60

LOCK CHART – CREDENZAS.....61

RETURN & CREDENZA FINISHES .....63

GRAIN DIRECTION/USER EDGE – RETURNS & CREDENZAS .....64

## return basics

Returns include a worksurface, grommets, a support (storage unit) and a modesty panel. The images below illustrate return styles available that must be used in conjunction with another desk.

All dimensions in this section are nominal

- ❗ **Cannot** be used alone, they must be connected to the straight user edge and on the full gable side of a desk or credenza
- Are designed with a 1/4" gap that allows mounting accessories and wiring
- Are shipped knocked down

### return anatomy

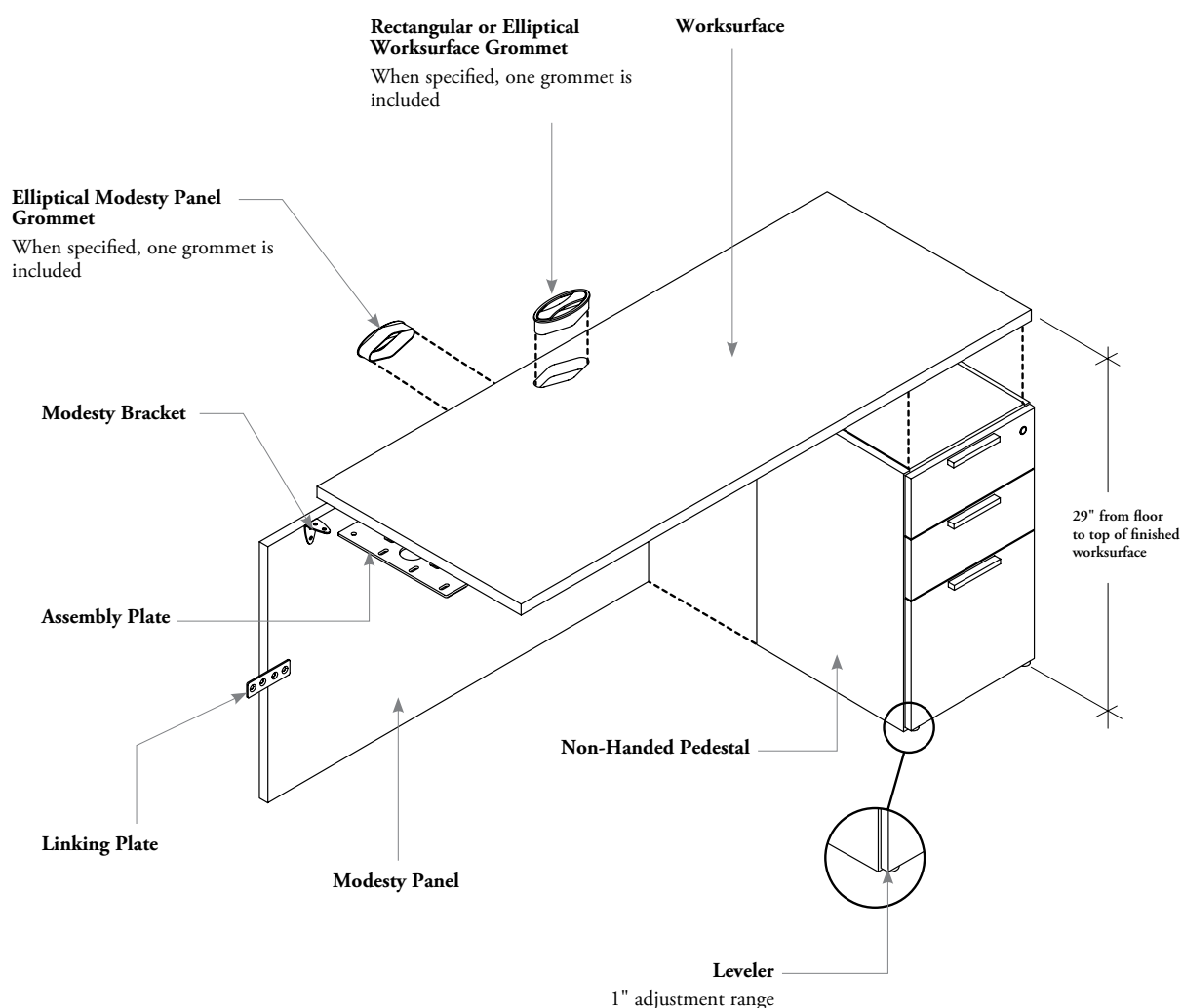

## return basics (continued)

**Worksurfaces**

- Three thicknesses available:
  - D: 1" thick low pressure laminate (LPL)
  - M: high pressure laminate (HPL) with a 1 1/8" thick baseboard for a total surface thickness of 1 3/16"
  - X: high pressure laminate (HPL) with a 1 1/2" thick baseboard for a total surface thickness of 1 9/16"
- Spacer attachments (included with worksurfaces) allow to attach firmly the worksurface with pedestal top
- Grain directions is specified on page 64

**Worksurface Grommets**

- Three grommet options are available:
  - Elliptical Grommet (E)
  - Rectangular Grommet (G)
  - No Grommet (N)
- When specified, returns come with factory-made grommet cut-outs on the modesty panels and worksurfaces
- Provide openings for electrical wiring and communication cables
- Grommets style can be interchanged on-site by ordering grommets separately

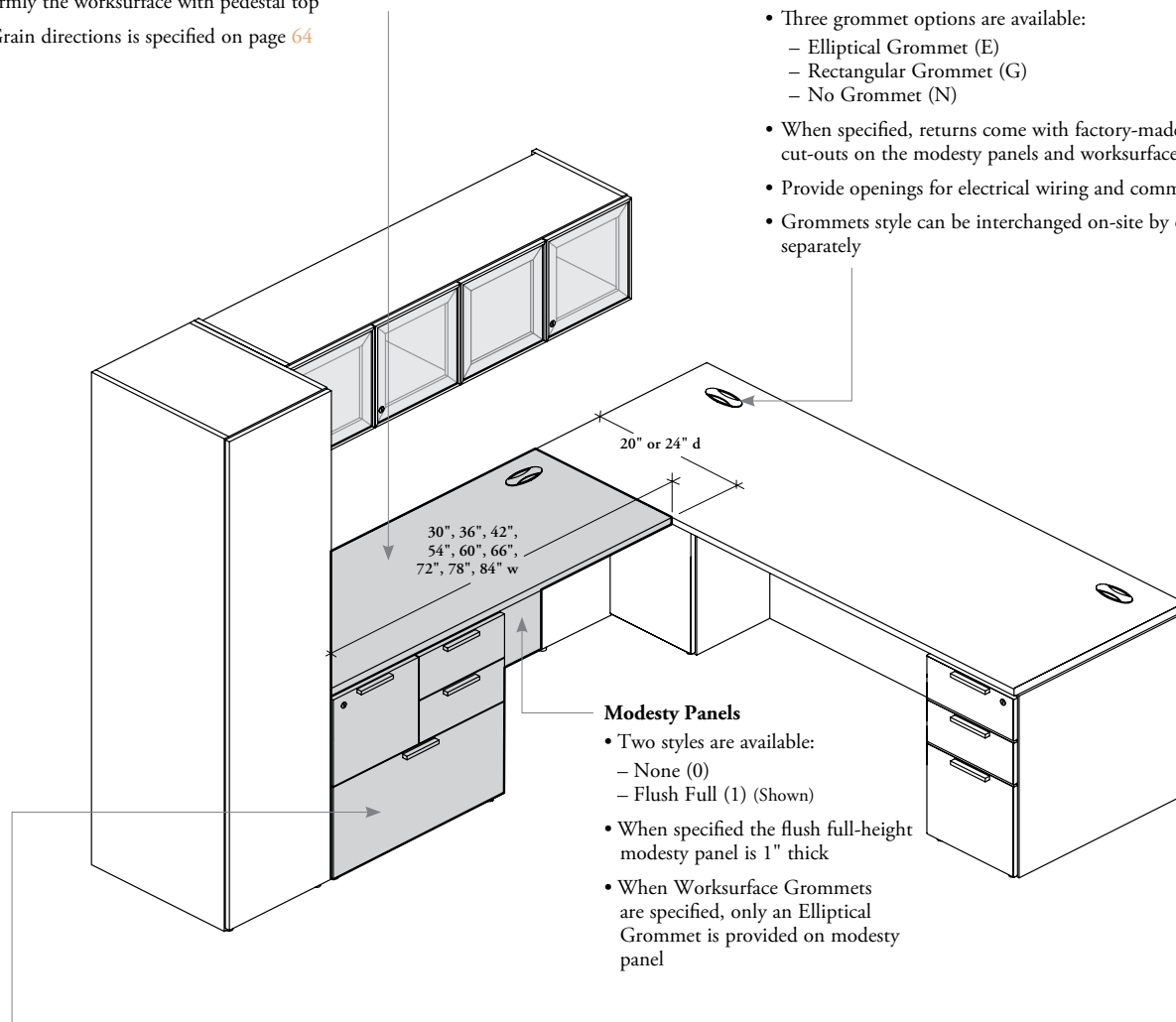
**Modesty Panels**

- Two styles are available:
  - None (0)
  - Flush Full (1) (Shown)
- When specified the flush full-height modesty panel is 1" thick
- When Worksurface Grommets are specified, only an Elliptical Grommet is provided on modesty panel

**Pedestals**

- Four storage types are available:

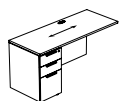

1 Box/Box/File Pedestal

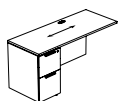

1 File/File Pedestal

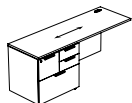

1 Combo Pedestal

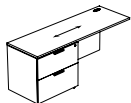

1 Lateral File

- Have a central locking system and full-extension drawers that can accommodate both letter- and legal-size paper
- Box drawers include pencil tray and divider. File drawers include file bars; see individual product pages
- Only single pedestal configuration can be specified left handed (Shown) or right handed
- Standard Expansion (1) and Rectangular (9) pull styles available; see page 53

## credenza basics

Credenzas come in a variety of configurations and sizes to complement any workstation or meeting requirements.



- Can be used alone or combined with a bridge, return or Peninsula Worksurface
- Hutches or Wall Panels can be installed on top. Some restrictions apply; see Mounted Storage section for details
- Only credenzas with open section are shipped knocked down

### credenza anatomy

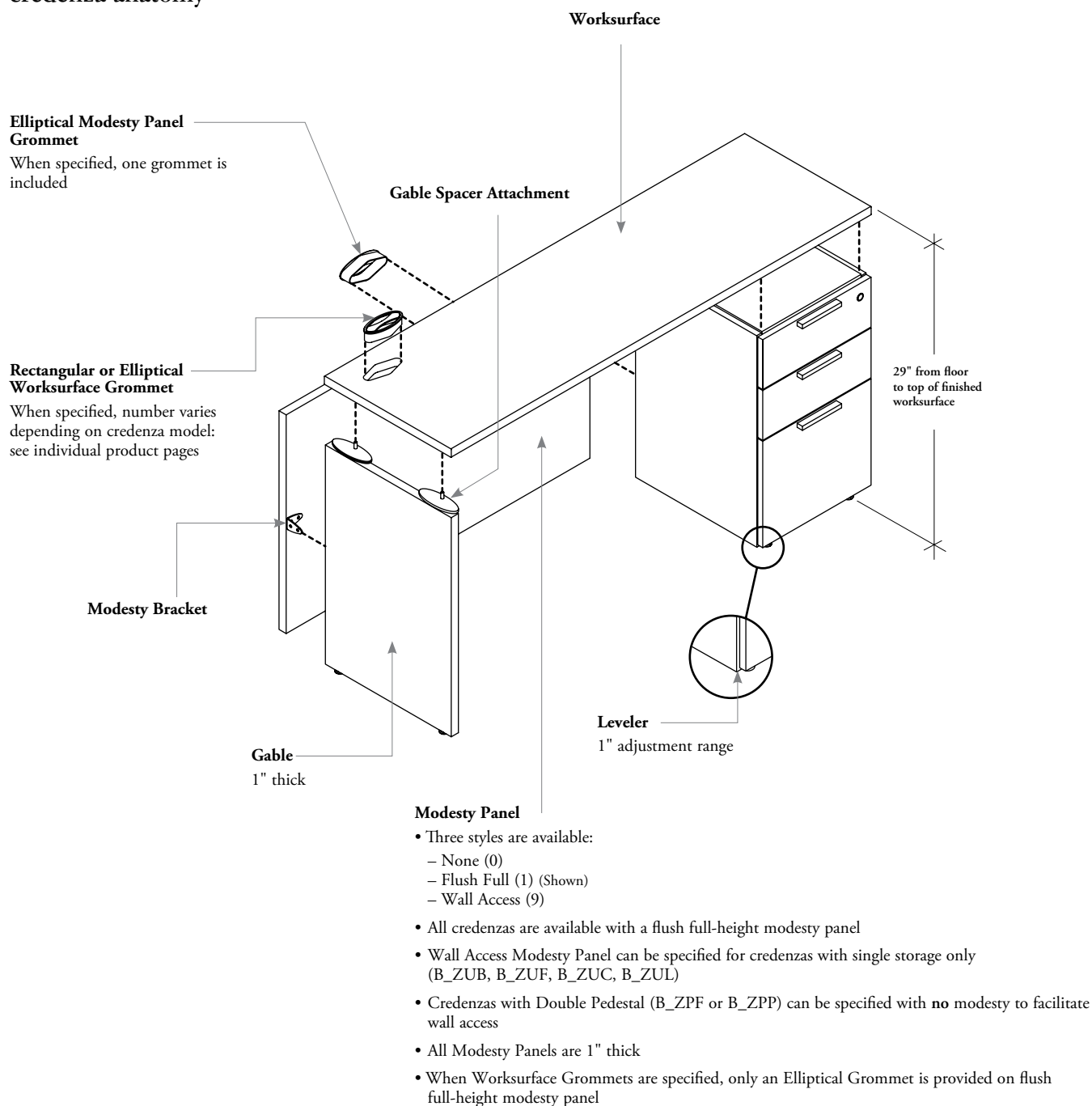



## credenza basics (continued)

### Worksurfaces

- Available in the same styles/thicknesses (D, M, X) as worksurface
- Spacer attachments allow to attach firmly the worksurface with storage top
- Grain direction is specified on page 64

### Worksurface Grommets

- Three grommet options are available:
  - Elliptical Grommet (E)
  - Rectangular Grommet (G)
  - No Grommet (N)
- When specified, credenzas come with factory-made grommet cut-outs on the modesty panel and worksurface
- Allow wire management between the top of the credenza and the wall outlets
- Grommets style can be interchanged on-site by ordering grommets separately

### Storage

- Has a central locking system:
  - Box/Box/File Pedestals
  - File/File Pedestals
  - File Drawers of Combo Pedestal
- Only the Lateral File has a central locking system that disables the opening of a second drawer
- Full-extension drawers can accommodate both letter- and legal-size paper
- Hinges allow doors to open up to 120°
- Holes at 1 1/4" intervals inside of door sections allow for shelf height adjustment
- Only Credenza with Doors (B\_ZFS) can be specified with Pulls (P) or Touch-to-Open (T)

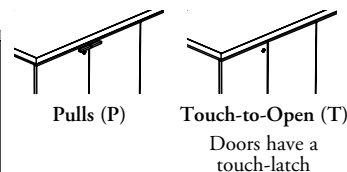
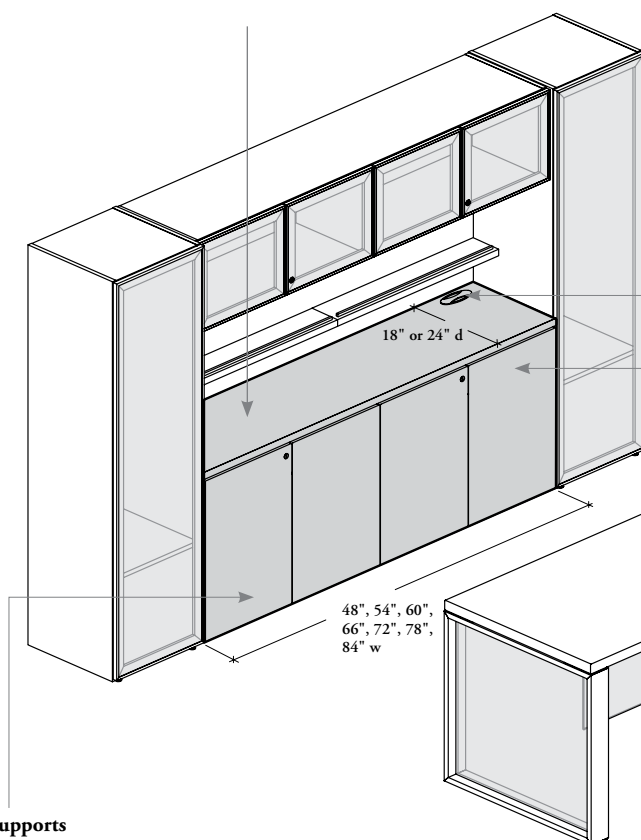

### Supports

Three configurations are available:

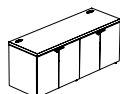

Full Storage

Credenza with Doors and Lateral File (B\_ZFL) can be specified left or right side for 48" to 72" widths

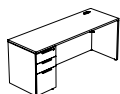

1 Storage and 1 Gable

Only Single pedestal configuration can be specified left or right

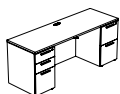

2 Pedestals

Double pedestal configuration can be interchanged on-site

### Pull Styles

Two pull styles are available:



Standard Expansion (1)

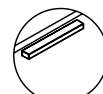

Rectangular (9)

for more details, refer to page 333

### Full Storage credenzas and Plug-In Power Bar (BLPP)

- Desk Mounted with Wire Clips Configuration (D) must be specified for this application
- 1/4" gap between the divider and the back allows installation of the power bar



# filing drawer capacities – returns & credenzas

Lateral file drawer storage capacities are shown below.

 The dimensions listed below are inside drawer

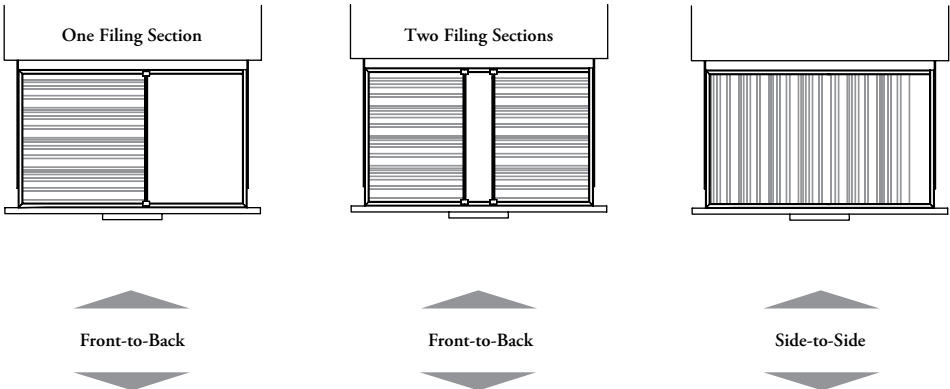

## 30" wide drawer

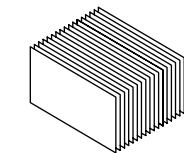
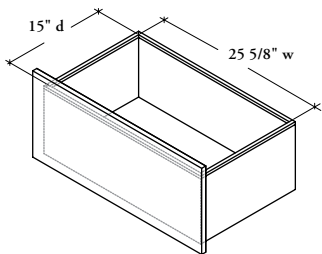

**Paper Sizes Allowed:**

- A4
- Legal

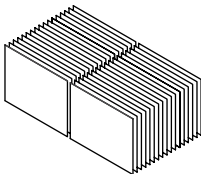

**Paper Size Allowed:**

- Letter

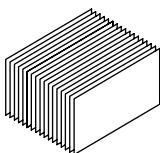

**Paper Sizes Allowed:**

- Letter\*
- A4\*
- Legal

## 36" wide drawer

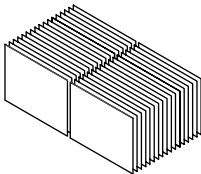
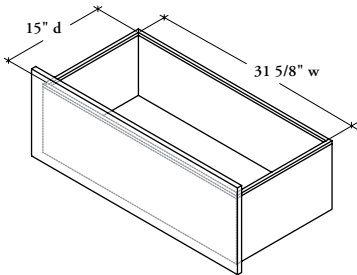

**Paper Sizes Allowed:**

- Letter
- A4
- Legal

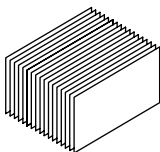

**Paper Sizes Allowed:**

- Letter\*
- A4\*
- Legal

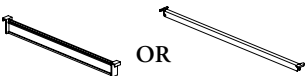

\* The Letter or A4 paper size is allowed but require optional Hanging File Bar (RSLB)

## planning with returns

- ❗ • Must be connected to the straight user edge and on the full gable side of a Preconfigured Desk, Desk or Credenza
- A wall panel **cannot** be installed on a return
- Must always be linked to one of the following products:
  - Preconfigured Desks (B\_SRBS, B\_SCBS and B\_YRLS)
  - Credenzas with Single Pedestal (B\_ZUB, B\_ZUF, B\_ZUC and B\_ZUL)
  - Desks with Full Gables (B\_VF, B\_RR, B\_RF, B\_BDF, B\_PAF and B\_RDF)

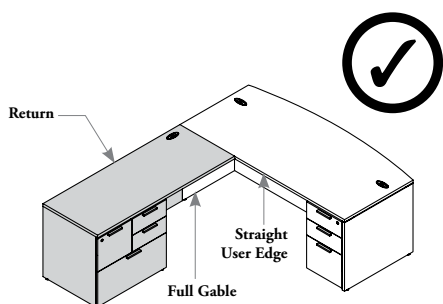

**Conjunction with a Standard Desk  
(Preconfigured Desks)**

Returns must always be linked to a full gable and straight user edge workspace

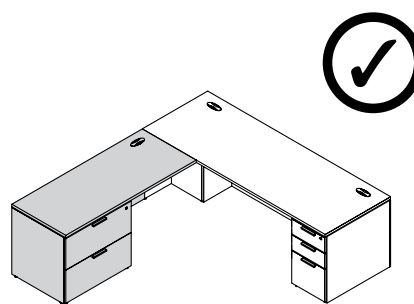

**Conjunction with a Executive Desk  
(Preconfigured Desks)**

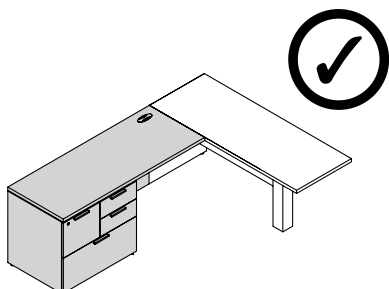

**Conjunction with a Peninsula Desk  
with Half Modesty (Desks)**

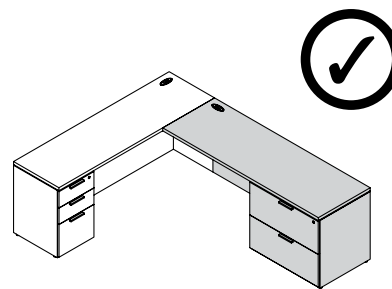

**Conjunction with a Credenza**

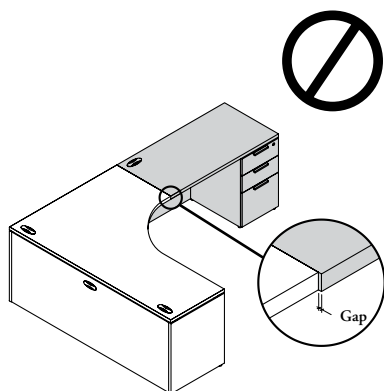

**Conjunction with a Corner, Extended  
Corner or Extended Peninsula Desk  
(Desks)**

Workspace depths are **not** the same

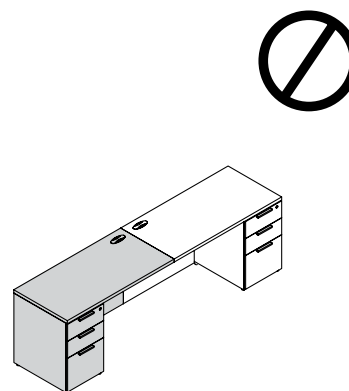

**Conjunction with another Return**

## planning with credenzas



- All Credenzas can be used alone
- Credenzas with single storage unit can be used in conjunction with:
  - All Returns
  - Desks with Half Gables, except Corner, Extended Corner and Extended Peninsula Desks
  - Peninsula Worksurfaces and Rectangular Bridges

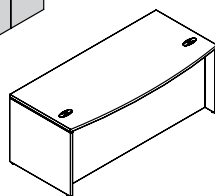
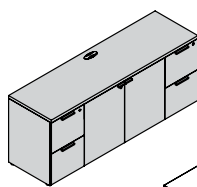

Alone

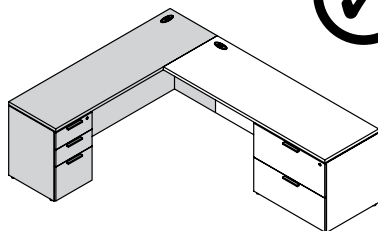

Conjunction with a Return

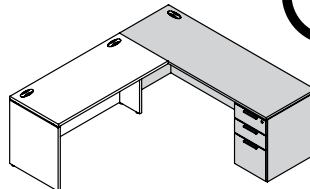

Conjunction with a Desk and Half Gable

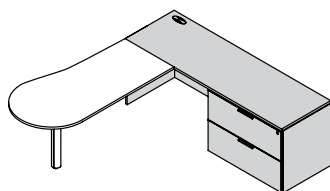

Conjunction with a Peninsula  
Worksurface

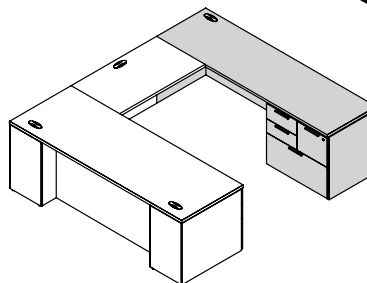

Conjunction with a Rectangular Bridge

## product offering – returns

- ❗ • Depths are actual dimensions for returns. This page provides actual widths in all cases
- For a list of available dimension combinations, refer to pricing tables in the price guide or to the specification software

### Return with Box/Box/File Pedestal (B\_JBL or B\_JBC)

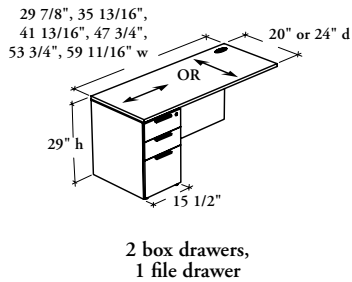

### Return with File/File Pedestal (B\_JFL or B\_JFC)

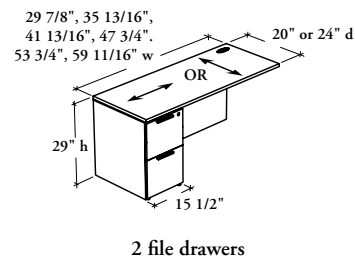

### Return with Combo Pedestal (B\_JCL)

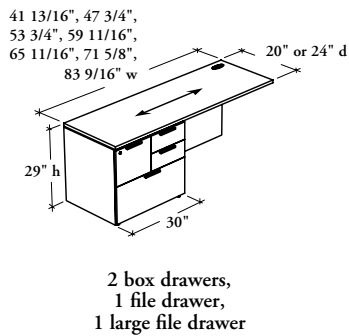

### Cross Grain Return with Combo Pedestal (B\_JCC)

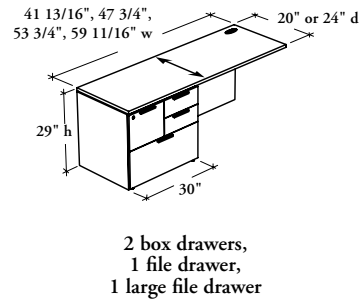

### Return with Lateral File (B\_JLL)

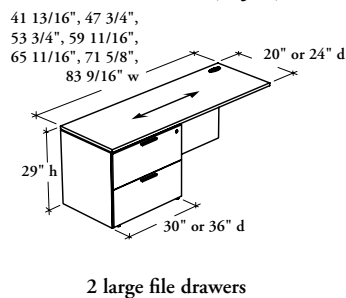

### Cross Grain Return with Lateral File (B\_JLC)

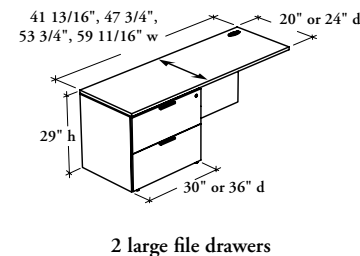

# application guide

---

## product offering – credenzas

- ❗
- Depths are actual dimensions for credenzas. This page provides actual widths in all cases
  - For a list of available dimension combinations, refer to pricing tables in the price guide or to the specification software

### Credenza with Double Pedestals – File/File (B\_ZPF)

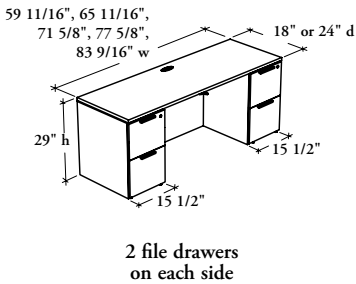

### Credenza with Double Pedestals – Box/Box/File and File/File (B\_ZPP)

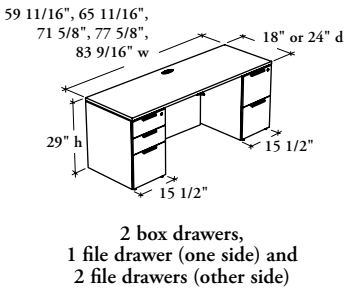

### Credenza with Single Pedestal – Box/Box/File (B\_ZUB)

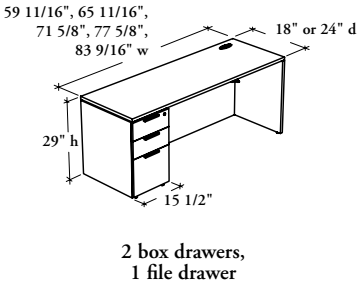

### Credenza with Single Pedestal – File/File (B\_ZUF)

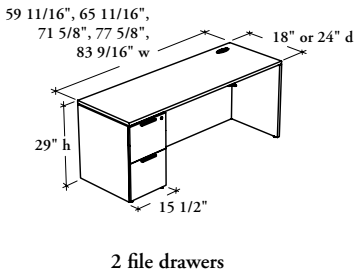

### Credenza with Single Pedestal – Combo Pedestal (B\_ZUC)

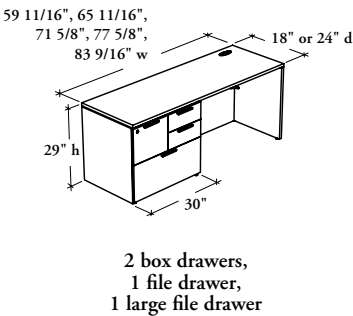

### Credenza with Single Lateral File (B\_ZUL)

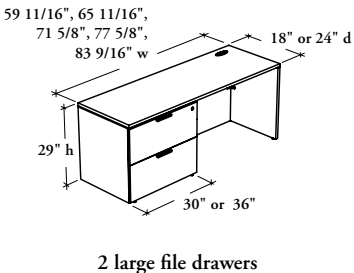

### Credenza with Doors (B\_ZFS)

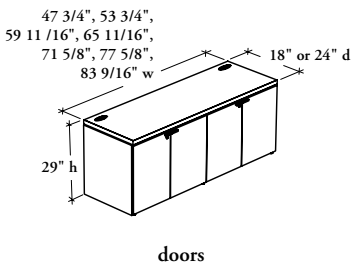

### Credenza with Doors and Drawers (B\_ZFD)

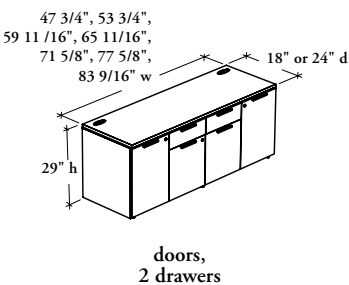

# product offering – credenzas (continued)

- 
- Depths are actual dimensions for credenzas. This page provides actual widths in all cases
  - For a list of available dimension combinations, refer to pricing tables in the price guide or to the specification software

Credenza with Doors and Lateral File (B\_ZFL)

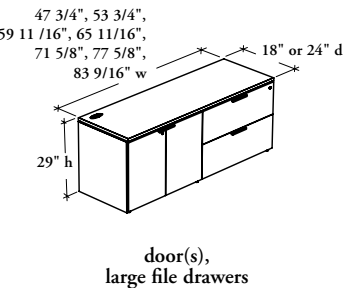

Credenza with Doors and Two Box/Box/File Pedestals (B\_ZFDB)

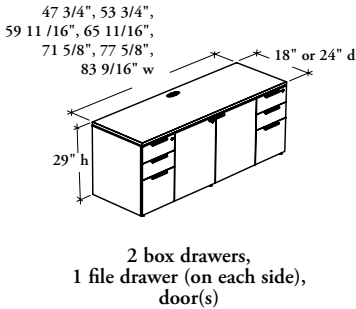

Credenza with Doors and Two File/File Pedestals (B\_ZFDF)

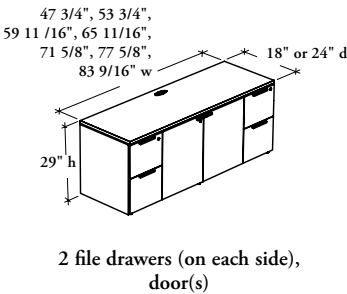

lock chart – returns

⚠ All closed storage can be specified with or without lock and key set. When lock is specified, keyed alike or randomly are available. A Key Chart must accompany every order, otherwise orders will be shipped keyed randomly

Return with Box/Box/File Pedestal (B\_JBL or B\_JBC)

30" to 60" w

Left

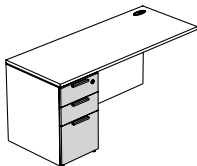

OR

Right

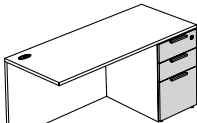

number of locks

1 x

Return with File/File Pedestal (B\_JFL or B\_JFC)

30" to 60" w

Left

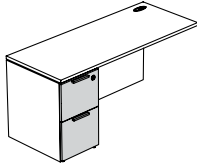

OR

Right

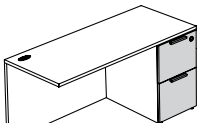

number of locks

1 x

Return with Combo Pedestal (B\_JCL or B\_JCC)

42" to 84" w

Left

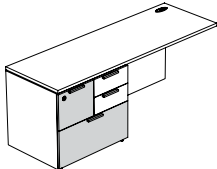

OR

Right

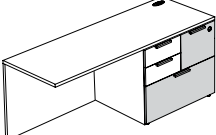

number of locks

1 x

Return with Lateral File (B\_JLL or B\_JLC)

42" to 84" w

Left

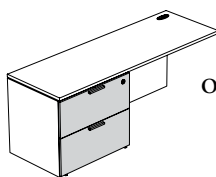

OR

Right

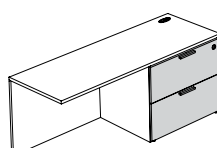

number of locks

1 x

 Lockable Drawers

 Not Lockable



## lock chart – credenzas

❗ All closed storage can be specified with or without lock and key set. When lock is specified, keyed alike or randomly are available. A Key Chart must accompany every order, otherwise orders will be shipped keyed randomly

Credenza with Double Pedestals – File/File (B\_ZPF)

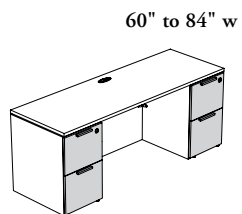

number of locks	2 x
-----------------	-----

Credenza with Double Pedestals – Box/Box/File and File/File (B\_ZPP)

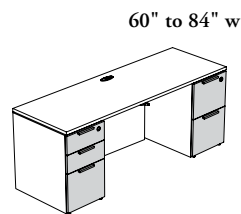

number of locks	2 x
-----------------	-----

Credenza with Single Pedestal – Box/Box/File (B\_ZUB)

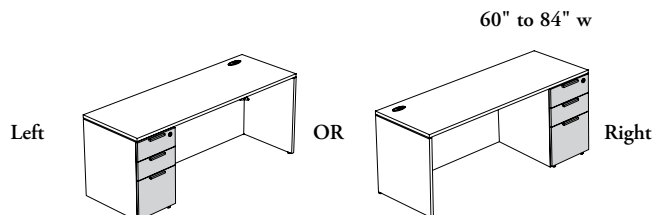

number of locks	1 x
-----------------	-----

Credenza with Single Pedestal – File/File (B\_ZUF)

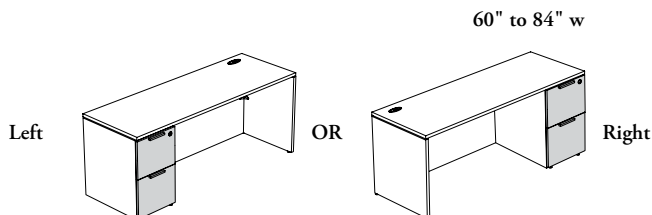

number of locks	1 x
-----------------	-----

Credenza with Single Pedestal – Combo Pedestal (B\_ZUC)

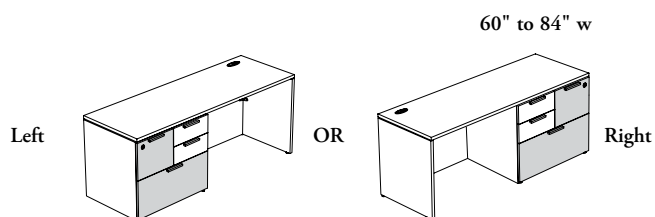

number of locks	1 x
-----------------	-----

Credenza with Single Lateral File (B\_ZUL)

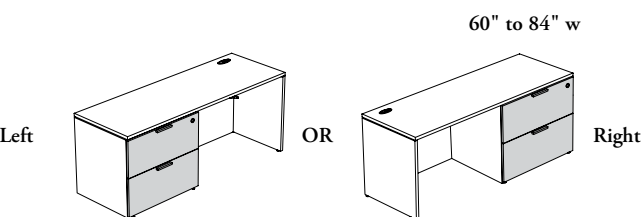

number of locks	1 x
-----------------	-----

Credenza with Doors (B\_ZFS) (with or without pulls)

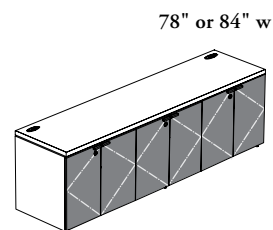
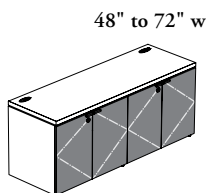

number of locks	2 x	3 x
-----------------	-----	-----

	Lockable Double Doors		Lockable Single Door		Lockable Drawers		Not Lockable
--	-----------------------	--	----------------------	--	------------------	--	--------------

# lock chart – credenzas (continued)

## Credenza with Doors and Drawers (B\_ZFD)

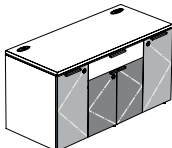
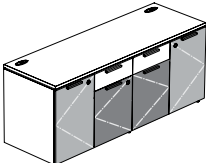
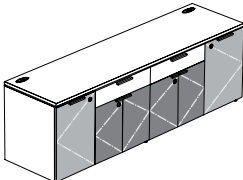
	48" or 54" w	60" to 78" w	84" w
			
number of locks	3 x	3 x	4 x

## Credenza with Doors and Two Box/Box/File Pedestals (B\_ZFDB)

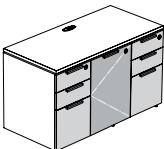
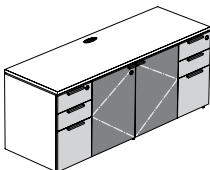
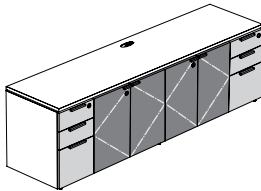
	48"	54" to 72" w	78" or 84" w
			
number of locks	3 x	3 x	4 x

## Credenza with Doors and Two File/File Pedestals (B\_ZFDF)

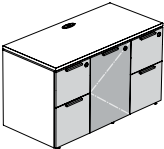
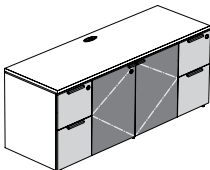
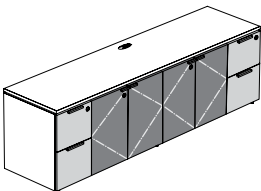
	48"	54" to 72" w	78" or 84" w
			
number of locks	3 x	3 x	4 x

## Credenza with Doors and Lateral File (B\_ZFL)

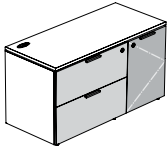
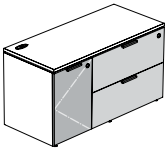
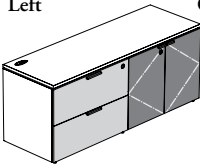
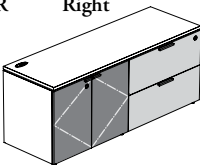
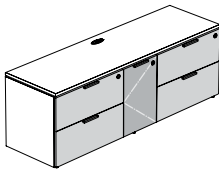
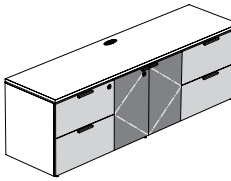
	48" or 54" w	60" to 72" w	78 w	84" w
	<div>Left</div>  <div>OR</div> <div>Right</div> 	<div>Left</div>  <div>OR</div> <div>Right</div> 		
number of locks	2 x	2 x	3 x	3 x

	Lockable Double Doors		Lockable Single Door		Lockable Drawers		Not Lockable
---	-----------------------	---	----------------------	---	------------------	---	--------------

## return & credenza finishes

- ❗ All Laminate components are protected with a solid plastic edge
- Flintwood finishes are **not** available in this section
- Not all** Thickness, Finish, Style or Color options are available, refer to the Finish Restrictions Chart below

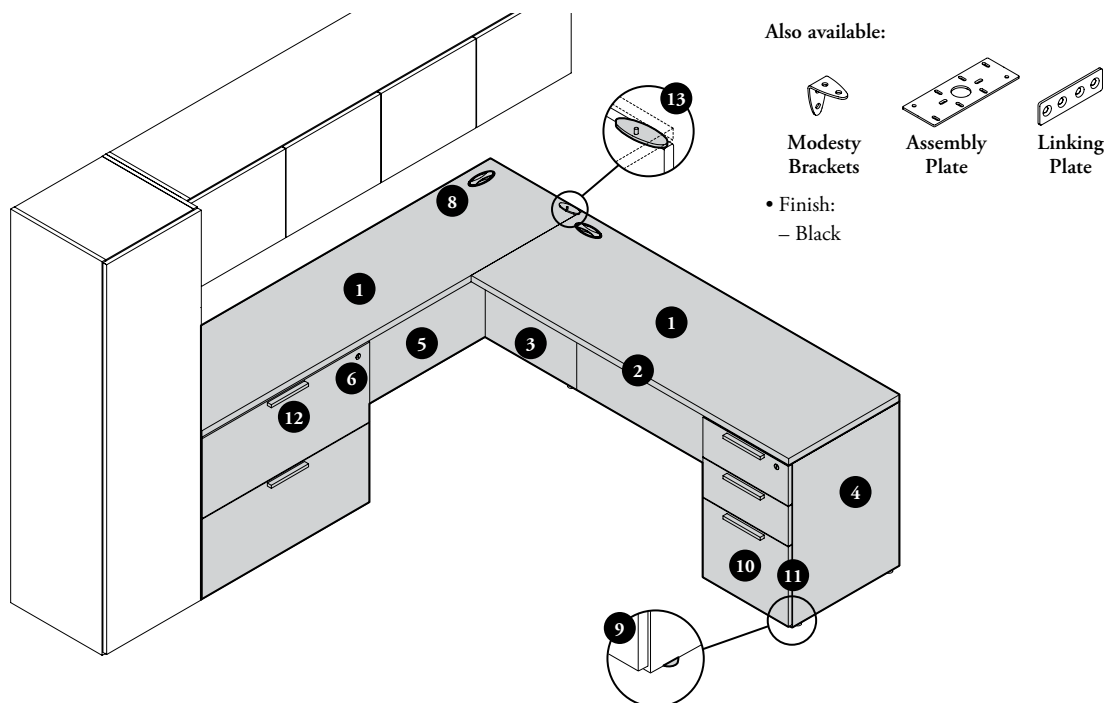

### 1 Worksurface

- Finishes:
- Source Laminate
  - Foundation Laminate

### 2 Worksurface Edge Trim

- Edge Trim Style:
- Straight Trim (3mm) (6)

### 3 Gable, 4 Case and 5 Modesty Panel

- Finish:
- Source Laminate

### 6 Lock and Key

- Finish:
- Brushed Chrome

### 8 Elliptical Grommet

- Finishes:
- D and M thicknesses:
    - Foundation
    - Mica
    - Source Laminate (Wood Prints only)
  - X thickness:
    - Source Laminate (Wood Prints only)

### Rectangular Grommet

- Finishes:
- Foundation
  - Mica

### 9 Leveler

- Finish:
- Black

### 10 Door or Drawer Front and 11 Edge Trim

- Finishes:
- Source Laminate
  - Foundation Laminate
  - 1" worksurface thickness (D):
    - Door or Drawer Fronts are available in Source Laminate colors only
  - Edge Trim finish on Door or Drawer Front always match Door or Drawer Front finish

### 12 Pull and 13 Gable Spacer Attachment

- Finishes:
- Foundation
  - Mica
  - Hardware will match Pull finish if visible

## finishes restriction chart

Worksurface Thickness	Worksurface Finish	Edge Trim Style	Edge Trim Finish	Case, Gable and Modesty Panel Finish	Door and/or Drawer Front Finish
D 1"	Source Laminate	6	Edge Trim Colors *	Source Laminate	Source Laminate
M 1 3/16"	Foundation Laminate	6	Edge Trim Colors *		Source Laminate or Foundation Laminate
X 1 9/16"	Foundation Laminate **	6	Edge Trim Colors **		

\* Black Matte, Baltic Ply, Clay Matte and Fossil Matte are not available

\*\* Storm White, Very White, Crisp Grey, Soft Gris or Wood Prints only

## grain direction/user edge – returns & credenzas

Attention to grain/pattern direction is important when planning returns or credenzas. The following examples demonstrate this.

### worksurfaces

- Grain/patterns are **not** "centered"
- Applicable for Source or Foundation Laminate Wood Prints

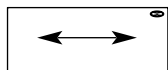

B\_JBL, B\_JFL, B\_JCL  
or B\_JLL



B\_JBC, B\_JFC, B\_JCC  
or B\_JLC

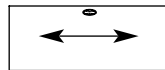

B\_ZPF, B\_ZPP, B\_ZUB, B\_ZUF,  
B\_ZUC, B\_ZUL, B\_ZFS, B\_ZFD,  
B\_ZFL, B\_ZFDB or B\_ZFDF

### returns or credenzas

- Door grain direction will always be vertical
- Drawer front grain direction will vary depending on finish selected

#### Cathedral Grain Pattern:

Source Laminate

- 3A – 3B – 3C – 3D – 3E – 3L – 3M – 3X – 8E – 8R – 8S –  
XQ – XR – 86 – 87 – 88

Foundation Laminate

- 2A – 2B – 2C – 2D – 2E – 2L – 2M – 2X – 7B – 7M – 7S –  
7U – 7V – 7Z – RQ – YR

For colors listed above, the Cathedral Grain Pattern for door  
and drawer fronts will be book-matched

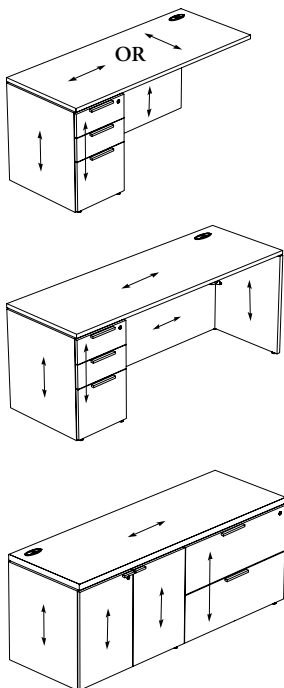

#### Straight Grain Pattern:

Source Laminate

- 3F – 3K – XJ

Foundation Laminate

- 2F – 2K – JG

For colors listed above, the Straight Grain Pattern for drawer  
fronts will be vertical

