

B_ZAB

Credenza with Doors and Two Box/Box/File Pedestals

This stand-alone credenza provides a convenient storage areas with shelving, box drawers and filling that accepts both letter- and legal-size papers.

WHAT'S INCLUDED

1 top, 2 grommets (1 on top, 1 on rear), 4 box and 2 file drawers, 2 pencil trays, 2 drawer dividers, 2 12" hanging file bars, pulls (as specified), levelers, and elements listed below:

	Width		
	48"	54" to 72"	78" or 84"
Door	1	2	4
Adjustable Shelf	1	1	2
Lock & Keys (as specified)	2	2	3

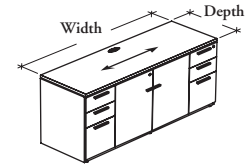

NOTES

- The rightmost pedestal section has a central locking system.
- Pedestals have full extension drawers that can accommodate both letter- and legal-size paper.
- Holes at 1 1/4" intervals inside door sections allow for shelf height adjustment.
- The included hanging file bars are to be installed along the width only.
- Soft Touch (2) and Standard T/O/S (4) pulls are only available in limited Foundation colors. Refer to the specification software for details.
- The 1 9/16" (X) thickness is not available in all Foundation Laminate and Edge Trim colors. Refer to the finish page of the Application Guide for details.

PRODUCT OPTIONS

Worksurface Thickness	Depth	Width	Worksurface Finish	Door and Drawer Front Finish	Case Finish	Pull Style	Pull Finish	Key Style
D 1"	18, 24	48, 54, 60, 66, 72, 78, 84	Source Laminate	Source Laminate	Source Laminate	1 Standard Expansion 2 Soft Touch 4 Standard T/O/S 6 Arched 7 Elliptical 9 Rectilinear	Foundation Mica	K Keyed Alike R Keyed Randomly
M 1 3/16"			Foundation Laminate	Foundation Laminate				
X 1 9/16"			Edge Trim Style	Edge Trim Finish				
			6 Straight Trim	Edge Trim Colors				
			Edge Trim Finish					
			Edge Trim Colors					

SAMPLE ORDER CODE

BMZAB	18	72	LW	6	ST	LW	ST	XS	1	7	R
--------------	-----------	-----------	-----------	----------	-----------	-----------	-----------	-----------	----------	----------	----------

DIMENSIONS
INCHES / MM

D	W
18 / 457	48 / 1219
18 / 457	54 / 1372
18 / 457	60 / 1524
18 / 457	66 / 1676
18 / 457	72 / 1829
18 / 457	78 / 1981
18 / 457	84 / 2134
24 / 610	48 / 1219
24 / 610	54 / 1372
24 / 610	60 / 1524
24 / 610	66 / 1676
24 / 610	72 / 1829
24 / 610	78 / 1981
24 / 610	84 / 2134

PRICING

1" (D)		1 3/16" (M)		1 9/16" (X)	
SOURCE LAMINATE		FOUNDATION LAMINATE		FOUNDATION LAMINATE	
DOOR AND DRAWER FRONT FINISH					
Source Laminate	Foundation Laminate	Source Laminate	Foundation Laminate	Source Laminate	Foundation Laminate
1996	2123	2214	2341	2255	2382
2126	2263	2379	2516	2427	2564
2202	2359	2469	2626	2519	2676
2280	2449	2572	2741	2627	2796
2379	2560	2675	2856	2737	2918
2803	3003	3090	3290	3190	3390
2937	3150	3250	3463	3358	3571
2225	2352	2477	2604	2531	2658
2348	2485	2607	2744	2670	2807
2415	2572	2701	2858	2768	2925
2547	2716	2841	3010	2918	3087
2663	2844	2962	3143	3045	3226
3085	3285	3373	3573	3498	3698
3236	3449	3549	3762	3684	3897