

mounted storage & accessories

Xpress

B_WCO

Wall Panel for Overhead Cabinet and Shelf

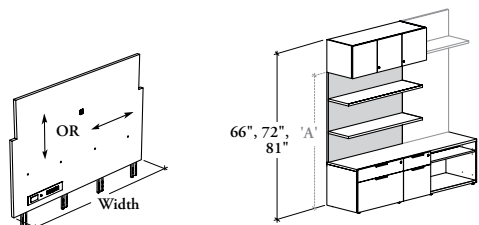

Mounting Style (K)

Datum Height		
66" h	72" h	81" h
51"	57"	66"

'A' (Finishing Height) =

This wall panel is designed to support an overhead cabinet and a solid shelf. It is compatible with tackboard or markerboard for enhanced functionality. Whether mounted onto a desk, credenza, secondary desk, mid-height storage, workwall kneespace module or workwall credenza, the wall panel is easily installed requiring securement at only two wall locations.

WHAT'S INCLUDED

1 or 2 panels, 1 square duo grommet ring, 1 cut-out with power bar and cover (as specified), mounting hardware for wall panel and overhead cabinet.

WHAT'S EXCLUDED

Desk, Credenza, Secondary Desk, Mid-Height Storage, Workwall Storage, Overhead Cabinet, Double Overhead Cabinet, and Tackboard for Wall Panel, Solid Shelf for Wall Panel (BAWSS) and Solid Display Shelf for Wall Panel (BAWDS).

NOTES

Duo Square Grommet Ring is finished in Black.

The number of panels may vary depending of the dimension and grain direction selected. Refer to Application Guide.

Not all finishes are available as Xpress, Please see Xpress catalogue and/or specification software for details.

PRODUCT OPTIONS

Mounting Style	Grain Direction	Overhead Height	Datum Height	Width	Configuration	Power and Data	Panel Finish
K On Mid-Height	V Vertical	15, 30	66, 72, 81	24, 30, 36, 42, 48, 54, 60, 66, 72, 78, 84	BN Bottom Shelf (Shown)	OC Over orksurface – Center	Source Laminate Flintwood (No Cathedral)
M On 1 3/16" thick Standard Worksurface	H Horizontal				BM Bottom and Middle Shelves	OL Over Worksurface – Left (Shown)	
X On 1 9/16" thick Standard Worksurface						OR Over Worksurface – Right	
H On High Secondary Desk (All Thicknesses)						NN No Power and Data	
L On Low Secondary Desk (All Thicknesses) (Shown)							

SAMPLE ORDER CODE

BH	W	C	O	V	30	81	36	BN	XS
-----------	----------	----------	----------	----------	-----------	-----------	-----------	-----------	-----------

DIMENSIONS INCHES / MM

PRICING

MOUNTING STYLE (H)

15" OVERHEAD HEIGHT

BOTTOM SHELF (BN)

NO POWER AND DATA (NN)

POWER AND DATA (OC)

POWER AND DATA (OL, OR)

PANEL FINISH

H	W	Source Laminate		Source Laminate		Source Laminate	
		Flintwood	Flintwood	Flintwood	Flintwood	Flintwood	Flintwood
66 / 1676	24 / 610	225	1254	n/a	n/a	n/a	n/a
66 / 1676	30 / 762	277	1337	n/a	n/a	n/a	n/a
66 / 1676	36 / 914	328	1420	771	1859	n/a	n/a
66 / 1676	42 / 1067	383	1522	822	1960	n/a	n/a
66 / 1676	48 / 1219	419	1622	862	2061	n/a	n/a
66 / 1676	54 / 1372	465	1720	n/a	n/a	907	2160
66 / 1676	60 / 1524	506	1803	n/a	n/a	948	2243
66 / 1676	66 / 1676	545	1886	n/a	n/a	986	2326
66 / 1676	72 / 1829	597	1970	n/a	n/a	1039	2409
66 / 1676	78 / 1981	650	2053	n/a	n/a	1089	2493
66 / 1676	84 / 2134	701	2136	n/a	n/a	1144	2576

Pricing is continued on the following page.

B _ W C O
Wall Panel for Overhead Cabinet
with Shelf (Continued)

DIMENSIONS
INCHES / MM

PRICING

DIMENSIONS INCHES / MM		MOUNTING STYLE (H) (CONTINUED)							
		15" OVERHEAD HEIGHT							
		BOTTOM SHELF (BN)		POWER AND DATA (OC)		POWER AND DATA (OL, OR)			
		NO POWER AND DATA (NN)		POWER AND DATA (OC)		POWER AND DATA (OL, OR)			
H		W		PANEL FINISH					
				Source Laminate	Flintwood	Source Laminate	Flintwood	Source Laminate	Flintwood
72 / 1829	24 / 610	249	1343	n/a	n/a	n/a	n/a		
72 / 1829	30 / 762	307	1437	n/a	n/a	n/a	n/a		
72 / 1829	36 / 914	365	1529	806	1969	n/a	n/a		
72 / 1829	42 / 1067	423	1621	864	2059	n/a	n/a		
72 / 1829	48 / 1219	465	1712	907	2152	n/a	n/a		
72 / 1829	54 / 1372	516	1803	n/a	n/a	956	2243		
72 / 1829	60 / 1524	564	1895	n/a	n/a	1005	2333		
72 / 1829	66 / 1676	607	1986	n/a	n/a	1045	2427		
72 / 1829	72 / 1829	661	2080	n/a	n/a	1105	2521		
72 / 1829	78 / 1981	720	2172	n/a	n/a	1162	2611		
72 / 1829	84 / 2134	777	2261	n/a	n/a	1217	2702		
81 / 2057	24 / 610	285	1477	n/a	n/a	n/a	n/a		
81 / 2057	30 / 762	352	1587	n/a	n/a	n/a	n/a		
81 / 2057	36 / 914	421	1693	859	2134	n/a	n/a		
81 / 2057	42 / 1067	483	1770	927	2208	n/a	n/a		
81 / 2057	48 / 1219	534	1847	975	2289	n/a	n/a		
81 / 2057	54 / 1372	593	1928	n/a	n/a	1030	2368		
81 / 2057	60 / 1524	651	2033	n/a	n/a	1091	2468		
81 / 2057	66 / 1676	700	2136	n/a	n/a	1134	2579		
81 / 2057	72 / 1829	757	2245	n/a	n/a	1204	2689		
81 / 2057	78 / 1981	825	2351	n/a	n/a	1272	2788		
81 / 2057	84 / 2134	891	2449	n/a	n/a	1327	2891		
		30" OVERHEAD HEIGHT							
		BOTTOM SHELF (BN)							
		NO POWER AND DATA (NN)		POWER AND DATA (OC)		POWER AND DATA (OL, OR)			
		PANEL FINISH		POWER AND DATA (OC)		POWER AND DATA (OL, OR)			
H		W		Source Laminate	Flintwood	Source Laminate	Flintwood		
				Source Laminate	Flintwood	Source Laminate	Flintwood		
81 / 2057	24 / 610	285	1477	n/a	n/a	n/a	n/a		
81 / 2057	30 / 762	352	1587	n/a	n/a	n/a	n/a		
81 / 2057	36 / 914	421	1693	859	2134	n/a	n/a		
81 / 2057	42 / 1067	483	1770	927	2208	n/a	n/a		
81 / 2057	48 / 1219	534	1847	975	2289	n/a	n/a		
81 / 2057	54 / 1372	593	1928	n/a	n/a	1030	2368		
81 / 2057	60 / 1524	651	2033	n/a	n/a	1091	2468		

Pricing is continued on the following page.

mounted storage & accessories

Xpress

B _ W C O

Wall Panel for Overhead Cabinet and Shelf (Continued)

DIMENSIONS
INCHES / MM

PRICING

		MOUNTING STYLE (H) (CONTINUED)					
		15" OVERHEAD HEIGHT					
		BOTTOM & MIDDLE SHELVES (BM)					
		NO POWER AND DATA (NN)		POWER AND DATA (OC)		POWER AND DATA (OL, OR)	
		PANEL FINISH					
H	W	Source Laminate	Flintwood	Source Laminate	Flintwood	Source Laminate	Flintwood
81 / 2057	24 / 610	285	1477	n/a	n/a	n/a	n/a
81 / 2057	30 / 762	352	1587	n/a	n/a	n/a	n/a
81 / 2057	36 / 914	421	1693	859	2134	n/a	n/a
81 / 2057	42 / 1067	483	1770	927	2208	n/a	n/a
81 / 2057	48 / 1219	534	1847	975	2289	n/a	n/a
81 / 2057	54 / 1372	593	1928	n/a	n/a	1030	2368
81 / 2057	60 / 1524	651	2033	n/a	n/a	1091	2468
81 / 2057	66 / 1676	700	2136	n/a	n/a	1134	2579
81 / 2057	72 / 1829	757	2245	n/a	n/a	1204	2689
81 / 2057	78 / 1981	825	2351	n/a	n/a	1272	2788
81 / 2057	84 / 2134	891	2449	n/a	n/a	1327	2891

		MOUNTING STYLES (M or X)					
		15" OVERHEAD HEIGHT					
		BOTTOM SHELF (BN)					
		NO POWER AND DATA (NN)		POWER AND DATA (OC)		POWER AND DATA (OL, OR)	
		PANEL FINISH					
		Source Laminate	Flintwood	Source Laminate	Flintwood	Source Laminate	Flintwood
72 / 1829	24 / 610	249	1343	n/a	n/a	n/a	n/a
72 / 1829	30 / 762	307	1437	n/a	n/a	n/a	n/a
72 / 1829	36 / 914	365	1529	806	1969	n/a	n/a
72 / 1829	42 / 1067	423	1621	864	2059	n/a	n/a
72 / 1829	48 / 1219	465	1712	907	2152	n/a	n/a
72 / 1829	54 / 1372	516	1803	n/a	n/a	956	2243
72 / 1829	60 / 1524	564	1895	n/a	n/a	1005	2333
72 / 1829	66 / 1676	607	1986	n/a	n/a	1045	2427
72 / 1829	72 / 1829	661	2080	n/a	n/a	1105	2521
72 / 1829	78 / 1981	720	2172	n/a	n/a	1162	2611
72 / 1829	84 / 2134	777	2261	n/a	n/a	1217	2702
81 / 2057	24 / 610	285	1477	n/a	n/a	n/a	n/a
81 / 2057	30 / 762	352	1587	n/a	n/a	n/a	n/a
81 / 2057	36 / 914	421	1693	859	2134	n/a	n/a
81 / 2057	42 / 1067	483	1770	927	2208	n/a	n/a
81 / 2057	48 / 1219	534	1847	975	2289	n/a	n/a
81 / 2057	54 / 1372	593	1928	n/a	n/a	1030	2368
81 / 2057	60 / 1524	651	2033	n/a	n/a	1091	2468
81 / 2057	66 / 1676	700	2136	n/a	n/a	1134	2579
81 / 2057	72 / 1829	757	2245	n/a	n/a	1204	2689
81 / 2057	78 / 1981	825	2351	n/a	n/a	1272	2788
81 / 2057	84 / 2134	891	2449	n/a	n/a	1327	2891

Pricing is continued on the following page.

B _ W C O
Wall Panel for Overhead Cabinet
with Shelf (Continued)

DIMENSIONS
INCHES / MM

PRICING

DIMENSIONS		MOUNTING STYLE (K)					
INCHES / MM		15" OVERHEAD HEIGHT					
		BOTTOM SHELF (BN)					
		NO POWER AND DATA (NN)		POWER AND DATA (OC)		POWER AND DATA (OL, OR)	
		PANEL FINISH					
H	W	Source Laminate	Flintwood	Source Laminate	Flintwood	Source Laminate	Flintwood
66 / 1676	24 / 610	247	1312	n/a	n/a	n/a	n/a
66 / 1676	30 / 762	303	1401	n/a	n/a	n/a	n/a
66 / 1676	36 / 914	360	1492	802	1931	n/a	n/a
66 / 1676	42 / 1067	419	1591	858	2029	n/a	n/a
66 / 1676	48 / 1219	459	1691	902	2130	n/a	n/a
66 / 1676	54 / 1372	509	1787	n/a	n/a	951	2227
66 / 1676	60 / 1524	555	1877	n/a	n/a	996	2316
66 / 1676	66 / 1676	598	1968	n/a	n/a	1039	2408
66 / 1676	72 / 1829	655	2057	n/a	n/a	1097	2496
66 / 1676	78 / 1981	712	2147	n/a	n/a	1151	2587
66 / 1676	84 / 2134	768	2238	n/a	n/a	1212	2677
72 / 1829	24 / 610	278	1423	n/a	n/a	n/a	n/a
72 / 1829	30 / 762	337	1513	n/a	n/a	n/a	n/a
72 / 1829	36 / 914	396	1603	837	2043	n/a	n/a
72 / 1829	42 / 1067	455	1692	895	2131	n/a	n/a
72 / 1829	48 / 1219	505	1781	947	2222	n/a	n/a
72 / 1829	54 / 1372	560	1870	n/a	n/a	1000	2311
72 / 1829	60 / 1524	613	1969	n/a	n/a	1054	2409
72 / 1829	66 / 1676	664	2067	n/a	n/a	1104	2508
72 / 1829	72 / 1829	719	2167	n/a	n/a	1161	2608
72 / 1829	78 / 1981	778	2265	n/a	n/a	1220	2705
72 / 1829	84 / 2134	835	2363	n/a	n/a	1276	2803
81 / 2057	24 / 610	325	1590	n/a	n/a	n/a	n/a
81 / 2057	30 / 762	388	1681	n/a	n/a	n/a	n/a
81 / 2057	36 / 914	450	1770	890	2211	n/a	n/a
81 / 2057	42 / 1067	509	1844	951	2284	n/a	n/a
81 / 2057	48 / 1219	574	1916	1015	2360	n/a	n/a
81 / 2057	54 / 1372	637	1995	n/a	n/a	1074	2437
81 / 2057	60 / 1524	700	2107	n/a	n/a	1141	2549
81 / 2057	66 / 1676	763	2216	n/a	n/a	1202	2658
81 / 2057	72 / 1829	815	2332	n/a	n/a	1257	2776
81 / 2057	78 / 1981	877	2442	n/a	n/a	1324	2882
81 / 2057	84 / 2134	936	2551	n/a	n/a	1372	2992
		30" OVERHEAD HEIGHT					
		BOTTOM SHELF (BN)					
		NO POWER AND DATA (NN)		POWER AND DATA (OC)		POWER AND DATA (OL, OR)	
		PANEL FINISH					
H	W	Source Laminate	Flintwood	Source Laminate	Flintwood	Source Laminate	Flintwood
81 / 2057	24 / 610	325	1590	n/a	n/a	n/a	n/a
81 / 2057	30 / 762	388	1681	n/a	n/a	n/a	n/a
81 / 2057	36 / 914	450	1770	890	2211	n/a	n/a
81 / 2057	42 / 1067	509	1844	951	2284	n/a	n/a
81 / 2057	48 / 1219	574	1916	1015	2360	n/a	n/a
81 / 2057	54 / 1372	637	1995	n/a	n/a	1074	2437
81 / 2057	60 / 1524	700	2107	n/a	n/a	1141	2549

Pricing is continued on the following page.

mounted storage & accessories

Xpress

B _ W C O

Wall Panel for Overhead Cabinet and Shelf (Continued)

DIMENSIONS
INCHES / MM

PRICING

MOUNTING STYLE (K) (CONTINUED)

15" OVERHEAD HEIGHT

BOTTOM & MIDDLE SHELVES (BM)

NO POWER AND DATA (NN)

POWER AND DATA (OC)

POWER AND DATA (OL, OR)

PANEL FINISH

H	W	Source		Source		Source	
		Laminate	Flintwood	Laminate	Flintwood	Laminate	Flintwood
81 / 2057	24 / 610	325	1590	n/a	n/a	n/a	n/a
81 / 2057	30 / 762	388	1681	n/a	n/a	n/a	n/a
81 / 2057	36 / 914	450	1770	890	2211	n/a	n/a
81 / 2057	42 / 1067	509	1844	951	2284	n/a	n/a
81 / 2057	48 / 1219	574	1916	1015	2360	n/a	n/a
81 / 2057	54 / 1372	637	1995	n/a	n/a	1074	2437
81 / 2057	60 / 1524	700	2107	n/a	n/a	1141	2549
81 / 2057	66 / 1676	763	2216	n/a	n/a	1202	2658
81 / 2057	72 / 1829	815	2332	n/a	n/a	1257	2776
81 / 2057	78 / 1981	877	2442	n/a	n/a	1324	2882
81 / 2057	84 / 2134	936	2551	n/a	n/a	1372	2992

MOUNTING STYLE (L)

15" OVERHEAD HEIGHT

BOTTOM SHELF (BN)

NO POWER AND DATA (NN)

POWER AND DATA (OC)

POWER AND DATA (OL, OR)

PANEL FINISH

H	W	Source		Source		Source	
		Laminate	Flintwood	Laminate	Flintwood	Laminate	Flintwood
66 / 1676	24 / 610	268	1370	n/a	n/a	n/a	n/a
66 / 1676	30 / 762	328	1465	n/a	n/a	n/a	n/a
66 / 1676	36 / 914	391	1564	833	2003	n/a	n/a
66 / 1676	42 / 1067	455	1660	893	2098	n/a	n/a
66 / 1676	48 / 1219	499	1759	941	2199	n/a	n/a
66 / 1676	54 / 1372	552	1854	n/a	n/a	995	2293
66 / 1676	60 / 1524	604	1951	n/a	n/a	1044	2388
66 / 1676	66 / 1676	651	2050	n/a	n/a	1092	2489
66 / 1676	72 / 1829	713	2143	n/a	n/a	1155	2582
66 / 1676	78 / 1981	774	2241	n/a	n/a	1213	2680
66 / 1676	84 / 2134	835	2340	n/a	n/a	1279	2778
72 / 1829	24 / 610	306	1502	n/a	n/a	n/a	n/a
72 / 1829	30 / 762	367	1589	n/a	n/a	n/a	n/a
72 / 1829	36 / 914	426	1676	867	2117	n/a	n/a
72 / 1829	42 / 1067	486	1763	925	2203	n/a	n/a
72 / 1829	48 / 1219	545	1850	986	2291	n/a	n/a
72 / 1829	54 / 1372	604	1937	n/a	n/a	1044	2376
72 / 1829	60 / 1524	662	2043	n/a	n/a	1102	2484
72 / 1829	66 / 1676	720	2148	n/a	n/a	1162	2588
72 / 1829	72 / 1829	777	2253	n/a	n/a	1217	2694
72 / 1829	78 / 1981	836	2358	n/a	n/a	1278	2798
72 / 1829	84 / 2134	893	2465	n/a	n/a	1335	2903

