

mounted storage & accessories

Xpress

B_SLL

Single Tower Hutch with Shelves – Solid Doors

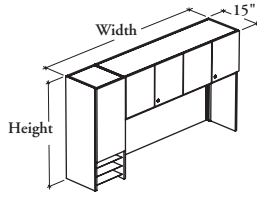

This hutch can be mounted on most desks and credenzas and provides overhead storage.

WHAT'S INCLUDED

1 hutch, 2 extrusions for tool rail, 1 removeable shelf per section (43" high hutch, central section only), 1 metal adjustable shelf (inside shelf tower), 3 metal fixed shelf (outside shelf tower), lock and keys (as specified), mounting hardware, and accessories as listed below:

	Width		
	36" to 48"	54" to 66"	72" to 84"
Door	2	3	4
Divider	n/a	1	1

WHAT'S EXCLUDED

Top for Hutch (B_HT) and accessories (BTU, BLTY, BLED, BOTB, BOHP, TBK6S, and BOTR).

NOTES

Tower door has a touch latch and is **not** lockable.

You must specify the thickness of the worksurface on which the hutch will be installed.

PRODUCT OPTIONS

Worksurface Thickness	Depth	Width	Height	Tower Configuration	Door Front Finish	Edge Trim Finish	Case Finish	Shelf and Hardware Finish	Key Style
D 1"	15	36, 42, 48, 54, 60, 66, 72, 78, 84	37, 43	L Left (Shown) R Right	Source Laminate	Edge Trim Colors	Source Laminate	Foundation	N No Lock K Keyed Alike R Keyed Randomly
M 1 3/16"					Foundation Laminate			Mica	
X 1 9/16"									

SAMPLE ORDER CODE

BMSLL	15	72	37	L	LW	ST	LE	E	K
--------------	-----------	-----------	-----------	----------	-----------	-----------	-----------	----------	----------

DIMENSIONS INCHES / MM

D	W	H
15 / 381	36 / 914	37 / 940
15 / 381	42 / 1067	37 / 940
15 / 381	48 / 1219	37 / 940
15 / 381	54 / 1372	37 / 940
15 / 381	60 / 1524	37 / 940
15 / 381	66 / 1676	37 / 940
15 / 381	72 / 1829	37 / 940
15 / 381	78 / 1981	37 / 940
15 / 381	84 / 2134	37 / 940
15 / 381	36 / 914	43 / 1093
15 / 381	42 / 1067	43 / 1093
15 / 381	48 / 1219	43 / 1093
15 / 381	54 / 1372	43 / 1093
15 / 381	60 / 1524	43 / 1093
15 / 381	66 / 1676	43 / 1093
15 / 381	72 / 1829	43 / 1093
15 / 381	78 / 1981	43 / 1093
15 / 381	84 / 2134	43 / 1093

PRICING

1" (D)		1 3/16" (M)		1 9/16" (X)	
DOOR FRONT FINISH					
Source Laminate	Foundation Laminate	Source Laminate	Foundation Laminate	Source Laminate	Foundation Laminate
1209	1261	1209	1261	1209	1261
1227	1290	1227	1290	1227	1290
1246	1315	1246	1315	1246	1315
1317	1370	1317	1370	1317	1370
1383	1472	1383	1472	1383	1472
1538	1633	1538	1633	1538	1633
1550	1650	1550	1650	1550	1650
1572	1674	1572	1674	1572	1674
1595	1696	1595	1696	1595	1696
1324	1380	1324	1380	1324	1380
1345	1411	1345	1411	1345	1411
1362	1439	1362	1439	1362	1439
1445	1502	1445	1502	1445	1502
1515	1615	1515	1615	1515	1615
1674	1784	1674	1784	1674	1784
1693	1810	1693	1810	1693	1810
1724	1844	1724	1844	1724	1844
1752	1869	1752	1869	1752	1869