

freestanding storage & accessories

Xpress

BSWCG

Wardrobe Cabinet – Glass Doors

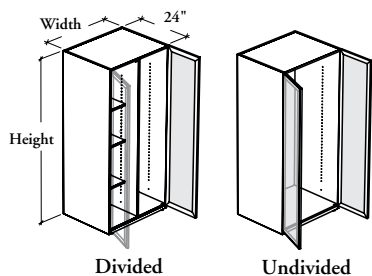

This storage provides a storage space for garments and other items.

WHAT'S INCLUDED

Divided wardrobe: 1 wardrobe cabinet, 1 coat rod, levelers, lock and keys (as specified), and adjustable half shelves as listed below:

	Height		
	66"	72"	81"
Adjustable Half Shelf	3	3	4

Adjustable Half Shelf

Undivided wardrobe: 1 wardrobe cabinet, 1 adjustable shelf (81" high only), 1 coat rod, levelers, lock and keys (as specified).

WHAT'S EXCLUDED

Top for Solid Storage and Hang-On Kit.

NOTES

Holes at 1 1/4" intervals on the inside of all panels allow for shelf adjustment.

Additional shelves (BSHE) may be specified separately.

Not all door finishes are available as Xpress, Please see Xpress catalogue and/or specification software for details.

PRODUCT OPTIONS

Storage Style	Style	Depth	Width	Height
T Touch-to-Open	D Divided U Undivided	24	30, 36	66, 72, 81

SAMPLE ORDER CODE

BSWCG T	D	24	36	72
----------------	----------	-----------	-----------	-----------

PRODUCT OPTIONS CONTINUED

Case Finish	Door Frame Finish	Glass Door Finish	Key Style
Source Laminate Flintwood (No Cathedral)	AC Clear Anodized Foundation Accent Mica	Standard: FT Frosted Back-Painted	K Keyed Alike R Keyed Randomly N No Lock

SAMPLE ORDER CODE CONTINUED

3B	AC	FT	N
-----------	-----------	-----------	----------

See Pricing on the following page.

B S W C G

**Wardrobe Cabinet – Glass Doors
(Continued)**

**DIMENSIONS
INCHES / MM**

D	W	H
24 / 610	30 / 762	66 / 1676
24 / 610	30 / 762	72 / 1829
24 / 610	30 / 762	81 / 2057
24 / 610	36 / 914	66 / 1676
24 / 610	36 / 914	72 / 1829
24 / 610	36 / 914	81 / 2057

PRICING

UNDIVIDED (U)		DIVIDED (D)	
FROSTED (FT) AND BACK-PAINTED GLASS DOORS			
CASE FINISH			
Source Laminate	Flintwood	Source Laminate	Flintwood
2986	3644	3540	4539
3116	3775	3686	4646
3373	3971	3938	4800
3222	3995	3834	4885
3373	4146	4003	4995
3678	4372	4295	5164

KEY UPCHARGE

Keyed Alike or Keyed Randomly
55
55
55
55
55
55