

freestanding storage & accessories

Xpress

BSU Storage Unit

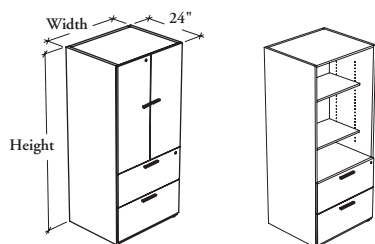

With Doors (D)

Open (O)

Storage Units combine the filing capabilities of a lateral file with the flexibility of a storage unit. The drawers accept both letter- and legal-size paper.

WHAT'S INCLUDED

1 storage unit with 2 lateral file drawers, pulls (as specified), 2 15" cross file bars (24" wide) or 4 15" cross file bars (30" or 36" wide), levelers, lock and keys, and adjustable shelves as listed below:

| Height | | |
|------------------|-----|-----|
| 66" | 72" | 81" |
| Adjustable Shelf | 2 | 2 3 |

Adjustable Shelf

WHAT'S EXCLUDED

Top for Solid Storage.

NOTES

Drawers have a central locking security system that disables the opening of a second drawer.

The doors have their own locking system.

Holes at 1 1/4" intervals on the inside of side panels of the top section allow for shelf adjustment.

Additional shelves (BSHE) are available and must be ordered separately.

The included cross file bars are to be installed along the depth only.

Soft Touch (2) and Standard T/O/S (4) pulls are only available in limited Foundation colors. Refer to the specification software for details.

PRODUCT OPTIONS

| Door Option | Depth | Width | Height | Door and Drawer Front Finish | Edge Trim Finish (Laminate Front only) | Case Finish | Pull Style | Pull Finish | Key Style |
|-------------|-------|------------|------------|------------------------------|--|--------------------------|----------------------|-----------------|---------------|
| D Doors | 24 | 24, 30, 36 | 66, 72, 81 | Source Laminate | Edge Trim Colors | Source Laminate | 1 Standard Expansion | Foundation Mica | K Keyed Alike |
| O Open | | | | Foundation Laminate | | Flintwood (No Cathedral) | | | |
| | | | | Flintwood (No Cathedral) | | | 4 Standard T/O/S | | |
| | | | | | | | 6 Arched | | |
| | | | | | | | 7 Elliptical | | |
| | | | | | | | 9 Rectilinear | | |

SAMPLE ORDER CODE

| | | | | | | | | | |
|-------|----|----|----|----|----|----|---|---|---|
| BSU D | 24 | 24 | 66 | 3E | 4E | 3E | 1 | E | R |
|-------|----|----|----|----|----|----|---|---|---|

DIMENSIONS INCHES / MM

| D | W | H |
|----------|----------|-----------|
| 24 / 610 | 24 / 610 | 66 / 1676 |
| 24 / 610 | 24 / 610 | 72 / 1829 |
| 24 / 610 | 24 / 610 | 81 / 2057 |
| 24 / 610 | 30 / 762 | 66 / 1676 |
| 24 / 610 | 30 / 762 | 72 / 1829 |
| 24 / 610 | 30 / 762 | 81 / 2057 |
| 24 / 610 | 36 / 914 | 66 / 1676 |
| 24 / 610 | 36 / 914 | 72 / 1829 |
| 24 / 610 | 36 / 914 | 81 / 2057 |

PRICING

| OPEN (O) | | | | DOORS (D) | | | |
|------------------------------|---------------------|-----------------------|-----------|-----------------------------|---------------------|-----------------------|-----------|
| SOURCE LAMINATE CASE FINISH | | FLINTWOOD CASE FINISH | | SOURCE LAMINATE CASE FINISH | | FLINTWOOD CASE FINISH | |
| DOOR AND DRAWER FRONT FINISH | | | | | | | |
| Source Laminate | Foundation Laminate | Flintwood | Flintwood | Source Laminate | Foundation Laminate | Flintwood | Flintwood |
| 1518 | 1595 | 2142 | 2963 | 1670 | 1818 | 2310 | 3288 |
| 1569 | 1658 | 2192 | 3033 | 1740 | 1910 | 2366 | 3365 |
| 1619 | 1723 | 2269 | 3139 | 1885 | 2094 | 2452 | 3482 |
| 1592 | 1699 | 2463 | 3409 | 1770 | 1968 | 2642 | 3738 |
| 1647 | 1769 | 2526 | 3493 | 1850 | 2077 | 2708 | 3831 |
| 1699 | 1842 | 2620 | 3621 | 2014 | 2290 | 2808 | 3969 |
| 1703 | 1855 | 2813 | 3890 | 1910 | 2171 | 3013 | 4231 |
| 1758 | 1933 | 2886 | 3990 | 1995 | 2295 | 3092 | 4338 |
| 1814 | 2010 | 2997 | 4139 | 2182 | 2546 | 3210 | 4501 |