

freestanding storage & accessories

This storage combines the organizational capabilities of a storage unit with the storage capacity of a wardrobe. The drawers accept both letter- and legal-size paper.

BSUWG

Storage Unit with Wardrobe – Glass Doors

WHAT'S INCLUDED

1 half-wardrobe, 2 lateral file drawers, 1 storage unit, 1 adjustable wardrobe shelf (81" high only), 1 coat rod, 2 15" cross file bars, pulls (as specified), levelers, lock and keys, and adjustable shelves as listed below:

	Height		
	66"	72"	81"
Adjustable Shelf	2	2	3

WHAT'S EXCLUDED

Top for Solid Storage.

NOTES

The Storage Unit with Wardrobe has a central locking security system that disables the opening of a second drawer.

Holes at 1 1/4" intervals on the inside of side panels of the top section allow for shelf adjustment.

The included cross file bars are to be installed along the depth only.

Soft Touch (2) and Standard T/O/S (4) pulls are only available in limited Foundation colors. Refer to the specification software for details.

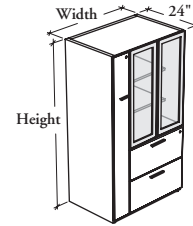

PRODUCT OPTIONS

Depth	Width	Height	Drawer Configuration	Door and Drawer Front Finish	Edge Trim Finish	Case Finish	Door Frame Finish	Glass Door Finish	Pull Style	Pull Finish	Key Style	Glass Door Lock
24	30, 36	66, 72, 81	L Left	Source Laminate	Edge Trim Colors	Source Laminate	AC Clear Anodized	Standard: CL Clear	1 Standard Expansion	Foundation Mica	K Keyed Alike	0 No
			R Right (Shown)	Foundation Laminate			Foundation Accent Mica	FT Frosted Back-Painted				2 Soft Touch 4 Standard T/O/S 6 Arched 7 Elliptical 9 Rectilinear

SAMPLE ORDER CODE

BSUWG 24	36	66	L	LW	ST	XS	E	CL	1	E	R	1
--------------------	-----------	-----------	----------	-----------	-----------	-----------	----------	-----------	----------	----------	----------	----------

695

DIMENSIONS INCHES / MM

D	W	H
24 / 610	30 / 762	66 / 1676
24 / 610	30 / 762	72 / 1829
24 / 610	30 / 762	81 / 2057
24 / 610	36 / 914	66 / 1676
24 / 610	36 / 914	72 / 1829
24 / 610	36 / 914	81 / 2057

PRICING

CLEAR GLASS DOORS (CL)		FROSTED GLASS DOORS (FT)/ BACK-PAINTED GLASS DOORS	
DOOR AND DRAWER FRONT FINISH			
Source Laminate	Foundation Laminate	Source Laminate	Foundation Laminate
2735	2861	2942	3068
2837	2969	3087	3219
2939	3077	3202	3340
2865	3023	3115	3273
2968	3129	3268	3429
3070	3237	3395	3562

KEY UPCHARGE

Glass Door Lock (1)
42
42
42
42
42
42