

# freestanding storage & accessories

**Xpress**

## BSUOS Storage Unit – Open Shelves

Storage Units combine the filing capabilities of a lateral file with the flexibility of a storage unit. The drawers accept both letter- and legal-size paper.

### WHAT'S INCLUDED

1 storage unit with 2 lateral file drawers, pulls (as specified), 2 15" cross file bars (24" wide) or 4 15" cross file bars (30" or 36" wide), levelers, lock and keys (as specified), and adjustable shelves as listed below:

	Height		
	66"	72"	81"
Adjustable Shelf	2	2	3

Adjustable Shelf

### WHAT'S EXCLUDED

Top for Solid Storage and Hang-On Kit.

### NOTES

Drawers have a central locking security system that disables the opening of a second drawer.

Holes at 1 1/4" intervals on the inside of side panels of the top section allow for shelf adjustment.

Additional shelves (BSHE) are available and must be ordered separately.

The included cross file bars are to be installed along the depth only.

Edge trim finish on drawer front always match drawer front finish (Source or Foundation Laminate).

Not all finishes are available as Xpress, Please see Xpress catalogue and/or specification software for details.

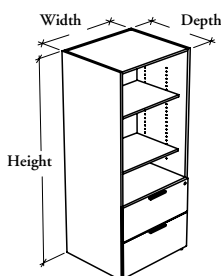

### PRODUCT OPTIONS

Storage Style	Depth	Width	Height	Drawer Front Finish
P Pulls	18, 20, 24	24, 30, 36	66, 72, 81	Source Laminate Foundation Laminate Flintwood (No Cathedral)

### SAMPLE ORDER CODE

<b>BSUOS P</b>	<b>24</b>	<b>24</b>	<b>66</b>	<b>3E</b>
----------------	-----------	-----------	-----------	-----------

### PRODUCT OPTIONS CONTINUED

Case Finish	Pull Style	Pull Finish	Key Style
Source Laminate Flintwood (No Cathedral)	1 Standard Expansion 6 Arched 9 Rectilinear	Foundation Mica	K Keyed Alike R Keyed Randomly N No Lock

### SAMPLE ORDER CODE CONTINUED

<b>3E</b>	<b>1</b>	<b>E</b>	<b>R</b>
-----------	----------	----------	----------

See Pricing on the following page.

**BSUOS**  
**Storage Unit – Open Shelves**  
**(Continued)**

**DIMENSIONS**  
**INCHES / MM**

D	W	H
18 / 457	24 / 610	66 / 1676
18 / 457	24 / 610	72 / 1829
18 / 457	24 / 610	81 / 2057
18 / 457	30 / 762	66 / 1676
18 / 457	30 / 762	72 / 1829
18 / 457	30 / 762	81 / 2057
18 / 457	36 / 914	66 / 1676
18 / 457	36 / 914	72 / 1829
18 / 457	36 / 914	81 / 2057
20 / 508	24 / 610	66 / 1676
20 / 508	24 / 610	72 / 1829
20 / 508	24 / 610	81 / 2057
20 / 508	30 / 762	66 / 1676
20 / 508	30 / 762	72 / 1829
20 / 508	30 / 762	81 / 2057
20 / 508	36 / 914	66 / 1676
20 / 508	36 / 914	72 / 1829
20 / 508	36 / 914	81 / 2057
24 / 610	24 / 610	66 / 1676
24 / 610	24 / 610	72 / 1829
24 / 610	24 / 610	81 / 2057
24 / 610	30 / 762	66 / 1676
24 / 610	30 / 762	72 / 1829
24 / 610	30 / 762	81 / 2057
24 / 610	36 / 914	66 / 1676
24 / 610	36 / 914	72 / 1829
24 / 610	36 / 914	81 / 2057

**PRICING**

SOURCE LAMINATE CASE FINISH			FLINTWOOD CASE FINISH
DRAWER FRONT FINISH			
Source Laminate	Foundation Laminate	Flintwood	Flintwood
1821	1919	2624	3516
1879	1994	2681	3589
1929	2064	2768	3699
1904	2042	3026	4065
1966	2123	3098	4155
2022	2205	3209	4294
2033	2231	3465	4660
2096	2322	3551	4770
2156	2410	3683	4933
1888	1987	2694	3668
1950	2065	2754	3749
2008	2143	2845	3872
1978	2117	3101	4231
2044	2202	3177	4329
2108	2291	3293	4480
2116	2312	3546	4837
2182	2408	3635	4957
2247	2500	3773	5135
1956	2057	2761	3820
2023	2138	2826	3909
2087	2223	2924	4045
2053	2189	3175	4393
2123	2282	3256	4502
2189	2375	3377	4668
2196	2390	3626	5015
2265	2492	3720	5143
2340	2590	3863	5335