

# freestanding storage & accessories

**Xpress**

## BSUG

### Storage Unit – Glass Doors

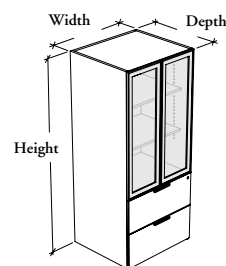

Storage Unit combines the filing capabilities of a lateral file with the flexibility of a storage unit. The drawers accepts both letter- and legal-size paper.

#### WHAT'S INCLUDED

1 storage unit with 2 lateral file drawers, pulls (as specified), 2 15" cross file bars (24" wide) or 4 15" cross file bars (30" or 36" wide), levelers, lock and keys (as specified), and adjustable shelves as listed below:

	Height		
	66"	72"	81"
Adjustable Shelf	2	2	3

Adjustable Shelf

#### WHAT'S EXCLUDED

Top for Solid Storage and Hang-On Kit.

#### NOTES

Drawers have a central locking security system that disables the opening of a second drawer.

Holes at 1 1/4" intervals on the inside of side panels of the top section allow for shelf adjustment.

Additional shelves (BSHE) are available and must be ordered separately.

The included cross file bars are to be installed along the depth only.

Edge trim finish on drawer front always match drawer front finish (Source or Foundation Laminate).

Not all glass finishes are available as Xpress, Please see Xpress catalogue and/or specification software for details.

#### PRODUCT OPTIONS

Storage Style	Depth	Width	Height	Drawer Front Finish	Case Finish
<b>S</b> Touch-to-Open Doors/Pulls on Drawers	18, 20, 24	24, 30, 36	66, 72, 81	Source Laminate Foundation Laminate Flintwood (No Cathedral)	Source Laminate Flintwood (No Cathedral)

#### SAMPLE ORDER CODE

<b>BSUG S</b>	<b>24</b>	<b>24</b>	<b>66</b>	<b>LW</b>	<b>XS</b>
---------------	-----------	-----------	-----------	-----------	-----------

#### PRODUCT OPTIONS CONTINUED

Door Frame Finish	Glass Door Finish	Pull Style	Pull Finish	Drawer Key Style	Glass Door Lock
<b>AC</b> Clear Anodized Foundation Accent Mica	<b>Standard:</b> <b>CL</b> Clear <b>FT</b> Frosted <b>Back-Painted</b>	<b>1</b> Standard Expansion <b>6</b> Arched <b>9</b> Rectilinear	Foundation Mica	<b>K</b> Keyed Alike <b>R</b> Keyed Randomly <b>N</b> No Lock	<b>0</b> No <b>1</b> Yes

#### SAMPLE ORDER CODE CONTINUED

<b>Q</b>	<b>FT</b>	<b>9</b>	<b>Q</b>	<b>K</b>	<b>1</b>
----------	-----------	----------	----------	----------	----------

See Pricing on the following page.

Storage Unit – Glass Doors  
(Continued)

DIMENSIONS  
INCHES / MM

D	W	H
18 / 457	24 / 610	66 / 1676
18 / 457	24 / 610	72 / 1829
18 / 457	24 / 610	81 / 2057
18 / 457	30 / 762	66 / 1676
18 / 457	30 / 762	72 / 1829
18 / 457	30 / 762	81 / 2057
18 / 457	36 / 914	66 / 1676
18 / 457	36 / 914	72 / 1829
18 / 457	36 / 914	81 / 2057
20 / 508	24 / 610	66 / 1676
20 / 508	24 / 610	72 / 1829
20 / 508	24 / 610	81 / 2057
20 / 508	30 / 762	66 / 1676
20 / 508	30 / 762	72 / 1829
20 / 508	30 / 762	81 / 2057
20 / 508	36 / 914	66 / 1676
20 / 508	36 / 914	72 / 1829
20 / 508	36 / 914	81 / 2057
24 / 610	24 / 610	66 / 1676
24 / 610	24 / 610	72 / 1829
24 / 610	24 / 610	81 / 2057
24 / 610	30 / 762	66 / 1676
24 / 610	30 / 762	72 / 1829
24 / 610	30 / 762	81 / 2057
24 / 610	36 / 914	66 / 1676
24 / 610	36 / 914	72 / 1829
24 / 610	36 / 914	81 / 2057

PRICING

CLEAR GLASS DOORS (CL)

SOURCE LAMINATE CASE FINISH

FLINTWOOD CASE FINISH

DRAWER FRONT FINISH

Source Laminate	Foundation Laminate	Flintwood	Flintwood
2822	2921	3626	4518
2959	3073	3762	4669
3159	3435	4139	5072
2982	3119	4103	5142
3127	3289	4264	5321
3413	3755	4758	5844
3187	3379	4614	5808
3327	3554	4784	6002
3609	4024	5297	6549
2891	2989	3693	4670
3031	3145	3834	4830
3239	3514	4217	5246
3058	3195	4179	5307
3205	3367	4343	5495
3496	3841	4844	6032
3268	3461	4696	5986
3413	3640	4869	6189
3699	4116	5387	6750
2958	3058	3763	4820
3103	3217	3906	4989
3316	3593	4297	5418
3131	3268	4251	5473
3285	3445	4421	5668
3581	3924	4928	6218
3348	3541	4777	6163
3495	3724	4953	6377
3790	4205	5478	6948

KEY UPCHARGE

Glass Door Lock (1)

55
55
55
55
55
55
55
55
55
55
55
55
55
55
55
55
55
55
55
55
55
55
55
55
55
55
55
55
55
55
55
55
55
55
55
55
55
55

Pricing is continued on the following page.

# freestanding storage & accessories

**Xpress**

## BSUG

### Storage Unit – Glass Doors (Continued)

DIMENSIONS  
INCHES / MM

PRICING

KEY UPCHARGE

			FROSTED (FT) AND BACK-PAINTED GLASS DOORS				
			SOURCE LAMINATE CASE FINISH		FLINTWOOD CASE FINISH		
			DRAWER FRONT FINISH				
D	W	H	Source Laminate	Foundation Laminate	Flintwood	Flintwood	Glass Door Lock (1)
18 / 457	24 / 610	66 / 1676	2822	2921	3626	4518	55
18 / 457	24 / 610	72 / 1829	2959	3073	3762	4669	55
18 / 457	24 / 610	81 / 2057	3159	3435	4139	5072	55
18 / 457	30 / 762	66 / 1676	2982	3119	4103	5142	55
18 / 457	30 / 762	72 / 1829	3127	3289	4264	5321	55
18 / 457	30 / 762	81 / 2057	3413	3755	4758	5844	55
18 / 457	36 / 914	66 / 1676	3187	3379	4614	5808	55
18 / 457	36 / 914	72 / 1829	3327	3554	4784	6002	55
18 / 457	36 / 914	81 / 2057	3609	4024	5297	6549	55
20 / 508	24 / 610	66 / 1676	2891	2989	3693	4670	55
20 / 508	24 / 610	72 / 1829	3031	3145	3834	4830	55
20 / 508	24 / 610	81 / 2057	3239	3514	4217	5246	55
20 / 508	30 / 762	66 / 1676	3058	3195	4179	5307	55
20 / 508	30 / 762	72 / 1829	3205	3367	4343	5495	55
20 / 508	30 / 762	81 / 2057	3496	3841	4844	6032	55
20 / 508	36 / 914	66 / 1676	3268	3461	4696	5986	55
20 / 508	36 / 914	72 / 1829	3413	3640	4869	6189	55
20 / 508	36 / 914	81 / 2057	3699	4116	5387	6750	55
24 / 610	24 / 610	66 / 1676	2958	3058	3763	4820	55
24 / 610	24 / 610	72 / 1829	3103	3217	3906	4989	55
24 / 610	24 / 610	81 / 2057	3316	3593	4297	5418	55
24 / 610	30 / 762	66 / 1676	3131	3268	4251	5473	55
24 / 610	30 / 762	72 / 1829	3285	3445	4421	5668	55
24 / 610	30 / 762	81 / 2057	3581	3924	4928	6218	55
24 / 610	36 / 914	66 / 1676	3348	3541	4777	6163	55
24 / 610	36 / 914	72 / 1829	3495	3724	4953	6377	55
24 / 610	36 / 914	81 / 2057	3790	4205	5478	6948	55