

storage for secondary desks

Xpress

BSSD

Storage Cabinet for Secondary Desk

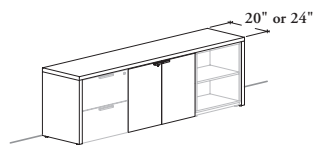
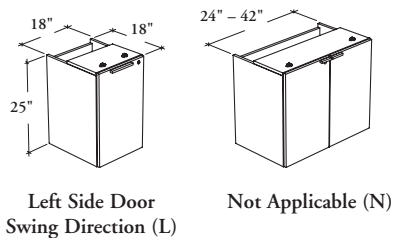

This modular storage allows to provide additional storage and ensure to support secondary desk. The proper mix of end and center storage position will allow filling the whole span of a Secondary Desk. When Yes (Y) in front of height-adjustable mechanism option is specified, the storage allows to hide the height-adjustable mechanism.

WHAT'S INCLUDED

1 storage cabinet with levelers, pulls (as specified), mounting hardware, lock and keys, and accessories as listed below:

	Width	
	18"	24" – 42"
Adjustable Shelf	1	1
Door	1	2

WHAT'S EXCLUDED

High Secondary Desk or all High Secondary Desk for Height-Adjustable Worksurfaces.

NOTES

The end position must be specified next to a secondary desk gable in order to compensate its thickness creepage.

Left or Right door swing direction is available with 18" wide cabinet only.

The shelf has a five positions adjustment with 1 1/4" intervals.

Additional shelves (BSHE) **cannot** be specified separately.

Can be used as a passive storage at the intersection of the secondary desk with the run-off worksurface, run-off with glass top, overlapping bridge and Height-Adjustable Worksurfaces.

The high version will **not** allow two rows of standard letter-size binders.

Not all finishes are available as Xpress, Please see Xpress catalogue and/or specification software for details.

PRODUCT OPTIONS

Position – Worksurface Thickness	In Front of Height-Adjustable Mechanism	Secondary Desk Height	Secondary Desk Depth	Width
C Center (Shown)	N No	H High	20, 24	18, 24, 30, 36, 42
D End – 1" thick Secondary Desk	Y Yes			
M End – 1 3/16" thick Secondary Desk				
X End – 1 9/16" thick Secondary Desk				

SAMPLE ORDER CODE

BSSD D	N	H	24	42
---------------	----------	----------	-----------	-----------

PRODUCT OPTIONS CONTINUED

Door Swing Direction	Door Front Finish	Case Finish	Pull Style	Pull Finish	Key Style
L Left Side (Shown)	Source Laminate	Source Laminate	9 Rectilinear	Foundation	N No Lock K Keyed Alike R Keyed Randomly
R Right Side	Flintwood (No Cathedral)	Flintwood (No Cathedral)		Mica	
N Not Applicable					

SAMPLE ORDER CODE CONTINUED

N	XS	XS	9	7	R
----------	-----------	-----------	----------	----------	----------

See Pricing on the following page

BSSD

Storage Cabinet for Secondary Desk
(Continued)

DIMENSIONS
INCHES / MM

POSITION – WORKSURFACE THICKNESS
(C, M, X)

POSITION – WORKSURFACE THICKNESS
(C, M, X)

YES IN FRONT OF HEIGHT-ADJUSTABLE MECHANISM (Y)

HIGH (H)

SOURCE LAMINATE CASE FINISH

FLINTWOOD CASE FINISH

DOOR FRONT FINISH

D	W
20 / 508	18 / 457
20 / 508	24 / 610
20 / 508	30 / 762
20 / 508	36 / 914
20 / 508	42 / 1067
24 / 610	18 / 457
24 / 610	24 / 610
24 / 610	30 / 762
24 / 610	36 / 914
24 / 610	42 / 1067

Source Laminate	Flintwood
530	825
568	1109
608	1202
643	1401
678	1493
587	882
625	1166
665	1259
699	1457
735	1550

Flintwood	
1789	
2027	
2263	
2384	
2501	
1846	
2084	
2320	
2440	
2558	

POSITION – WORKSURFACE THICKNESS
(C, D, M, X)

POSITION – WORKSURFACE THICKNESS
(C, M, X)

NO IN FRONT OF HEIGHT-ADJUSTABLE MECHANISM (N)

HIGH (H)

SOURCE LAMINATE CASE FINISH

FLINTWOOD CASE FINISH

DOOR FRONT FINISH

20 / 508	18 / 457
20 / 508	24 / 610
20 / 508	30 / 762
20 / 508	36 / 914
20 / 508	42 / 1067
24 / 610	18 / 457
24 / 610	24 / 610
24 / 610	30 / 762
24 / 610	36 / 914
24 / 610	42 / 1067

Source Laminate	Flintwood
587	882
625	1166
665	1259
699	1457
735	1550
587	882
625	1166
665	1259
699	1457
735	1550

Flintwood	
1846	
2084	
2320	
2440	
2558	
1846	
2084	
2320	
2440	
2558	