

freestanding storage & accessories

Xpress

B S O C

Corner Bookcase

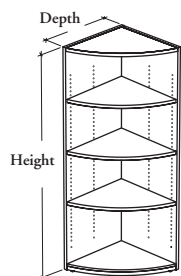

The Corner Bookcase provides open storage space within the workstation.

WHAT'S INCLUDED

1 corner shelf, levelers, and 1" thick shelves as listed below:

Depth	Shelf Type	Height				
		28"	40"	53"	66"	72"
18"	Adjustable	1	2	2	3	4
24"	Adjustable	1	2	2	3	4

WHAT'S EXCLUDED

Top for Corner Bookcase.

NOTES

Holes at 1 1/4" intervals on the inside of side panels allow for shelf adjustment.

Two rows of standard letter-size binders will **not** fit in the 28" high Corner Bookcase.

Must be placed against a wall corner for stability.

PRODUCT OPTIONS

Depth	Height	Case Finish
18, 24	28, 40, 53, 66, 72	Source Laminate

SAMPLE ORDER CODE

BSOC 24	72	3D
----------------	-----------	-----------

DIMENSIONS INCHES / MM

D	H
18 / 457	28 / 711
18 / 457	40 / 1016
18 / 457	53 / 1346
18 / 457	66 / 1676
18 / 457	72 / 1829
24 / 610	28 / 711
24 / 610	40 / 1016
24 / 610	53 / 1346
24 / 610	66 / 1676
24 / 610	72 / 1829

PRICING

460
669
686
828
935
501
743
757
914
1031