

workwall storage

Xpress

BSOBC 

Workwall Bookcase – Integral Top – 29" h – Cross Grain

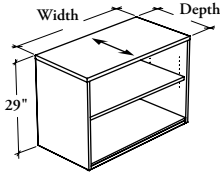

This bookcase provides open storage space within the workstation. It includes a finished top and can be fitted with a 29" high worksurface of a desk.

WHAT'S INCLUDED

1 workwall open bookcase with levelers, 1 integral top, and 1 adjustable shelf.

NOTES

Holes at 1 1/4" intervals on the inside walls of side panels allow for shelf adjustment.

Additional shelves **cannot** be specified with this product.

Allows two rows of standard letter-size binders.

The 1 9/16" (X) thickness is **not** available in all Foundation Laminate and Edge Trim colors. Refer to the finish page of the Application Guide for details.

Not all finishes are available as Xpress, Please see Xpress catalogue and/or specification software for details.

PRODUCT OPTIONS

Worksurface Thickness	Depth	Width	Height	Worksurface Finish	Edge Trim Style	Edge Trim Finish	Case Finish
M 1 3/16"	20, 24, 27	24, 30, 36	29	Foundation Laminate Flintwood (No Cathedral)	6 Straight Trim	Edge Trim Colors (for trim style 6 or 8)	Source Laminate Flintwood (No Cathedral)
X 1 9/16"					8 Flat Trim		
	9 Flintwood Flat Trim						

SAMPLE ORDER CODE

BSOBC M	20	36	29	RV	6	SS	XG
----------------	-----------	-----------	-----------	-----------	----------	-----------	-----------

DIMENSIONS INCHES / MM

D	W	H
20 / 508	24 / 610	29 / 737
20 / 508	30 / 762	29 / 737
20 / 508	36 / 914	29 / 737
24 / 610	24 / 610	29 / 737
24 / 610	30 / 762	29 / 737
24 / 610	36 / 914	29 / 737
27 / 686	24 / 610	29 / 737
27 / 686	30 / 762	29 / 737
27 / 686	36 / 914	29 / 737

PRICING

1 3/16" (M)		
FOUNDATION LAMINATE WORKSURFACE FINISH		FLINTWOOD WORKSURFACE FINISH
CASE FINISH		
	Source Laminate	Source Laminate Flintwood
	818	1384 2950
	905	1535 3155
	999	1681 3467
	947	1538 3290
	1042	1697 3524
	1141	1864 3866
	1010	1615 3459
	1110	1779 3709
	1215	1955 4067

Pricing is continued on the following page.



**Workwall Bookcase – Integral Top –
29" h – Cross Grain (Continued)**

**DIMENSIONS
INCHES / MM**

D	W	H
20 / 508	24 / 610	29 / 737
20 / 508	30 / 762	29 / 737
20 / 508	36 / 914	29 / 737
24 / 610	24 / 610	29 / 737
24 / 610	30 / 762	29 / 737
24 / 610	36 / 914	29 / 737
27 / 686	24 / 610	29 / 737
27 / 686	30 / 762	29 / 737
27 / 686	36 / 914	29 / 737

PRICING

1 9/16" (X)			
FOUNDATION LAMINATE WORKSURFACE FINISH		FLINTWOOD WORKSURFACE FINISH	
CASE FINISH			
	Source Laminate	Source Laminate	Flintwood
	853	1457	2985
	951	1627	3202
	1060	1801	3529
	1009	1663	3354
	1112	1839	3596
	1217	2013	3943
	1087	1769	3537
	1194	1946	3792
	1296	2119	4149