

# freestanding storage & accessories

**Xpress**

**BSMFL**

## Mid-Height Credenza – Open and Drawers

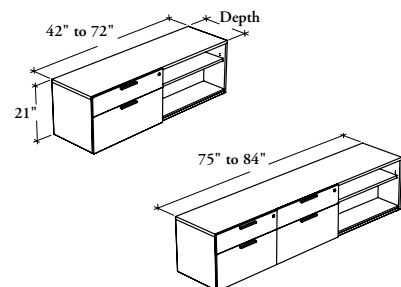

This standalone credenza provides a convenient storage areas with shelving and filing that accepts both letter- and legal-size papers for Multi-Level Workstations – Mid-Height.

**WHAT'S INCLUDED**

1 mid-height credenza with levelers, 1 adjustable shelf, pulls (as specified), counterweights (if applicable), lock and keys (as specified), and accessories as listed below:

	1 Box & 1 File Drawers		2 Box & 2 File Drawers	
	42" to 48"	51" to 72"	75" to 81"	84"
Widths				
Pencil Tray	1	1	2	2
12" Hanging File Bar	1	2	2	4

**WHAT'S EXCLUDED**

Seat Pad/Cushion and Wall Panels.

**NOTES**

Holes at 1 1/4" intervals on the inside walls of side panels allow for shelf adjustment.

The included 12" hanging file bar are to be installed along the depth only.

Additional shelves **cannot** be specified with this product.

Edge trim finish on drawer front always match drawer front finish (Source Laminate).

**Not all finishes** are available as Xpress, Please see Xpress catalogue and/or specification software for details.

**PRODUCT OPTIONS**

Depth	Width	Height	Drawer Configuration	Drawer Front Finish
18, 20	42, 45, 48, 51, 54, 57, 60, 63, 66, 69, 72, 75, 78, 81, 84	21	<b>L</b> Left (Shown) <b>R</b> Right	Source Laminate Flintwood (No Cathedral)

**SAMPLE ORDER CODE**

<b>BSMFL 18</b>	<b>72</b>	<b>21</b>	<b>R</b>	<b>XS</b>
-----------------	-----------	-----------	----------	-----------

**PRODUCT OPTIONS CONTINUED**

Case Finish	Pull Style	Pull Finish	Key Style
Source Laminate Flintwood (No Cathedral)	<b>9</b> Rectilinear	Foundation Mica	<b>K</b> Keyed Alike <b>R</b> Keyed Randomly <b>N</b> No Lock

**SAMPLE ORDER CODE CONTINUED**

<b>XS</b>	<b>9</b>	<b>74</b>	<b>N</b>
-----------	----------	-----------	----------

See Pricing on the following page.

**B S M F L**  
**Mid-Height Credenza – Open and Drawers (Continued)**

**DIMENSIONS**  
**INCHES / MM**

D	W	H
18 / 457	42 / 1067	21 / 533
18 / 457	45 / 1143	21 / 533
18 / 457	48 / 1219	21 / 533
18 / 457	51 / 1294	21 / 533
18 / 457	54 / 1372	21 / 533
18 / 457	57 / 1448	21 / 533
18 / 457	60 / 1524	21 / 533
18 / 457	63 / 1600	21 / 533
18 / 457	66 / 1676	21 / 533
18 / 457	69 / 1753	21 / 533
18 / 457	72 / 1829	21 / 533
18 / 457	75 / 1905	21 / 533
18 / 457	78 / 1981	21 / 533
18 / 457	81 / 2057	21 / 533
18 / 457	84 / 2134	21 / 533
20 / 508	42 / 1067	21 / 533
20 / 508	45 / 1143	21 / 533
20 / 508	48 / 1219	21 / 533
20 / 508	51 / 1294	21 / 533
20 / 508	54 / 1372	21 / 533
20 / 508	57 / 1448	21 / 533
20 / 508	60 / 1524	21 / 533
20 / 508	63 / 1600	21 / 533
20 / 508	66 / 1676	21 / 533
20 / 508	69 / 1753	21 / 533
20 / 508	72 / 1829	21 / 533
20 / 508	75 / 1905	21 / 533
20 / 508	78 / 1981	21 / 533
20 / 508	81 / 2057	21 / 533
20 / 508	84 / 2134	21 / 533

**PRICING**

SOURCE LAMINATE DRAWER FRONT FINISH		FLINTWOOD DRAWER FRONT FINISH	
CASE FINISH		CASE FINISH	
	Source Laminate	Source Laminate	Flintwood
	1281	1659	2618
	1314	1721	2662
	1348	1757	2704
	1431	1871	2812
	1467	1906	2854
	1500	2206	2897
	1608	2315	3029
	1633	2388	3071
	1656	2414	3113
	1680	2467	3155
	1788	2575	3739
	2290	3108	4213
	2297	3112	4192
	2304	3150	4172
	2311	3158	4180
	1344	1723	2739
	1379	1786	2790
	1413	1822	2841
	1496	1937	2957
	1531	1970	3009
	1565	2270	3060
	1696	2404	3200
	1735	2492	3250
	1771	2529	3301
	1808	2596	3354
	1903	2692	3917
	2431	3250	4422
	2439	3255	4404
	2473	3321	4415
	2553	3399	4498