

# freestanding storage & accessories

Xpress

## B S C L B

### Half Wardrobe Unit with Box/Box/ File – Solid Doors

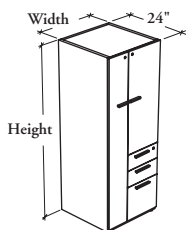

This unit provides a lockable storage area to store garments and other items combined with the filing capabilities of a pedestal (letter- and legal-size paper).

#### WHAT'S INCLUDED

1 storage unit, 2 adjustable shelves, 1 pencil tray, 1 drawer divider, 1 12" hanging file bar, 1 coat rod, pulls, levelers, lock and keys.

#### WHAT'S EXCLUDED

Top for Solid Storage and Hang-On Kit.

#### NOTES

Holes at 1 1/4" intervals on the inside walls of side panels of the top section allow for shelf adjustment.

Width of drawers is fixed. Only the wardrobe width varies.

Hanging file bars are included along the width only.

Soft Touch (2) and Standard T/O/S (4) pulls are only available in limited Foundation colors. Refer to the specification software for details.

#### PRODUCT OPTIONS

Depth	Width	Height	Drawer Configuration	Door and Drawer Front Finish	Edge Trim Finish (Laminate Front only)	Case Finish	Pull Style	Pull Finish	Key Style
24	24, 30, 36	66, 72	L Left R Right (Shown)	Source Laminate Foundation Laminate Flintwood (No Cathedral)	Edge Trim Colors	Source Laminate Flintwood (No Cathedral)	1 Standard Expansion 2 Soft Touch 4 Standard T/O/S 6 Arched 7 Elliptical 9 Rectilinear	Foundation Mica	K Keyed Alike R Keyed Randomly

#### SAMPLE ORDER CODE

BSCLB 24	30	72	R	XS	ST	XS	4	E	R
-------------	----	----	---	----	----	----	---	---	---

#### DIMENSIONS INCHES / MM

D	W	H
24 / 610	24 / 610	66 / 1676
24 / 610	24 / 610	72 / 1829
24 / 610	30 / 762	66 / 1676
24 / 610	30 / 762	72 / 1829
24 / 610	36 / 914	66 / 1676
24 / 610	36 / 914	72 / 1829

#### PRICING

##### SOURCE LAMINATE CASE FINISH

##### FLINTWOOD CASE FINISH

##### DOOR AND DRAWER FRONT FINISH

Source Laminate	Foundation Laminate	Flintwood	Flintwood
1926	2099	2635	3614
2001	2190	2698	3696
2146	2361	2779	4182
2226	2466	3165	4273
2383	2621	3307	4772
2469	2740	3335	4885